



ECO 2420 BASIN

PRODUCT DESCRIPTION:

Contemporary style
White

5 days

BOX SIZE:

25" x 11" x 21.5"

NET WEIGHT:

13.5 lbs

GROSS WEIGHT:

18 lbs

* Faucet hardware and strainer not included
Electrical 120V, 15AMP, standard outlet with GFI

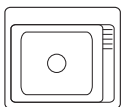
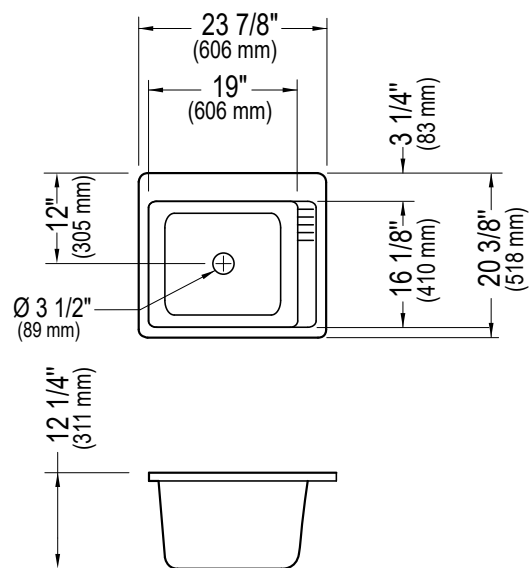

Acrylic Laundry Sink only
ECO2420

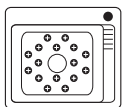

Acrylic Laundry Sink with air system
ECO2420A
Included: 16 micro-jets (Activ-Air + without check valves), Optima blower 750W (1 1/2 h.p.) with 300W heating element, ON/OFF air push button.
White, Bone or Chrome (specify your color)

*All dimensions are approximate and subject to change without notice.
Please refer to the installation guide before beginning the installation.



Certification **ECORESPONSIBLE**
First manufacturer of bathroom products in North America to be certified ecoresponsible.



Produits Neptune

6835, Picard street, Saint-Hyacinthe (Quebec) J2S 1H3
Phone: (450) 773-7058 - Fax: (450) 773-5063
produitsneptune.com