

INSTALLATION INSTRUCTIONS

1. Position shower rod with the eight (8) holes in the center of the rod facing downward.
2. Grip the rod with two hands, one hand on both sides of the rod, on either side of the plastic seam.
3. Extend the rod until the button pops out of the 1st hole.
4. Push button in and extend the rod to the next hole.
5. Repeat Step 4, extending the rod as far as necessary until the brackets are close/flush with the wall.
6. To add tension to the rod, use the plastic wheel to turn the nut counter-clockwise. The nut will adjust out for a maximum of 3/4" to add tension. *Note: Plastic wheel needs to be on the nut to turn and create tension.*
7. Push the plastic wheel off the nut and onto the thread.
8. Align and snap the covers over the brackets on both ends of the rod.

Cleaning Instructions:

To preserve the fine finish of this product, clean only with a soft damp cloth. Dry well. Do not use commercial or abrasive cleaners.

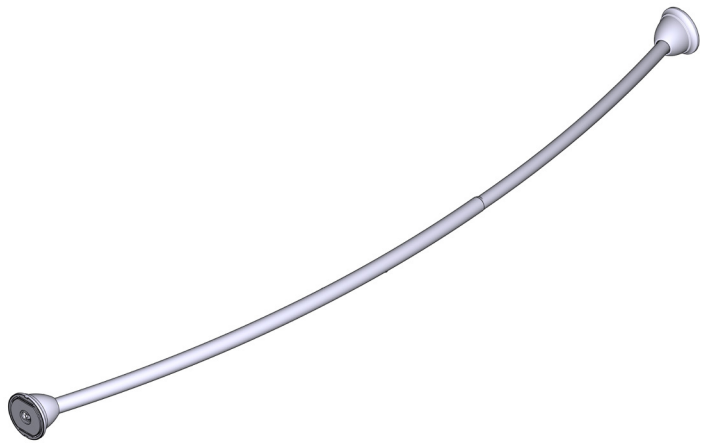

Tension Curved Shower Rod

Available Finishes: Chrome, Brushed Nickel Finishes

Tension Curved Shower Rods adjust to fit shower enclosures between 57" - 60"

STOCK NUMBER: DN2170 Series

MATERIALS

Tension Curved Shower Rods are made of 430 Stainless Steel. The decorative covers are made of 304 Stainless Steel. The thread and nut are made of aluminum. The nut tool is made of POM Plastic. The flange is made of POM Plastic and NBR Rubber.

