

- Pre-montaggio**
1. Predisporre l' impianto idraulico come indicato in FIG. 1.
 2. Spurgare bene le tubazioni di alimentazione.
 3. Fissare i 2 corpi incasso (A) tramite viti e tasselli in dotazione; verificare l' allineamento orizzontale (FIG. 1) e la posizione del muro (FIG. 1a) considerando che la linea (B) del coperchio protettivo sia allineata al muro finito.
 4. Predisporre l' allacciamento per la bocca di erogazione seguendo le indicazioni rispetto al muro finito come da FIG. 2 (-13/+2mm).

- MONTAGGIO**
- FIG. 2**
- Avvitare a tenuta la spina (C) servendosi dell' apposita sede (C1).
Calzare la carna (F) sulla spina (C) interponendo la basetta (D) e stringere il grano (E) con la chiave in dotazione.
- FIG. 1a**
- Togliere (svitare) la protezione (G).
FIG. 2a
- Infilare la basetta (H) e spingerla in battuta al muro.

- PRE-ASSEMBLY**
1. Prepare plumbing connections as per FIG. 1.
 2. Flush through supply pipes.
 3. Fix cartridge bodies (A) with screws and wedges (enclosed) checking that they are horizontal (FIG.1) and that line (B) of the protection cap will match the finished wall (FIG. 1a).
 4. Prepare plumbing connection for the spout checking that the allowed position range (-13/+2mm) towards the finished wall is matched (FIG. 2).

- ASSEMBLY**
- FIG. 2**
- Tighten pin (C) by using (C1).
Insert spout (F) onto pin (C) after inserting ring (D). Tighten grub (E) with enclosed key.
- FIG. 1a**
- Remove (unscrew) protection cap (G).
FIG. 2a
- Insert ring (H) on the body and fully push against the wall.

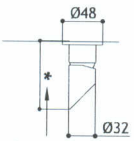
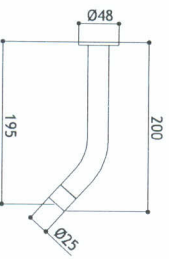
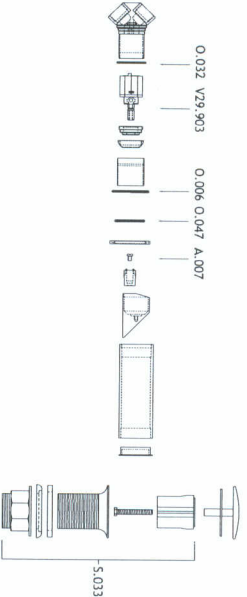
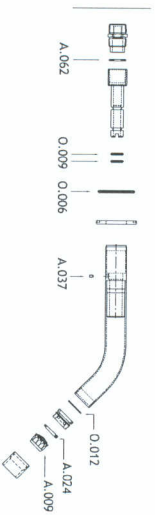

* (vedi FIG 1a)
* (see FIG 1a)

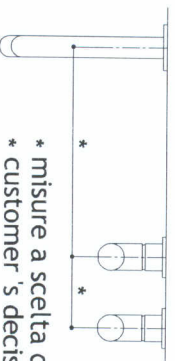

* misure a scelta del cliente
* customer's decision

MGS si preclude qualsiasi responsabilità da difetti o danni causati da un collegamento o uso improprio.

MGS übernimmt keine Verantwortung für Schäden die durch eine schlechte Installation des Heizkessels verursacht werden.

MGS is not responsible for defect or damage caused by a wrong installation or use.

MGS n'est pas responsable pour d'éventuels dégâts causés par une mauvaise installation.

MGS
Progetti

DISEGNI INTEGRATIVI 021545...

COMPLEMENTARY DRAWINGS 021545...