

225FJR DI Flanged x MJ Valve Open Right Specification Sheet

FEATURES & BENEFITS

- Ductile Iron Gate Valve
- Flanged x MJ
- Open Right
- Resilient Wedge
- Non Rising Stem
- AWWA C515-15
- 300 PSI
- UL Listed / FM Approved
- AWWA C550 Epoxy
- NSF-61 / NSF-372 verified by UL Water Quality
- Flanges Conform to ANSI B16.1
- Mechanical Joint Outlet Complies with ANSI C153
- Can Be Fitted With Post Indicator Plate
- Sizes 4" – 12"

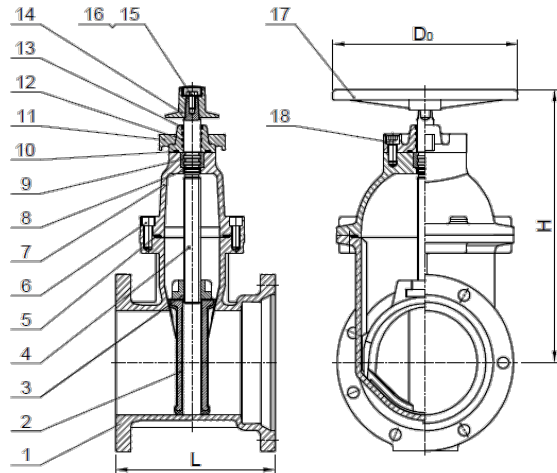
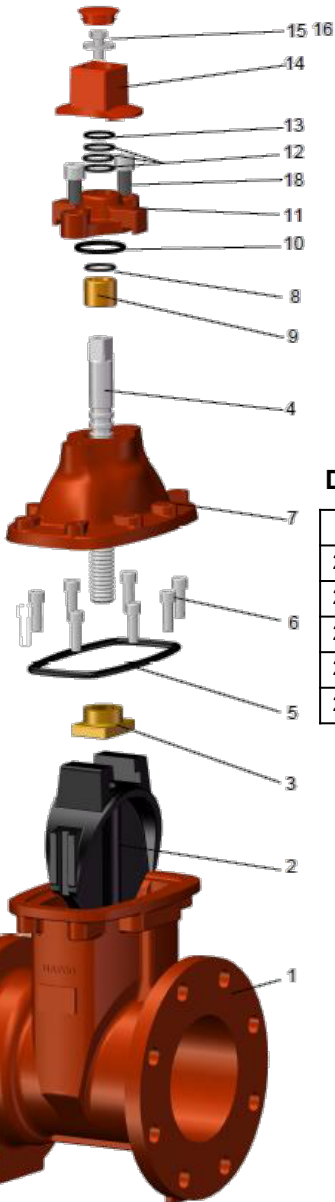

DIMENSIONS

Part #	Size	L	H	Do
225FJ11R	4"	9.5	11.8	10.0
225FJ13R	6"	11.0	16.4	12.0
225FJ14R	8"	12.0	20.7	14.0
225FJ15R	10"	13.9	24.5	16.0
225FJ16R	12"	14.5	28	16.0

MATERIAL SPECIFICATIONS

No.	Part	Material	ASTM Spec.
1	Body	Ductile Iron	A536 65-45-12
2	Disc	Ductile Iron EPDM Encapsulated	A536 65-45-12
3	Stem Nut	Bronze	B148 C95200
4	Stem	Stainless Steel	A276 Type 304SS
5	Gasket	Rubber	D2000 EPDM
6	Bolt	Stainless Steel	F93 Type304SS
7	Bonnet	Ductile Iron	A536 65-45-12
8	O-Ring	Rubber	D2000 EPDM
9	Thrust Collar	Bronze	B148 C95200
10	O-Ring	Rubber	D2000 EPDM
11	Gland	Ductile Iron	A536 65-45-12
12	O-Ring	Rubber	D2000 EPDM
13	Dust Ring	Rubber	D2000 EPDM
14	Operating Nut	Ductile Iron	A536 65-45-12
15	Bolts	Stainless Steel	F93 Type304SS
16	Washer	Stainless Steel	A276 Type 304SS
17	Handwheel	Ductile Iron	A536 65-45-12
18	Bolt	Stainless Steel	F93 Type304SS

