



# MAIDSTONE

www.MaidstoneSupply.com

## Cast Iron Double Slipper Clawfoot Tub

Part No: 2201MH

### TECHNICAL INFORMATION

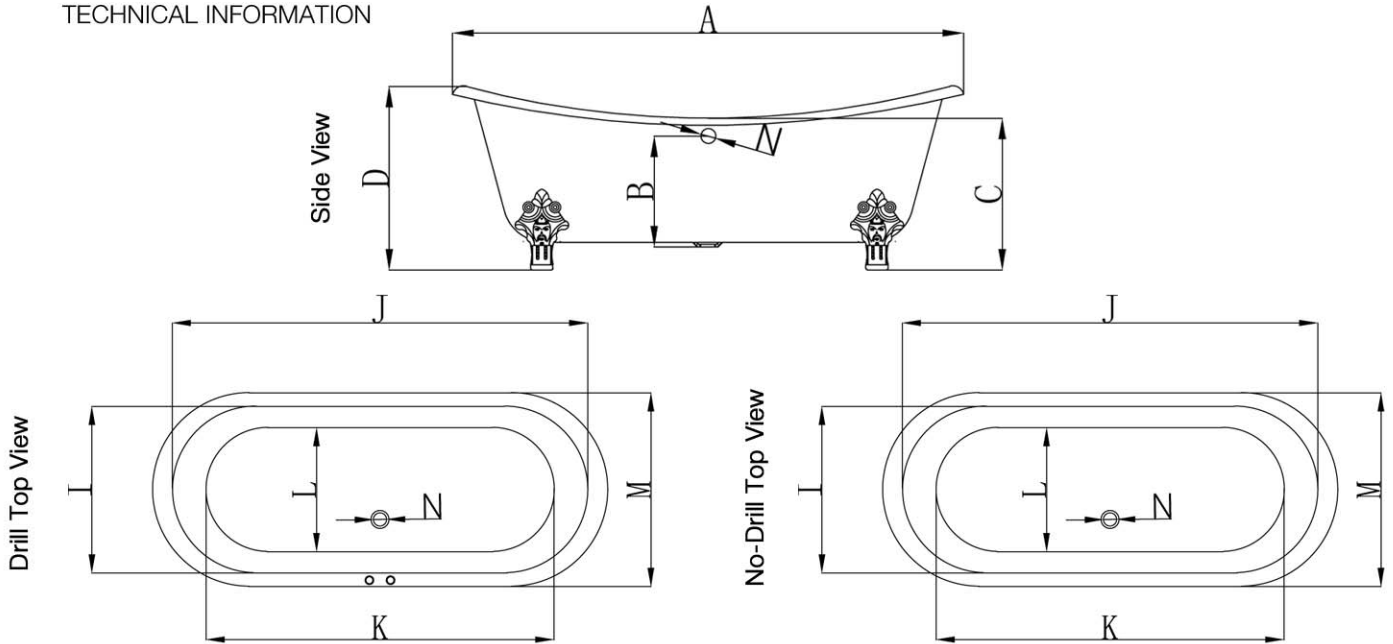

### DIMENSIONS (INCHES)

	A	B	C	D	E	F	G	H	I	J	K	L	M	N
59	59	15	23 <sup>1</sup> / <sub>5</sub>	26	-	-	-	-	18	52 <sup>4</sup> / <sub>5</sub>	43 <sup>1</sup> / <sub>3</sub>	18	29 <sup>1</sup> / <sub>2</sub>	2
72	72	15	23 <sup>1</sup> / <sub>5</sub>	28 <sup>1</sup> / <sub>5</sub>	-	-	-	-	26 <sup>4</sup> / <sub>5</sub>	65 <sup>4</sup> / <sub>5</sub>	50 <sup>2</sup> / <sub>5</sub>	19	30 <sup>3</sup> / <sub>5</sub>	2
														2

	59	72
EMPTY (LB)	286	418
FILLED (LB)	660	990
CAPACITY (GAL)	45	69
WATER DEPTH (IN)	15	15

Approximate Measurements

Contact Maidstone for additional information and specifications. For complete warranty information and a list of dealers visit [www.MaidstoneSupply.com](http://www.MaidstoneSupply.com). All products and specifications are subject to change without notice. Maidstone is not responsible for typographical and/or dimensional errors. Typographical errors are subject to correction.

Note: Rough-in dimensions may vary +/- 1/2" and are subject to change. No responsibility is assumed by Maidstone.