

## **Bathroom Metal Console Leg Sink Instructions**

### **Tools:**

- Pencil
- Level
- Tape Measure
- Screwdriver
- Drill
- Silicone Sealant

**Important:** The sink should be anchored to solid wood blocking installed behind the Finished wall. If this is a new installation and there is no support, remove any drywall and mortise 2"x 6" boards for suitable reinforcement behind the Finished wall at height required to attach sink to wood support. Refinished the drywall and paint as desired.

### **Instructions**

1. Assembly the console stand as shown:

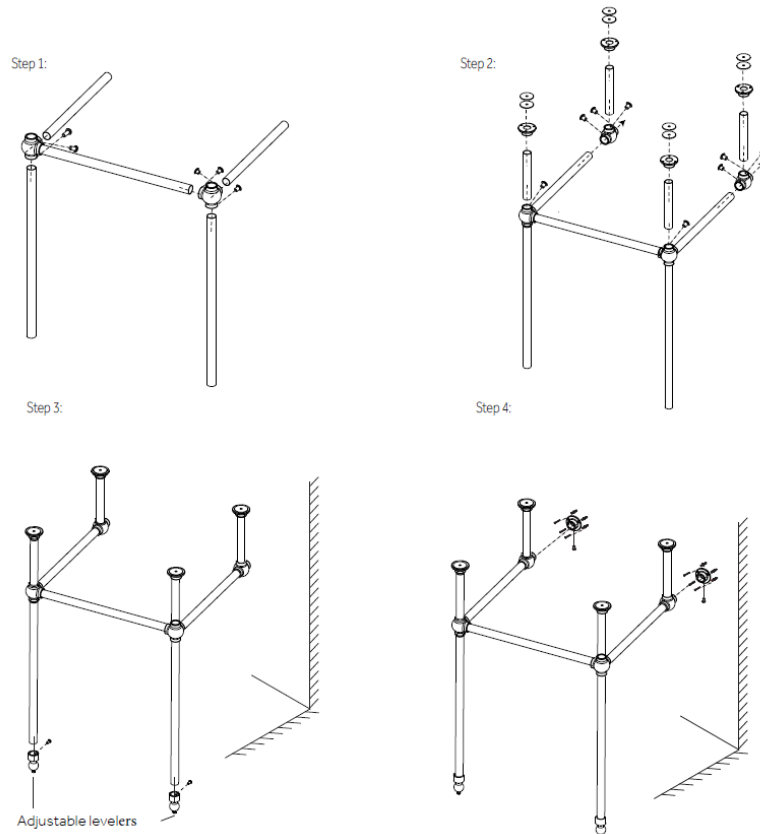

2. Once assembled, place the sink stand against the wall and in line with wall studs or wood blocking. Make sure the stand is level. If needed, adjust the small screws under each leg to level.
3. Mount the flanges of the console stand to the wall with the included screws. Each flange has three screws.
4. Apply a thin coat of silicone to the tops of the sink stand where the vanity top will rest.
5. Carefully place the sink top on the console stand. Ensure the sink is level & centered and secure sink top to the wall using provided anchors.
6. Proceed to installing your faucet, drain, and plumbing fixtures to complete the installation.