

L U X A R T.

andressa®

Fine Fire Clay Vanity Top
LXVTFC2522S

FC-2522-8W

25" x 22" Stone Vanity Top

- White top with integrated rectangular bowl
- 5-1/4" basin depth with front overflow
- 22" depth, 5/8" thickness
- Pre-drilled for an 8" center faucet



****STONE CHARACTERISTICS:** Natural stone exhibits variations in color, grain, and veining that are all part of their natural beauty. We apply a light sealer to our stone tops but natural stone is not impermeable. Clean all spills immediately. For more information see our care and cleaning instructions.

LUXART.

andressa®

Fine Fire Clay Vanity Top LXVTFC2522S

FC-2522-8W

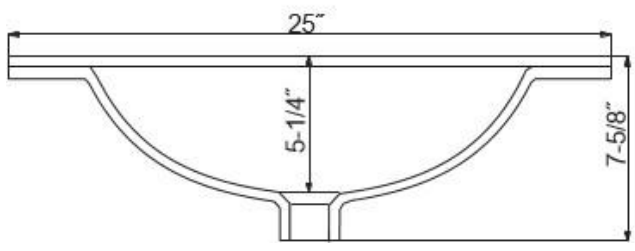
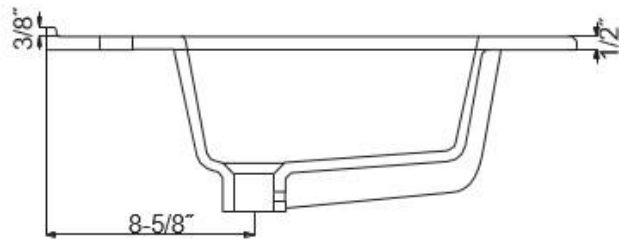
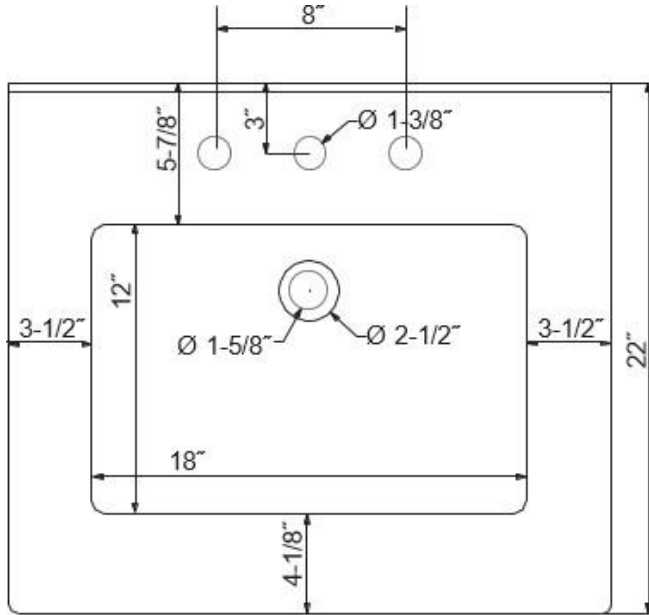

Need Help? If you have any questions or concerns, please email: customerservice@luxartcollection.com.
Por favor. Si tiene alguna pregunta o duda, envíe un correo electrónico: customerservice@luxartcollection.com