

LUXART.

andressa®

Stone Vanity Top

LXVTQZ4922S

QZ49228GG/QZ49228GS/QZ49228IW/QZ49228SW

49" x 22" Stone Vanity Top

- Pre-attached large rectangular white vitreous china trough bowl included
- Available in Galaxy Grey, Galaxy Sand, Iced White and Snow White (Quartz)
- 5-1/2" basin depth with front overflow
- Optional 4" back splash & side splash included
- 22" depth, 3/4" thickness
- Pre-Drilled for an 8" center faucet
- Standard eased edge profile



Galaxy Grey Quartz Pictured Above

****STONE CHARACTERISTICS:** Natural stone exhibits variations in color, grain, and veining that are all part of their natural beauty. We apply a light sealer to our stone tops but natural stone is not impermeable. Clean all spills immediately. For more information see our care and cleaning instructions.

LUXART.

andressa®

Stone Vanity Top

LXVTQZ4922S

QZ49228GG/QZ49228GS/QZ49228IW/QZ49228SW

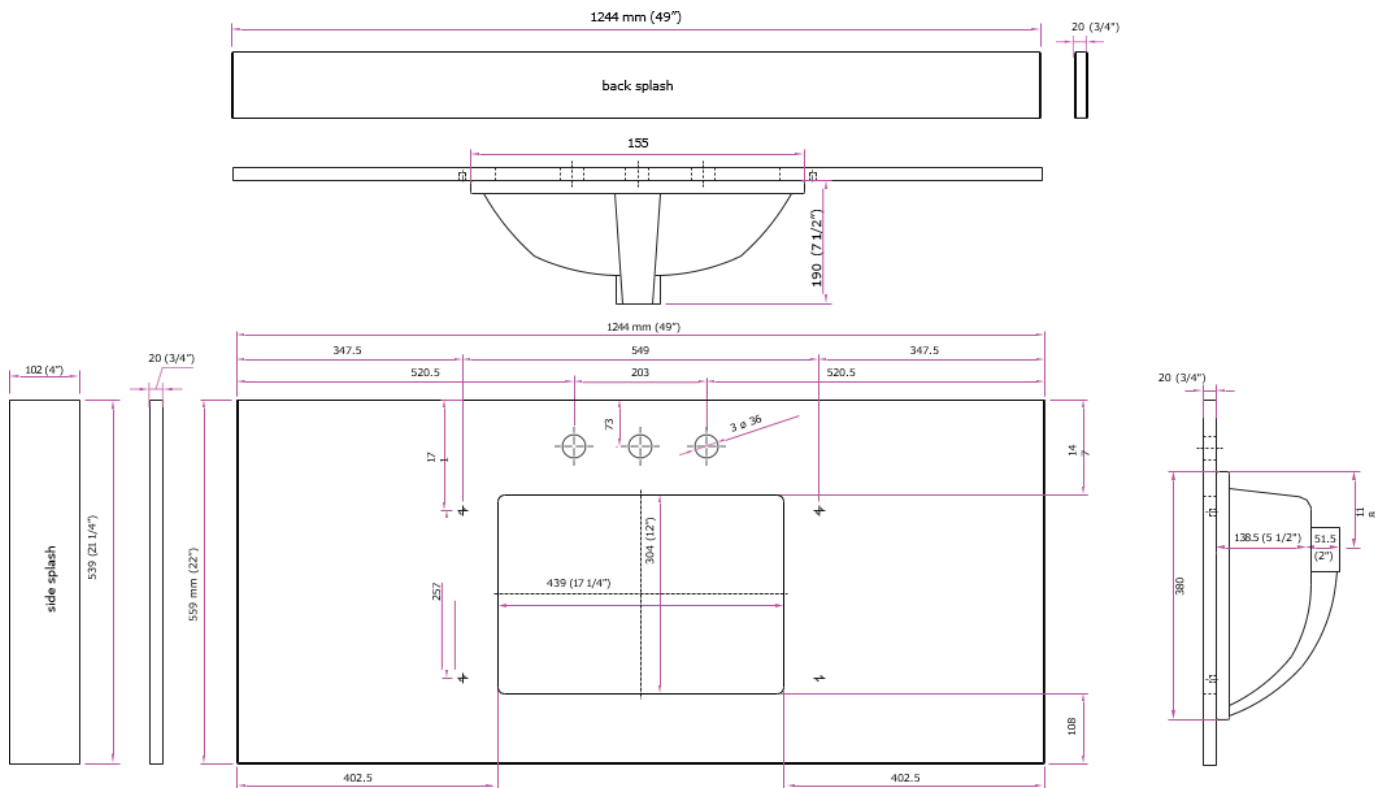

Need Help? If you have any questions or concerns, please email: customerservice@luxartcollection.com.
Por favor. Si tiene alguna pregunta o duda, envíe un correo electrónico: customerservice@luxartcollection.com