



## Grab bars for whirlpool baths with Spa/Massage package **K-9653**

### Features

- Set of two grab bars
- For use with K-1418 and K-856 whirlpools with Spa/Massage package
- Includes installation hardware

### Material

- Premium metal construction for durability and reliability
- KOHLER finishes resist corrosion and tarnishing



### Codes/Standards



ASTM F446

### KOHLER® One-Year Limited Warranty

See website for detailed warranty information.

### Available Colors/Finishes

*Color tiles intended for reference only.*

Color	Code	Description
	CP	Polished Chrome
	SN	Vibrant® Polished Nickel
	BN	Vibrant® Brushed Nickel
	BV	Vibrant® Brushed Bronze

1-800-4KOHLER (1-800-456-4537)

Kohler Co. reserves the right to make revisions without notice to product specifications.

For the most current Specification Sheet, go to [www.kohler.com](http://www.kohler.com) USA or [www.kohler.ca](http://www.kohler.ca) Canada

9-20-2025 16:00 - US/CA

THE BOLD LOOK  
OF **KOHLER®**



Grab bars for whirlpool baths with Spa/Massage  
package  
**K-9653**

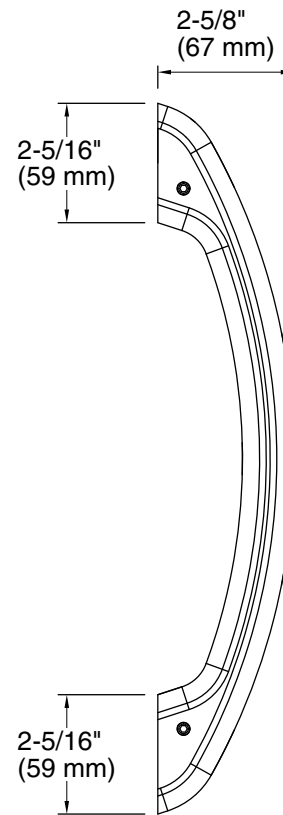
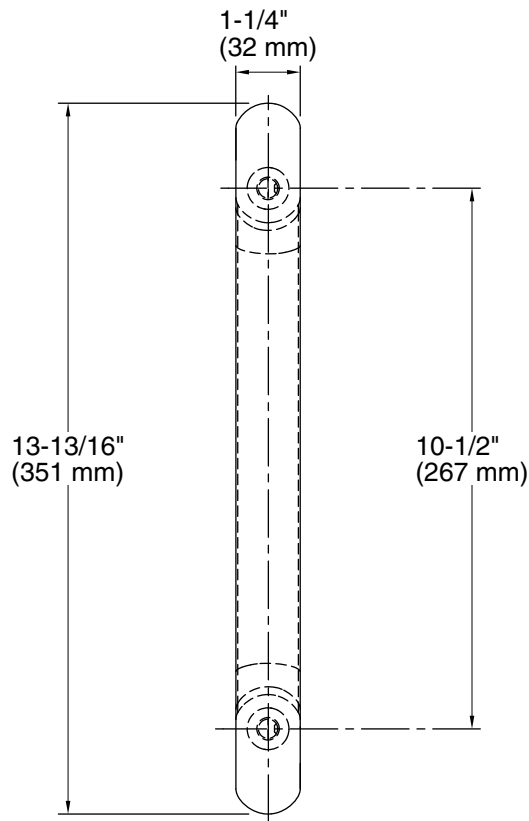

**Technical Information**

All product dimensions are nominal.

Material: Metal

**Notes**

Install this product according to the installation instructions.