



# Volute™

63" x 28-3/8" freestanding bath with base  
**K-29326-P5**

## Features

- Freestanding design creates a striking focal point in your bathing area
- Oval basin creates a spacious bathing experience
- Integral lumbar support on both ends
- Slotted overflow allows for deep soaking
- 12-1/16" (306 mm) deep-soaking depth provides a luxurious bathing experience
- Safeguard® slip-resistant surface provides excellent traction underfoot
- Center drain
- Drain and integral overflow preinstalled to reduce installation time
- Color-matched pedestal base creates a sleek appearance
- Requires K-36361 Volute bath drain trim (sold separately)

## Material

- KOHLER® enameled cast iron bath
- Painted exterior in Iron Black
- Reinforced resin pedestal base with Iron Black painted finish
- Brass drain

## Installation

- Freestanding

## Required Products/Accessories

For freestanding installation  
K-36361 Bath drain trim



## Codes/Standards

ASME A112.19.1/CSA B45.2

## KOHLER® Enameled Cast Iron Bath and Shower Base Lifetime Limited Warranty

See website for detailed warranty information.

## Available Colors/Finishes

*Color tiles intended for reference only.*

Color	Code	Description
-------	------	-------------

	0	White
---	---	-------



**Volute™**  
63" x 28-3/8" freestanding bath with base  
**K-29326-P5**

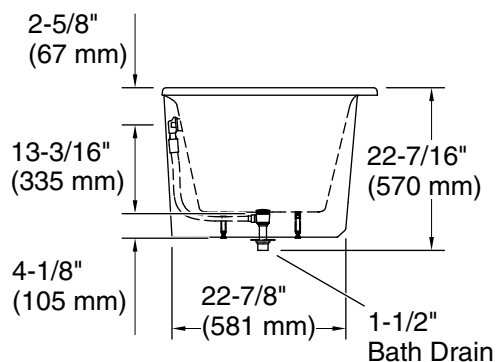
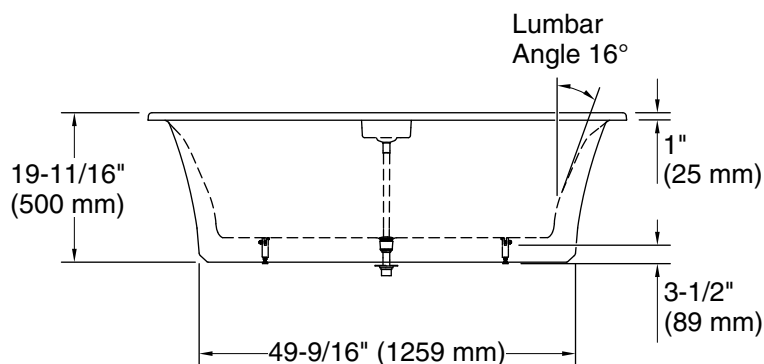
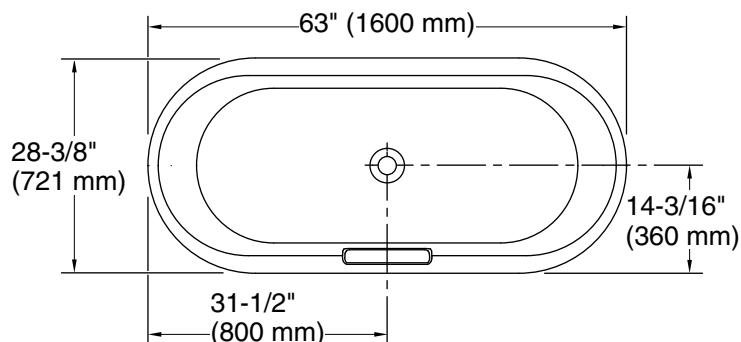

### Technical Information

All product dimensions are nominal.

Drain location:	Center
Basin area, bottom:	50-1/4" x 20-3/8" (1277 mm x 518 mm)
Basin area, top:	60-1/4" x 23-11/16" (1531 mm x 602 mm)
Weight:	305 lbs (138.3 kg)
Minimum floor load:	55.2 lbs/ft <sup>2</sup> (269.5 kg/m <sup>2</sup> )
Water depth:	12-1/8" (308 mm)
Water capacity:	42.45 gal (160.7 L)

### Notes

Measure your actual product for rough-in details.

Install this product according to the installation instructions.

The hot water supply should be 70% of the capacity of the bath or greater. Installations will vary.

Install this product according to the installation instructions.