

INSTALLATION INSTRUCTIONS

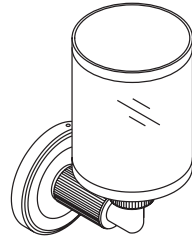



P34020W, P34021W

INSTALLATION INSTRUCTIONS

THANK YOU FOR CHOOSING KALLISTA

We appreciate your commitment to KALLISTA quality products. Please take a moment to review this manual before you install your KALLISTA product. If you encounter any installation or performance problems, please do not hesitate to contact us at the phone number listed at the bottom of the page or visit us on line at kallista.com.

BEFORE YOU BEGIN

-  **WARNING: Risk of personal injury.** To avoid possible electrical shock, the electricity must be turned off at the circuit breaker or fuse box before attempting any installation procedure.
-  **WARNING: Risk of personal injury.** To avoid possible electrical shock, the outlet box must be properly grounded.
-  **WARNING: Risk of property damage.** To avoid possible risk of fire, do not exceed the following rating for this fixture: input 120/240 VAC 50/60 Hz, maximum 25 W type B10 candelabra base bulb.
- Observe all local electrical and building codes.
- Carefully read these instructions before installing the fixture.
- It is strongly recommended that a professional electrician install this fixture.
- This fixture is for indoor use only.
- Carefully inspect the fixture for damage.
- KALLISTA reserves the right to make revisions in the design of products without notice, as specified in the Price Book.

TOOLS AND MATERIALS

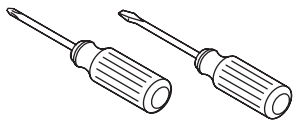

Assorted
Screwdrivers

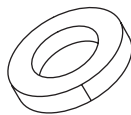

Electical
Tape



Hex
Wrench



Plastic Wire
Connectors

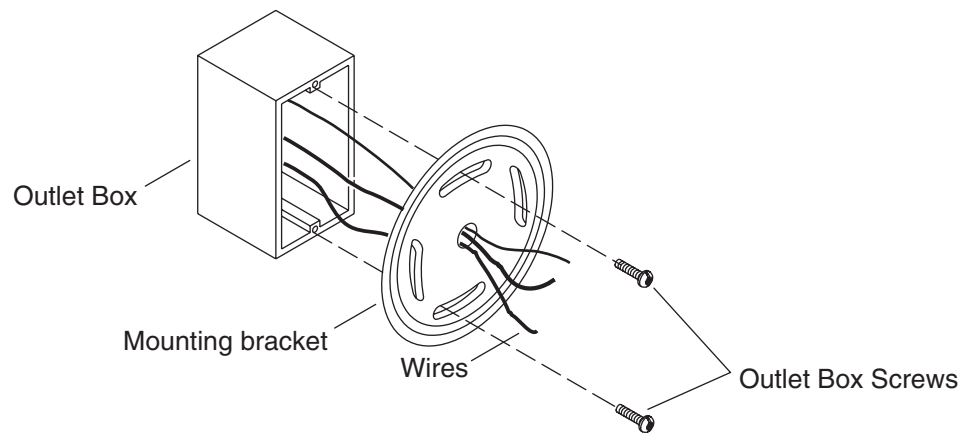

25 W Type B10
Candelabra Base
Bulb

INSTALLATION INSTRUCTIONS**1. INSTALL THE MOUNTING BRACKET**

⚠ WARNING: Risk of personal injury. To avoid possible electrical shock, the electricity must be turned off at the circuit breaker or fuse box before attempting any installation procedure.

- Shut off the main electrical supply from the main fuse box/circuit breaker.
- Gently pull the wiring from the outlet box in your wall and allow the wires to hang freely.
- Place the flat side of the mounting bracket flush against the outlet box.
- Gently feed the wiring from the outlet box through the mounting bracket.
- Use the outlet box screws to secure the mounting bracket to the outlet box.

INSTALLATION INSTRUCTIONS

2. CONNECT THE ELECTRICAL WIRES

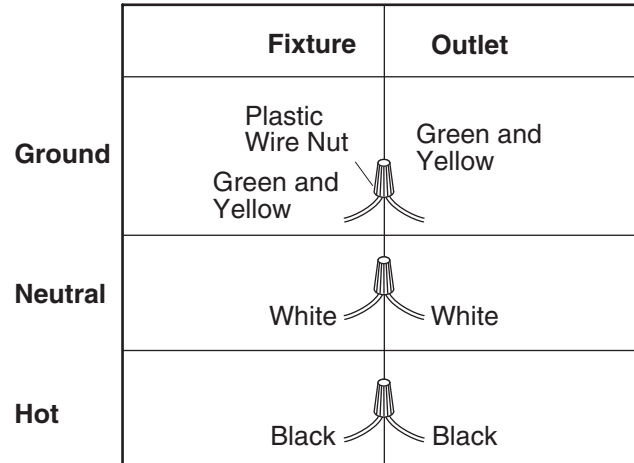

WARNING: Risk of personal injury. To avoid possible electrical shock, the outlet box must be properly grounded.

- Attach the green and yellow ground wire from the fixture to the ground wire (green and yellow) of the outlet box.
- Fasten the ground wires together with a plastic wire nut and wrap with electrical tape.
- Attach the neutral wire (white) from the fixture to the neutral wire of the outlet box.
- Fasten the neutral wires together with a plastic wire nut and wrap with electrical tape.
- Attach the hot wire (black) from the fixture to the hot wire of the outlet box.
- Fasten the hot wires together with a plastic wire nut and wrap with electrical tape.
- Verify all plastic wire nuts are securely fastened and wire strands are not exposed.
- Carefully tuck the wire connections neatly into the outlet box.

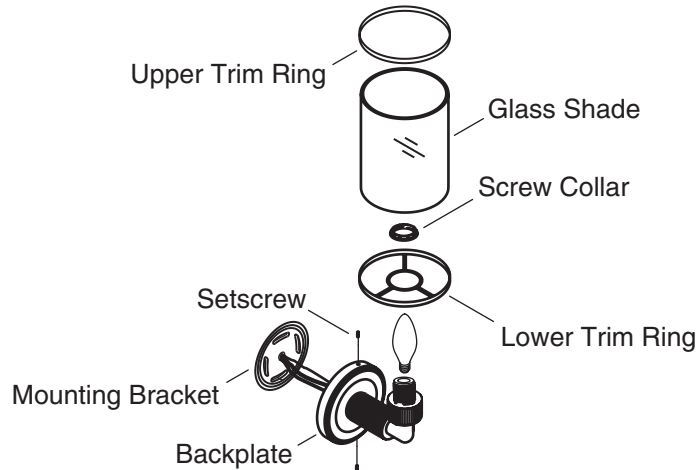
INSTALLATION INSTRUCTIONS**3. INSTALL THE SCONCE**

- Position the back plate of the fixture over the mounting bracket making sure that all wire connections are positioned neatly behind the backplate.
- Using the supplied hex wrench, secure the backplate to the mounting bracket by tightening the two setscrews.
- Once the fixture is properly secured to the wall, position the lower trim ring on the fixture and secure by tightening the screw collar.
- Insert a B10 candelabra base bulb (25 W maximum) into the fixture.
- Lower the glass shade and upper trim ring in place.
- Turn on the main electrical supply from the main fuse or circuit breaker.
- Check for proper operation.