

# KALLISTA®

## Installation Guide

**Record your model number.**

**1** Remove the pump from the shank.

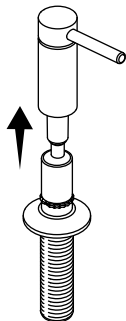

**2** Install the escutcheon, O-ring, and the nut.

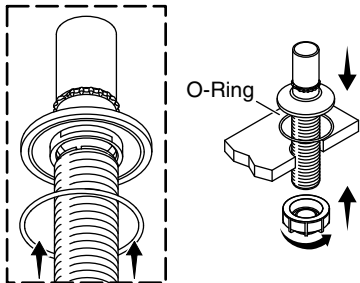

**3** Thread the bottle onto the shank.

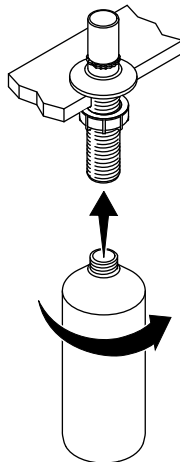

**4** Fill the soap bottle 1-1/2" (38 mm) from the top.

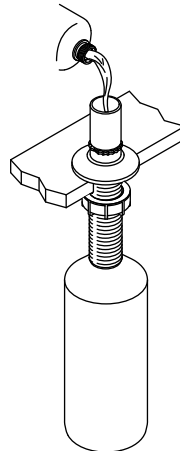

**5** Install the flat end of the tube to the soap pump.

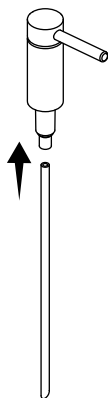

**6** Install the soap pump.

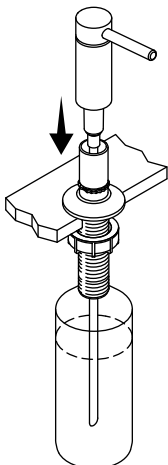

**Need help?** Contact the KOHLER Customer Care Center at 1-800-4KOHLER (1-800-456-4537).

**For service parts information**, visit [kohler.com/serviceparts](http://kohler.com/serviceparts).

**For care and cleaning** and other information, visit [us.kohler.com](http://us.kohler.com).

Questions? Problems? For additional assistance, please contact KALLISTA's Customer Service Department at 1-888-4-KALLISTA (1-888-452-5547) or [kallista.com](http://kallista.com).