

INSTALLATION INSTRUCTIONS

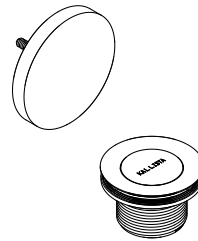

P21584



P21585

INSTALLATION INSTRUCTIONS

THANK YOU FOR CHOOSING KALLISTA

We appreciate your commitment to Kallista quality products. Please take a moment to review this manual before you install your Kallista product. If you encounter any installation or performance problems, please do not hesitate to contact us at the phone number listed at the bottom of the page.

TOOLS



Plumbers
Putty



Adjustable
Wrench

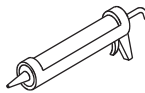

Caulk
Gun

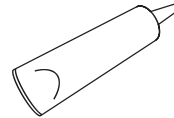

Silicone
Sealant

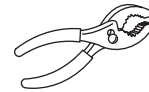

Pliers With Rubber Grips

BEFORE YOU BEGIN

- Observe all local plumbing and building codes.
- Turn off the main water supplies.
- Refer to the roughing-in dimensions of your bath to properly install this product.
- Carefully inspect the fittings for damage before installing.
- Install the drain before installing the bath.
- Kallista reserves the right to make revisions in the design of products without notice, as specified in the Price Book.

INSTALLATION INSTRUCTIONS

INSTALL THE DRAIN TRIM

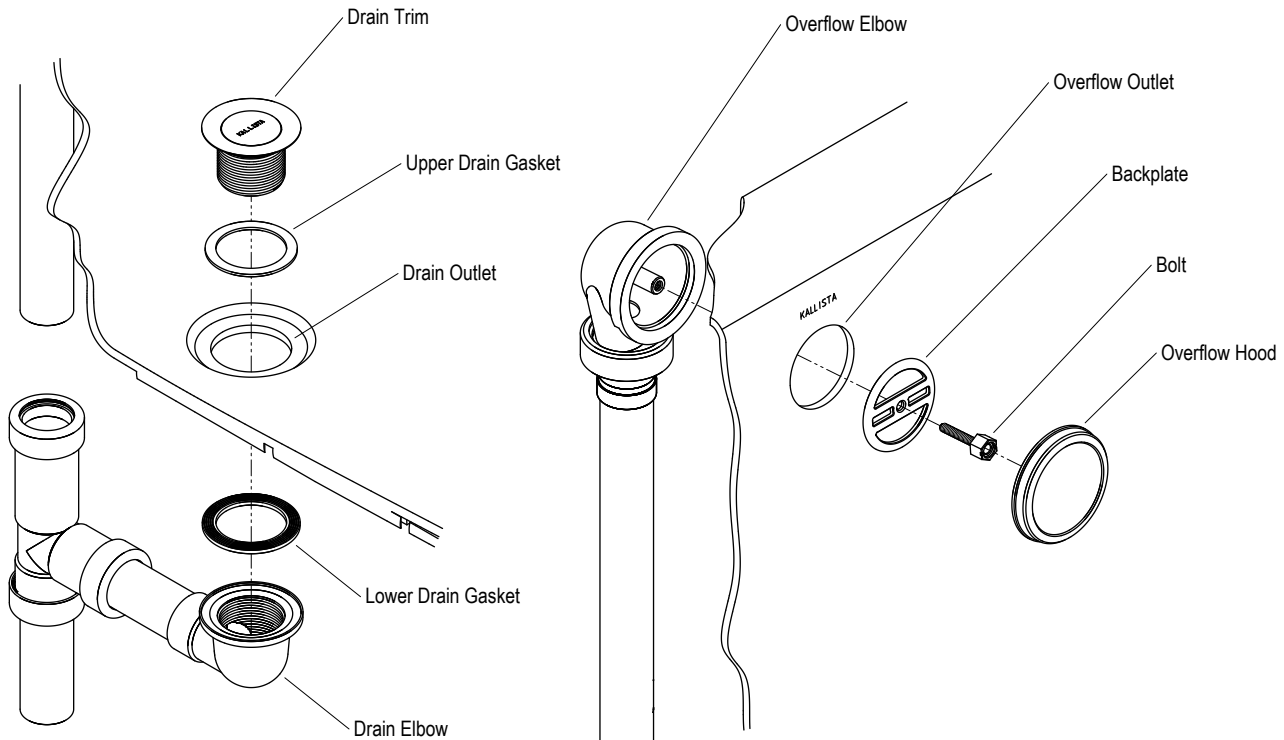

⚠ CAUTION: Risk of property damage. Make sure a watertight seal exists on all bath drain connections.

- Assemble the drain and fit it to the tub according to the drain manufacturer's instructions.
- Apply silicone sealant to the underside of the lower drain gasket, then place the drain gasket on top of the drain elbow.
- Set the upper drain gasket on top of the drain outlet.
- Apply plumbers putty to the underside of the drain trim flange.
- Insert the drain trim through the drain outlet and thread into the drain elbow.
- Hand tighten the drain trim into the drain elbow. Do not wrench tighten at this time.
- Apply plumbers putty or other sealant to the front edge of the overflow elbow according to the putty manufacturer's instructions.
- Align the overflow elbow to the outside of the overflow outlet.
- Insert the bolt through the backplate.
- Insert the bolt with backplate onto the threaded cylinder of the overflow elbow.
- Turn the bolt clockwise until hand-tight to secure the bolt with the backplate to the threaded cylinder. Do not wrench tighten at this time.
- Verify the drain's fit to the tub. Adjust as necessary.

INSTALLATION INSTRUCTIONS

INSTALL THE DRAIN TRIM (CONT'D)

Secure the Drain Trim

- Open the flip drain and insert the grips of a rubber coated pliers into the drain trim and turn to tighten. Be careful not to scratch the finish.

Install the Overflow Hood

- Secure the backplate to the tub by tightening the bolt to one quarter turn past hand-tight.
- Thread the overflow hood into the bolt.

COMPLETE THE INSTALLATION

Complete the Bath Installation

- Check all drain connections for leaks and repair as needed.
- Install the bath faucet according to the bath faucet manufacturer's installation guide.
- Refer to the bath manufacturer's installation guide to complete the finished deck or wall around the bath.