

KALLISTA® Counterpoint™ Showerhead with Arm

INSTALLATION INSTRUCTIONS

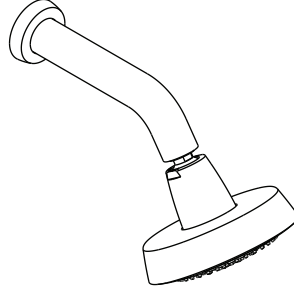

P23271, P23371

INSTALLATION INSTRUCTIONS

THANK YOU FOR CHOOSING KALLISTA

We appreciate your commitment to Kallista quality products. Please take a moment to review this manual before you install your Kallista product. If you encounter any installation or performance problems, please do not hesitate to contact us at the phone number listed at the bottom of the page.

BEFORE YOU BEGIN

- Observe all local plumbing and building codes.
- Shut off the main water supply.
- Kallista reserves the right to make revisions in the design of products without notice, as specified in the Price Book.

TOOLS AND MATERIALS

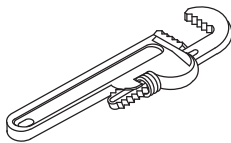

Pipe Wrench



Thread Sealant



Plumbers Putty

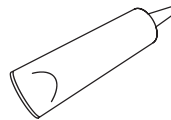

Silicone Sealant



Adjustable Wrench



Strap Wrench

Plus

- 1/2" Pipe Nipple

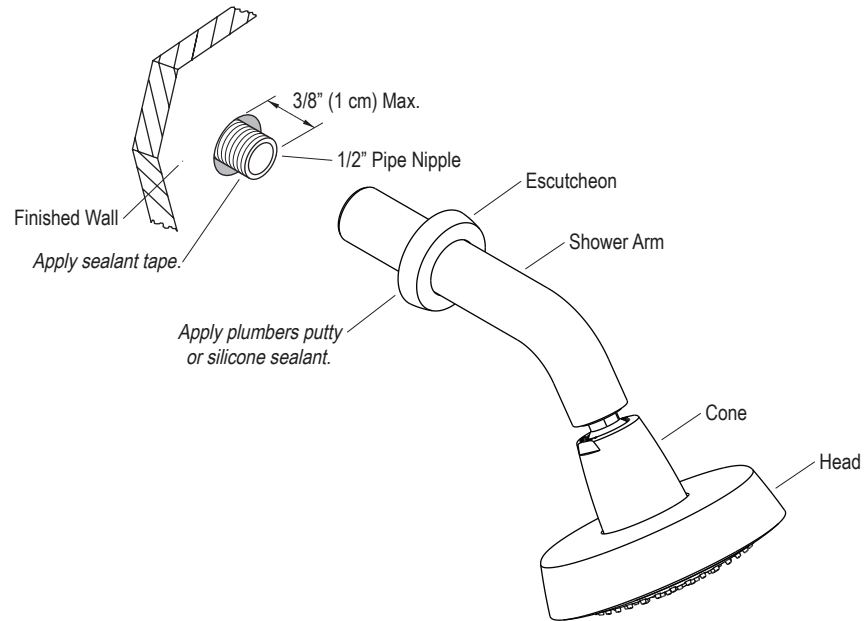
INSTALLATION INSTRUCTIONS**INSTALLATION**

- Apply sealant tape around both ends of a 1/2" pipe nipple.
- Install the pipe nipple into the pipe with the pipe nipple extended 3/8" (1 cm) beyond the finished wall.
- Run water through the system to flush out dirt and debris.
- Slide the escutcheon onto the shower arm.
- Thread the showerhead onto the 1/2" pipe nipple until it is tight and the shower arm is oriented correctly.
- Run water through the showerhead and check for leaks at the nipple. If leakage occurs, remove the showerhead and apply more sealant tape to the pipe nipple. Re-install showerhead and check for leaks. Repeat until no leakage occurs.
- Apply plumbers putty or silicone sealant to the back of the escutcheon.
- Slide the escutcheon so that it touches the wall.
- Wipe away excess plumbers putty or silicone sealant with a damp rag.
- If desired, apply a thin bead of clear silicone sealant around the escutcheon.

NOTE: To adjust the resistance in the ball joint, grasp the cone tightly with one hand, and tighten the head with the other hand. A wrench may also be used to hold the cone in place while tightening (wrap the jaws with tape or use a rag to protect the finish).