

Celestia

Indirect LED-illuminated rectangular mirror with clear glass strip and touch-switch for color temperature control



FEATURES	
Code	MR1788-570-001
Packaging mm (in)	1085 x 870 x 90 (42.7 x 34.3 x 3.5)
Mirror thickness	4 mm
Weight kg (lb)	14 (30.9)
Certification	cUL _{us}
Anti-fog system	Included
Magnifying mirror (3X)	Not available
Reversible	Yes
Total thickness	45 mm (1 3/4")
Automatically opens with wall switch	Yes

LIGHTING	
Power (watt)	80 W
Input (volt)	120 V
Lumens	1815 lm
Color temperature controlled by maintaining the touch-switch	from 2700k to 6000k
Frequency	60 Hz
Color Rendering Index (CRI)	90+

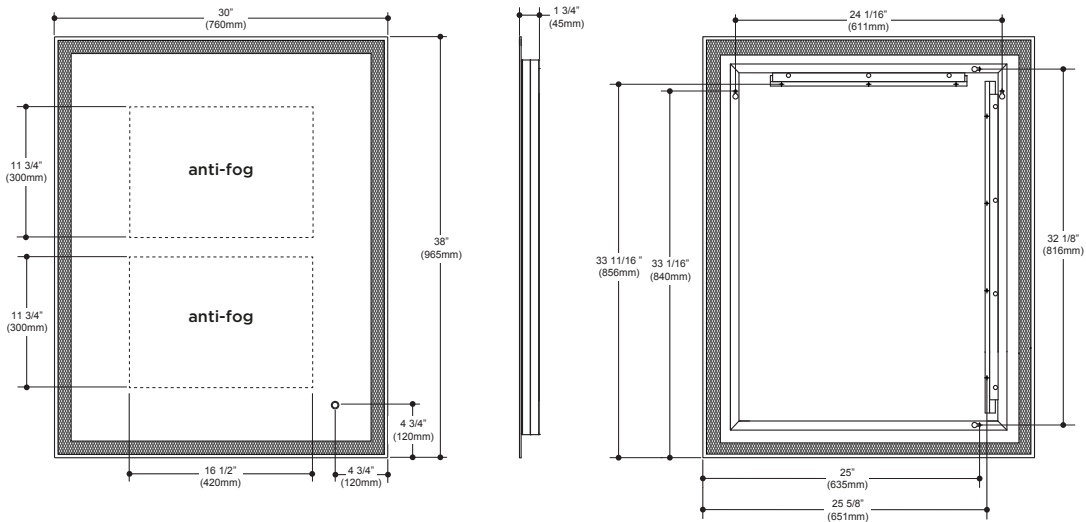

- Touch Switch
- Clear glass strip
- Anti-fog