

005406 | SMARTSTATION

UNDERMOUNT STAINLESS STEEL KITCHEN SINK

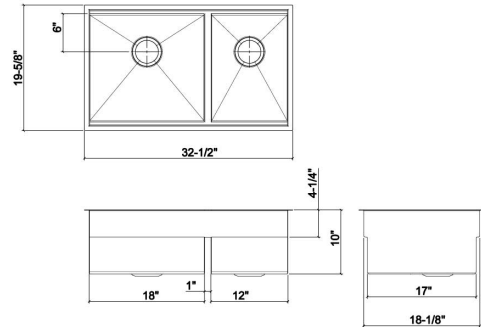
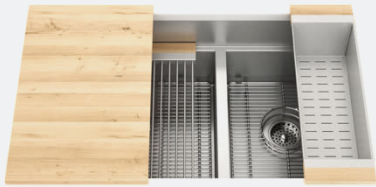

Specifications

Model	005406
Collection	SmartStation
Bowls dimensions	L 18" × 18 1/8" × 10" R 12" × 18 1/8" × 10"
Overall dimensions	32 1/2" × 19 5/8" × 10"
Recommended cabinet	36"

Recommended accessories

Drain	100082
Grid (included)	
Grid (included)	
Colander	205318
Tray	205321
Tray	205322
Colander (included)	205325
Cutting board (included)	210068
Drying Rack (included)	215307

Warranty

Home Refinements offers a LIMITED LIFETIME WARRANTY on the fixed components of its stainless steel sinks against defects of material and workmanship as well as a 1-YEAR LIMITED WARRANTY following the purchase date for all accessories against defects of material and workmanship. This warranty is limited to defects or damages resulting from a normal residential use. For further details on our product warranty, please refer to our catalog or Web site.

Features

- Handcrafted in Canada
- Commercial quality stainless steel - 16 ga thickness
- Corrosion resistant material - 304 series (18/10)
- Unique design allowing the Home Refinements standard accessories to slide one over the other on two levels
- Accessory ledge on front and back of the bowl to accommodate any standard 17" Home Refinements accessory
- Standard 18" Home Refinements accessories to be used directly on the countertop (undermount with overhang countertop installation necessary)
- Three (3) accessories included, with a choice of maple or walnut handles: 17" drying rack to be used on accessory ledge and 18" colander and cutting board to be used on countertop
- Bottom grid included to protect the surface of the sink
- Attractive combination of UrbanEdge® and J7® collections : vertical square corners [0°] and slightly rounded corners [7mm] for bottom front and back folds
- Environmentally friendly product, 100% recyclable
- Elegant no. 4 brushed finish that matches the appliances
- Highly efficient sound deadening pads
- Practical flat sink bottom and straight bowl sides that maximize available space in the bowl
- Stylish and functional bowl bottom grooves that facilitate water drainage
- Rear or side 3-1/2" drain placement
- Mounting hardware included
- Certifications: ASME A112.19.3, CSA B45.0, CSA B45.4