

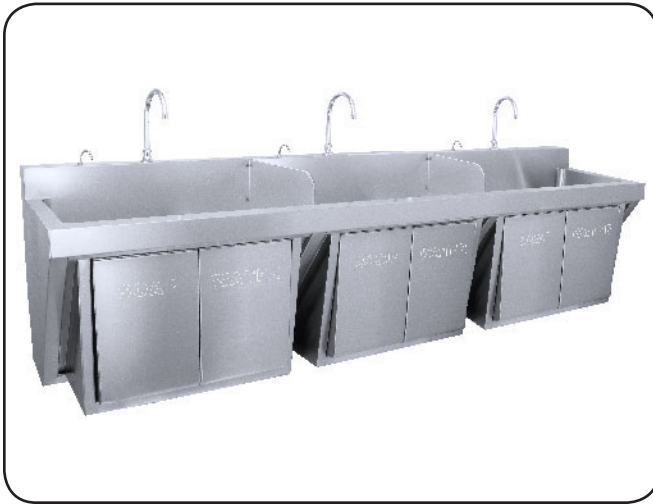

JKS-770-3

SURGEON'S SCRUB SINK
KNEE ACTIVATED - PRE-PIPED
SOAP AND WATER CONTROLS

SUBMITTAL DATA



SPECIFICATION

Seamless welded construction of 16 gauge type 304 stainless steel. Interior surfaces polished to a Hand-Blended Just Finish. Exposed exterior surfaces to have a standard brush finish. Underside of compartment to be sound deadened. Water activation with push-on/push-off hinged knee panel. Liquid soap/surgical detergent dispenses pre-measured with push of hinged knee panel. Chrome plated spout with laminar flow control. JTM-47LF thermostatic mixing valve. Removeable acrylic partions. Just J-35-SSF stainless steel flat grid drain installed. Unit is pre-piped for final hot and cold water connections. Wall support brackets integral to finished end panels. Stainless steel wall clips and chrome plated P-trap included

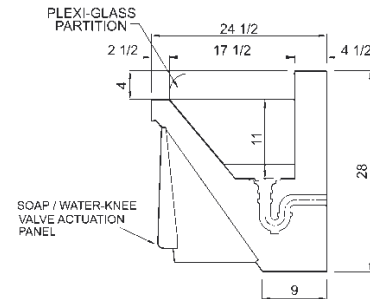
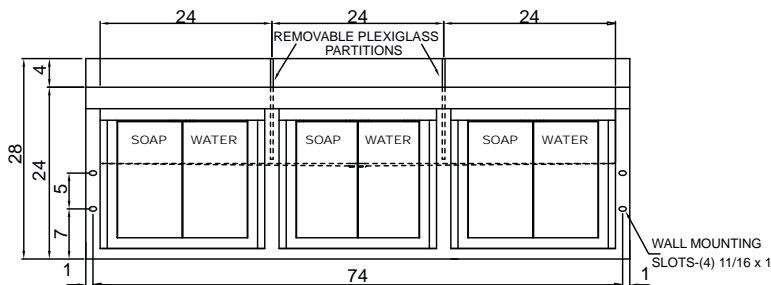
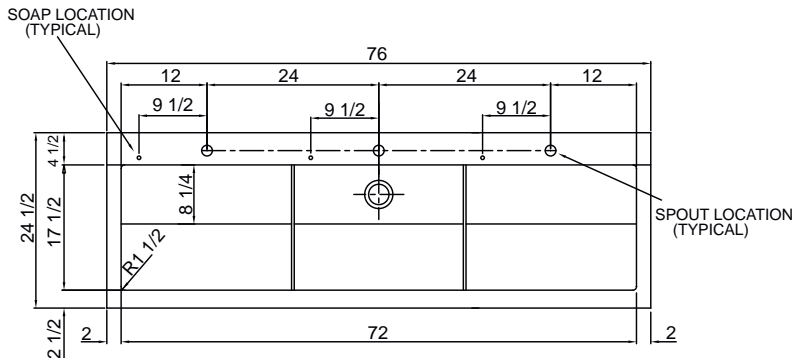

TIMER OPTION

- DT** Digital timer display. Automatically starts timing with water flow. Stops and auto reset when water stops. Factory installed only.
- DTC** Digital timer display with timed cycle. Automatically starts timing with water flow. Stops and auto reset when water stops. Timed cycle allow user to select preset cycle times. Factory installed only.



JUST MFG. COMPANY CONTINUES TO MAKE QUALITY AND FUNCTIONALITY A MARK OF THE JUST PRODUCT LINE. WE RESERVE THE RIGHT TO CHANGE PRODUCT INFORMATION WITHOUT NOTICE. DIMENSIONS MAY CHANGE AND MAY BE SUBJECT TO CHANGE WITHOUT NOTICE. NO RESPONSIBILITY IS ASSUMED FOR USE OF SUPERCEDED OR VOIDED DATA. JUST MFG. CO. SINKS ARE MADE IN THE U.S.A. WHEN COMPARING OTHER BRAND PRODUCTS, BE SURE TO COMPARE USA QUALITY ALONG WITH FEATURES AND DIMENSIONS.

APPROVED FOR MANUFACTURING

MODEL NO.: **JKS-770-3** QTY: _____

JOB NAME: _____

TAG/ITEM: _____

CUSTOMER: _____

SIGNATURE: _____

JUST MANUFACTURING COMPANY

9233 KING STREET . FRANKLIN PARK . ILLINOIS . 60131-2111

PH: 847-678-5150 . FAX: 847-678-6817 . E-MAIL: custserv@justmfg.com . www.justmfg.com



JKS-770-3-S

SURGEON'S SCRUB SINK KNEE ACTIVATED - PRE-PIPED SOAP AND WATER CONTROLS

Water Control Valve and Spout

Chrome plated deck-mounted goose-neck faucet with laminar flow control.

Easy operation single push on / push off water control valve.



JTM-47LF Thermostatic Mixing Valve

Anti-scald mixing valve with bronze body with integral check valves and adjustment cap with locking feature. 1/2" sweat union inlet and outlet connections. Temperature range 60° to 120°F (16°C to 49°C) ASSE Standard ASSE1017, ASSE1069, ASSE1070, IAPMO cUPC. Low Lead Certified to NSF61-G(NSF 372).

J-35-SSF Drain

Type 304 stainless steel drain body, stainless steel flat grid strainer and 1-1/2" O.D. stainless steel tailpiece, 4" long.

JT-150 P-Trap

Chrome plated cast brass 1-1/2" P-trap with cleanout. Drain pipe of 17 ga. chrome plated brass.



-DT Digital timer automatically starts with faucet activation. Display stops and resets when water flow stops. Easy to read LCD display. Display battery operated with near 10-year battery life. Soft display backlight available with low voltage AC adapter. Available only as factory installed option with packaged Just faucet.



-DTC Digital timer automatically starts with faucet activation. Display stops and resets when water flow stops. Timed cycle allows selection of pre-programmed scrub time of 3, 5 or 10 minutes.

Easy to read LCD display. Display battery operated with near 10-year battery life. Soft display backlight. Low voltage. Available only as factory installed option with packaged Just faucet.

JKS-770-3 ROUGH-IN DATA

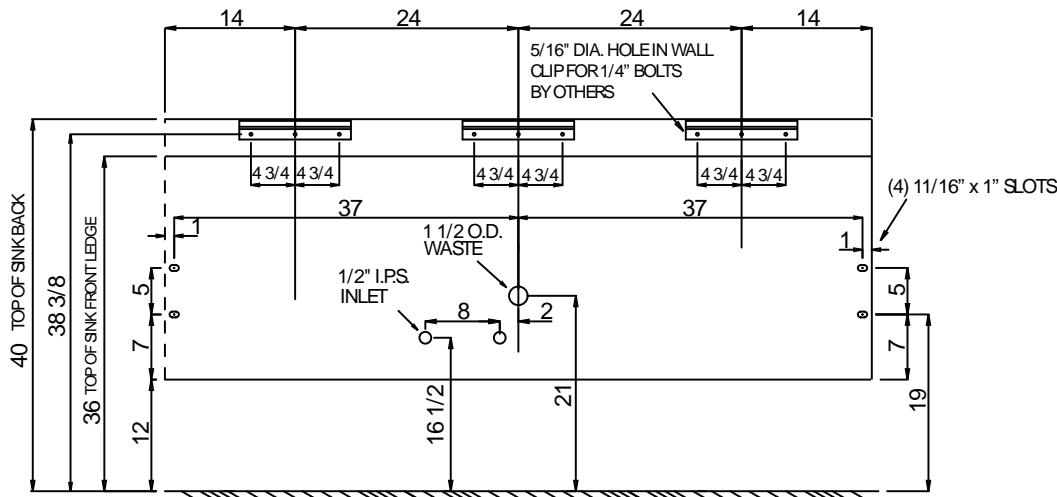

JUST MFG. COMPANY CONTINUES TO MAKE QUALITY AND FUNCTIONALITY A MARK OF THE JUST PRODUCT LINE. WE RESERVE THE RIGHT TO CHANGE PRODUCT INFORMATION WITHOUT NOTICE. DIMENSIONS MAY CHANGE AND MAY BE SUBJECT TO CHANGE WITHOUT NOTICE. NO RESPONSIBILITY IS ASSUMED FOR USE OF SUPERCEDED OR VOIDED DATA. JUST MFG. CO. SINKS ARE MADE IN THE U.S.A. WHEN COMPARING OTHER BRAND PRODUCTS, BE SURE TO COMPARE USA QUALITY ALONG WITH FEATURES AND DIMENSIONS.

JUST MANUFACTURING COMPANY

9233 KING STREET . FRANKLIN PARK . ILLINOIS . 60131-2111

PH: 847-678-5150

FAX: 847-678-6817

E-MAIL: custserv@justmfg.com

www.justmfg.com