

SPECIFICATION SUBMITTAL SHEET

J O N E S S T E P H E N S C O R P O R A T I O N

SEWER POPPER™ CLEANOUT AND RELIEF VALVE

specification submittal sheet

PART NO. S62-304

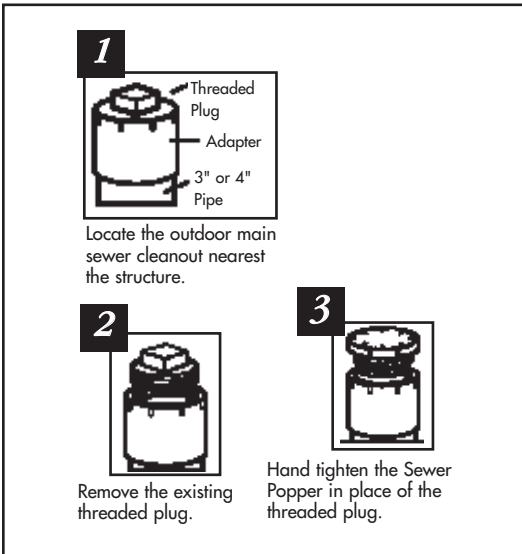

- Automatic pop-up releases sewage overflow outside the house
 - Prevents thousands of dollars in property damages
- Eliminates health hazards associated with sewage overflow
 - Vandal- and tamper-resistant center
 - Threaded for 3" or 4" pipe or tapped adapter
 - Constructed of white PVC
- Threaded unit can be used with PVC or ABS tapped adapter
 - For cast iron pipe, use standard no hub clamp
- Meets Southern Building Code Section 301.10, Principle No. 10
 - Patent No. 5,209,257

•SEE THE JONES STEPHENS CATALOG FOR MORE INFORMATION ON THIS AND OTHER ITEMS.

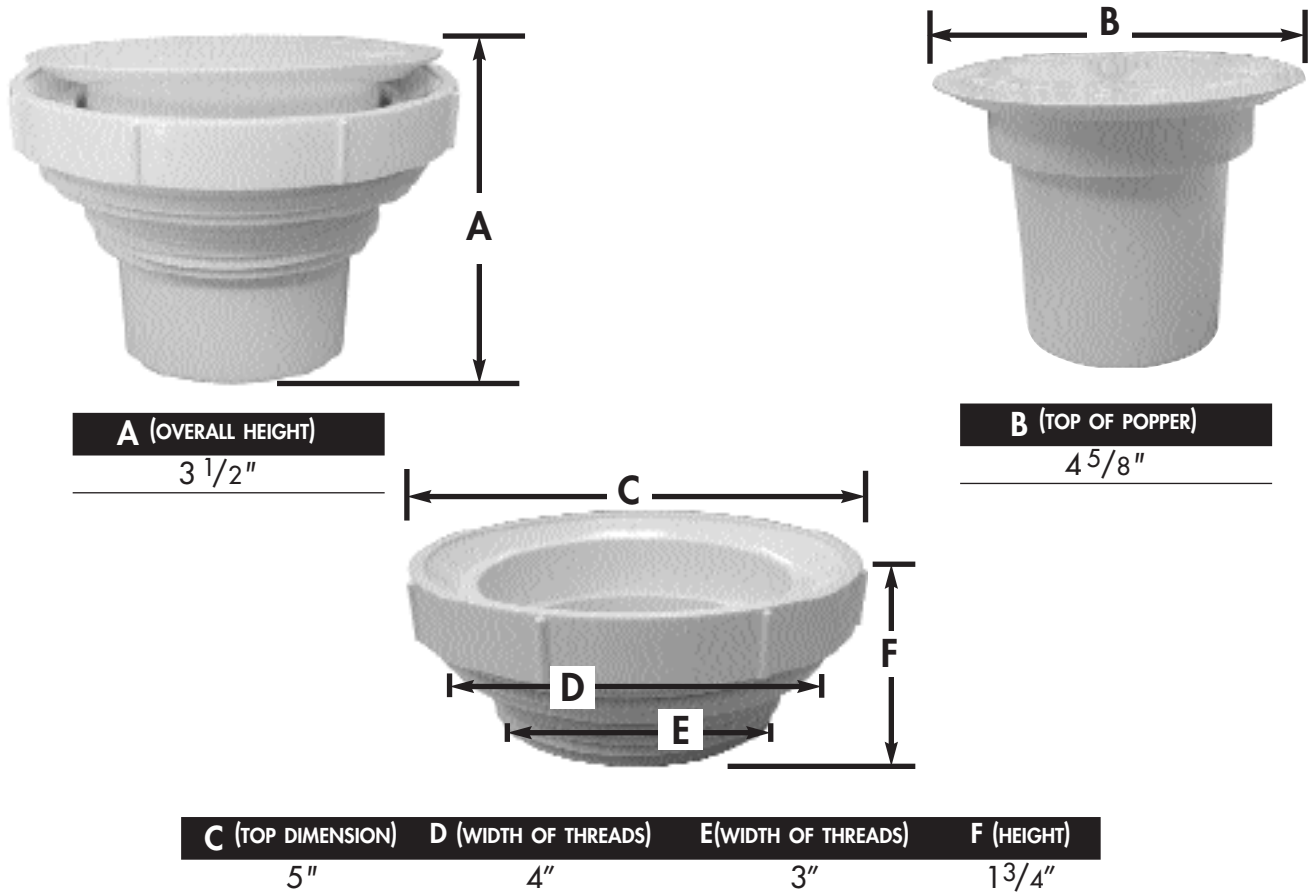

3249 Moody Parkway • Moody, Alabama • 205•640•7200 • Toll Free 1•800•35•JONES
 Fax (205) 640-7070 • Toll Free Fax 1•800•462•6991
www.plumbest.com