

SPECIFICATION SUBMITTAL SHEET

jones stephens corporation

4" OVER PIPE FIT BASE WITH 4" IPS METAL SPUDS

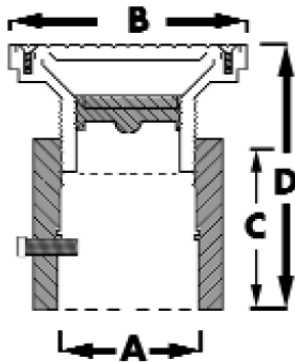

CLEANOUT DIMENSIONS

	A	B	C	D
Without ring	Over 4" pipe	6"	4 ³ / ₄ "	6 ¹ / ₁₆ "-7 ³ / ₁₆ "
With ring	Over 4" pipe	6 ¹ / ₈ "	4 ³ / ₄ "	6 ¹ / ₈ "-7 ¹ / ₄ "
Square	Over 4" pipe	7"	4 ³ / ₄ "	6 ³ / ₁₆ "-7 ³ / ₈ "
Metal spud	Over 4" pipe	5"	4 ³ / ₄ "	5"-6"
Metal spud	Over 4" pipe	6"	4 ³ / ₄ "	5"-6"



FEATURES

- Supplied with 3" IPS (3¹/₂" OD) countersunk plug
- Cover available in PB and NB
- Covers are 3¹/₁₆" thick
- Adjustable (see dimension D)

PVC	(BASE + SPUD)	ABS	(BASE + SPUD)	COVER	CTN. QTY.
C60-082	(D52-014 + C37-805)	C60-083	(D52-017 + C37-805)	5" NB	1
C60-092	(D52-014 + C37-806)	C60-093	(D52-017 + C37-806)	5" PB	1
*C60-094	(D52-014 + C37-807)	C60-095	(D52-017 + C37-807)	6" NB	1
*C60-096	(D52-014 + C37-808)	C60-097	(D52-017 + C37-808)	6" PB	1



jones stephens corporation

3249 moody parkway • moody, alabama 35004

toll free phone: 1-800-355-6637 • toll free fax: 1-800-462-6991

www.plumbest.com