

# SPECIFICATION SUBMITTAL SHEET

jones stephens corporation

## 4" OVER PIPE FIT BASE WITH 4" IPS METAL SPUDS

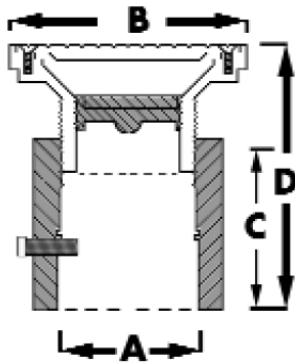

CLEANOUT DIMENSIONS

	A	B	C	D
Without ring	Over 4" pipe	6"	4 <sup>3</sup> / <sub>4</sub> "	6 <sup>1</sup> / <sub>16</sub> "-7 <sup>3</sup> / <sub>16</sub> "
With ring	Over 4" pipe	6 <sup>1</sup> / <sub>8</sub> "	4 <sup>3</sup> / <sub>4</sub> "	6 <sup>1</sup> / <sub>8</sub> "-7 <sup>1</sup> / <sub>4</sub> "
Square	Over 4" pipe	7"	4 <sup>3</sup> / <sub>4</sub> "	6 <sup>3</sup> / <sub>16</sub> "-7 <sup>3</sup> / <sub>8</sub> "
Metal spud	Over 4" pipe	5"	4 <sup>3</sup> / <sub>4</sub> "	5"-6"
Metal spud	Over 4" pipe	6"	4 <sup>3</sup> / <sub>4</sub> "	5"-6"



### FEATURES

- Supplied with 3" IPS (3<sup>1</sup>/<sub>2</sub>" OD) countersunk plug
- Cover available in PB and NB
- Covers are 3<sup>1</sup>/<sub>16</sub>" thick
- Adjustable (see dimension D)

PVC	(BASE + SPUD)	ABS	(BASE + SPUD)	COVER	CTN. QTY.
C60-082	(D52-014 + C37-805)	C60-083	(D52-017 + C37-805)	5" NB	1
C60-092	(D52-014 + C37-806)	C60-093	(D52-017 + C37-806)	5" PB	1
*C60-094	(D52-014 + C37-807)	C60-095	(D52-017 + C37-807)	6" NB	1
*C60-096	(D52-014 + C37-808)	C60-097	(D52-017 + C37-808)	6" PB	1



jones stephens corporation  
 3249 moody parkway • moody, alabama 35004  
 toll free phone: 1-800-355-6637 • toll free fax: 1-800-462-6991  
 www.plumbest.com