

# Cast Iron Check Valve

## Horizontal Swing • Bolted Bonnet • Class 125

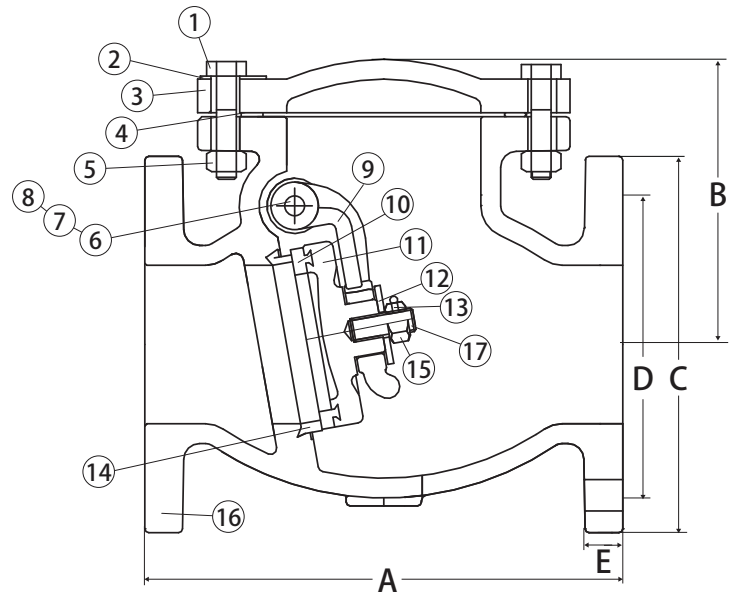

F-571



### Approvals

- Lead Free Compliant
- Conforms to MSS SP-71
- Flange: ASME B16.1
- Face to Face: ANSI B16.1

### Pressure Ratings

- Class 125
- Suitable for 125 PSI WSP

### Dimensions

| Part No. | Size   | Weight | A     | B     | C     | D     | E    |
|----------|--------|--------|-------|-------|-------|-------|------|
| 105-725  | 2-1/2" | 24     | 8.50  | 5.24  | 7.01  | 5.49  | 0.81 |
| 105-703  | 3"     | 44     | 9.50  | 5.67  | 7.52  | 6.00  | 0.88 |
| 105-704  | 4"     | 78     | 11.50 | 6.61  | 9.01  | 7.50  | 0.92 |
| 105-706  | 6"     | 152    | 14.00 | 8.54  | 10.98 | 9.51  | 1.00 |
| 105-708  | 8"     | 259    | 19.49 | 10.27 | 13.50 | 11.75 | 1.12 |
| 105-710  | 10"    | 417    | 24.49 | 11.30 | 15.98 | 14.25 | 1.19 |
| 105-712  | 12"    | 615    | 27.50 | 12.56 | 19.01 | 17.01 | 1.25 |

Install 5 pipe diameters minimum downstream from pump discharge or changes in direction to avoid flow turbulence. Flow straighteners may be required in extreme cases.

Note: On pump discharge, the preferred check valves are: inline, spring assisted, center-guided, lift checks.

### Material Specifications

| No. | Part                 | Materials                  |
|-----|----------------------|----------------------------|
| 1   | Bolts                | Steel - ASTM A307 B        |
| 2   | Identification Plate | Aluminum                   |
| 3   | Bonnet               | Cast Iron - ASTM A126      |
| 4   | Body Gasket          | Graphite                   |
| 5   | Nuts                 | Steel - ASTM A307 B        |
| 6   | Side Plug            | Cast Bronze - ASTM B62     |
| 7   | Gasket               | Fiber                      |
| 8   | Hanger Pin           | Cast Bronze - ASTM B62     |
| 9   | Hanger               | Ductile Iron - ASTM A536   |
| 10  | Disc Ring            | Cast Bronze - ASTM B62     |
| 11  | Disc                 | Cast Iron - ASTM A126      |
| 12  | Washer               | Steel - ASTM A307          |
| 13  | Split Pin            | Stainless Steel - ASTM 420 |
| 14  | Seat Ring            | Cast Bronze - ASTM B62     |
| 15  | Disc Nut             | Steel - ASTM A307 B        |
| 16  | Body                 | Cast Iron - ASTM A126      |
| 17  | Stud Bolt            | Steel - ASTM A307 B        |