

Breckenridge Copper

Hand-Hammered Copper and Pewter Sinks

Silverton Copper Lavatory Sink

Model SIL-2116FL-AC

SIL-2116FL-PW

SIL-2116SR-AC

SIL-2116SR-PW



FEATURES

- This unique ellipses design boasts size and beauty in equal measure
- 21" x 15-1/2" OD
- 5" depth
- 1-1/2" drain opening

Model information

- **SIL-2116FL-AC** Oval Sink/ Flat Lip, Antique copper w/ overflow
- **SIL-2116FL-PW** Oval Sink/ Flat Lip, Lustrous pewter w/ overflow
- **SIL-2116SR-AC** Oval Sink/ Self Rimming, Antique copper w/ overflow
- **SIL-2116SR-PW** Oval Sink/ Self Rimming, Lustrous pewter w/ overflow

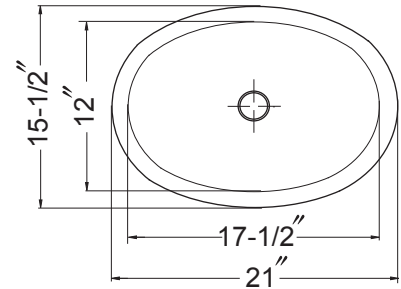

Installation information

Your Hammerwerks® Hand-Hammered Copper sink is individually hand-crafted and not the product of assembly-line specifications. Every sink is unique and therefore a variance of approximately 1/4" in dimensions is usual. We recommend receiving your specific sink and measuring before cutting your countertop to ensure proper fit.

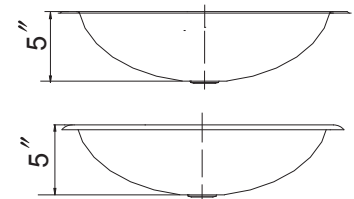

OVERALL DIMENSIONS	EACH BOWL	CUTOUT SIZE	PACKAGING*	WEIGHT*
21" x 15-1-2"	17-1/2" x 12"	See Template	1/16 pcs.	10/200 lbs.

*Standard packaging: Single boxed /Pallet of single boxed.

All dimensions are in inches. Specifications subject to change without notice.

Project/Job name

Architect/Engineer

Contractor

Model

Q'ty

Notes