

Breckenridge Copper

Hand-Hammered Copper and Pewter Sinks

Medium Square Bar/Prep Sink

Model BRE-1313B7-AC

BRE-1313B7-PW



FEATURES

- Medium Square Bar/Prep sink
- 13"x 13" overall
- 6-1/4" depth
- 3-1/2" drain opening

Model information

- **BRE-1313B7-AC** Bar-Prep sink/Flat Lip, Antique copper
- **BRE-1313B7-PW** Bar-Prep sink/Flat Lip, Lustrous pewter

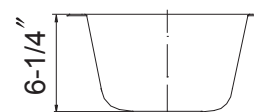
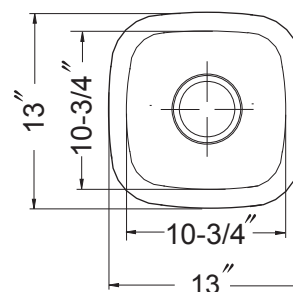

Installation information

Your Hammerwerks® Hand-Hammered Copper sink is individually hand-crafted and not the product of assembly-line specifications. Every sink is unique and therefore a variance of approximately 1/4" in dimensions is usual. We recommend receiving your specific sink and measuring before cutting your countertop to ensure proper fit.

| OVERALL DIMENSIONS | EACH BOWL | CUTOUT SIZE | PACKAGING* | WEIGHT* |
|--------------------|-------------------|--------------|------------|-------------|
| 13" x 13" | 10-3/4" x 10-3/4" | See Template | 1/16 pcs. | 11/216 lbs. |

*Standard packaging: Single boxed /Pallet of single boxed.

All dimensions are in inches. Specifications subject to change without notice.

Project/Job name

Architect/Engineer

Contractor

Model

Q'ty

Notes