

Art. V272BU+D331AU

Thermostatic mixer with integrated volume control

- For horizontal installation
- 3/4" NPT inlets and outlets
- With shut-off valve
- Rectangular backplate
- Handle included
- 15.3 GPM @ 60 PSI (primary outlet)

Trim

Finishes:

- Chrome** 51 02 V272BU
- Matte Black** 51 13 V272BU
- Matte White** 51 29 V272BU

Rough

Finishes:

- 19 00 D331AU



Project:

Room:

Date:

Comments:

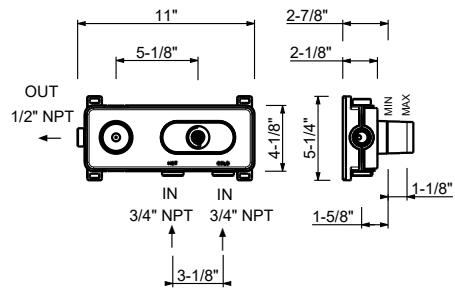
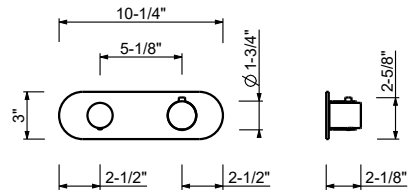

Certifications/Awards:

