

Instructions
Instrucciones

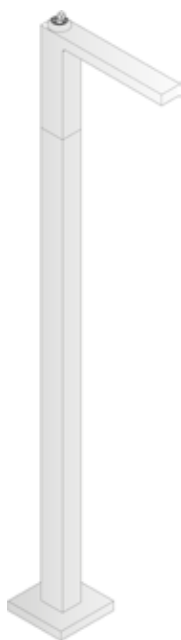

3336SBU

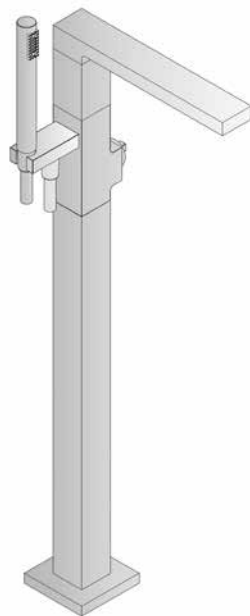

3380SBU



Art. 3336SBU

- Floor-standing wash-basin mixer tap
- Mezclador fregadero de suelo

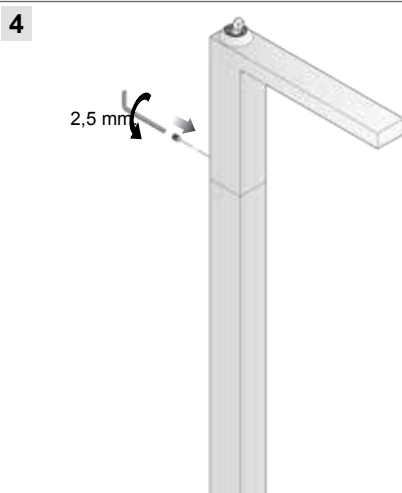
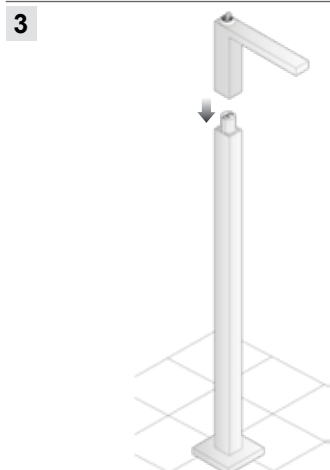
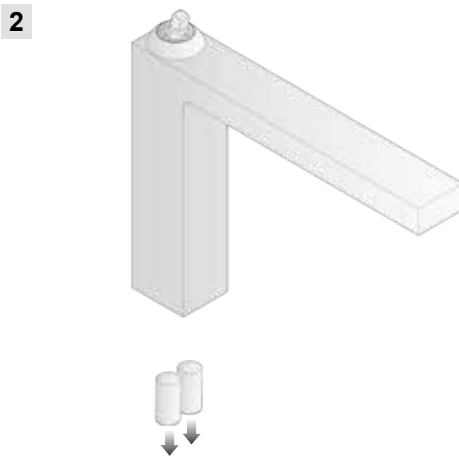
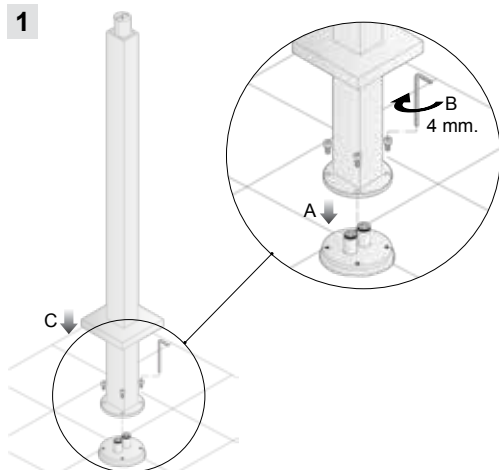
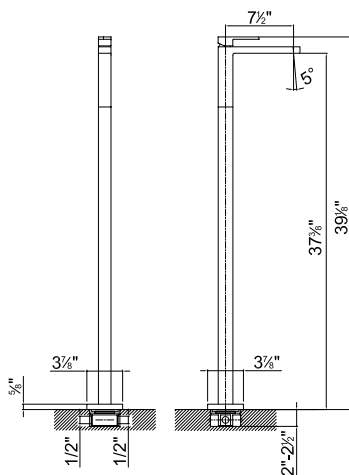

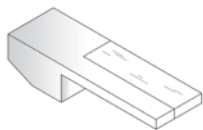

Art. 3348U

- Handle
- Maneta

1

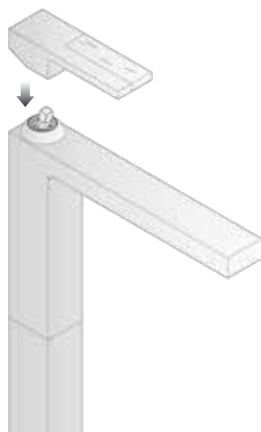

2

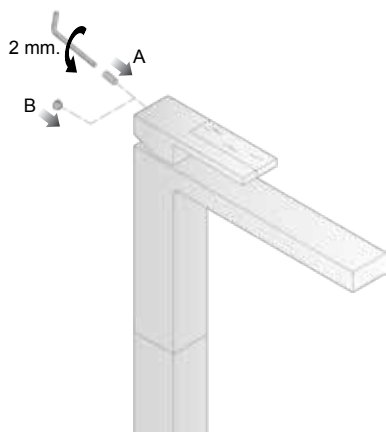

3

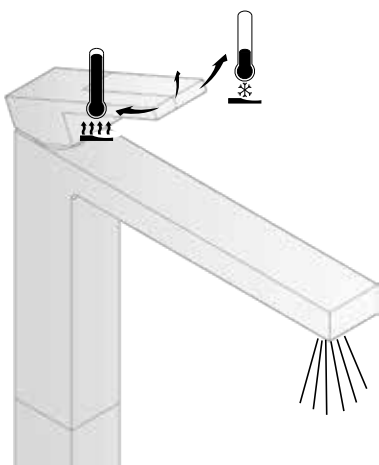

cartridge replacement

- Cartridge replacement
- Sustitución del cartucho

1

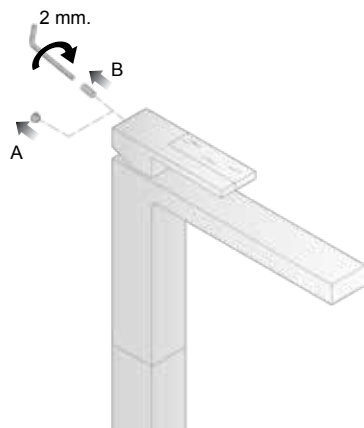

2

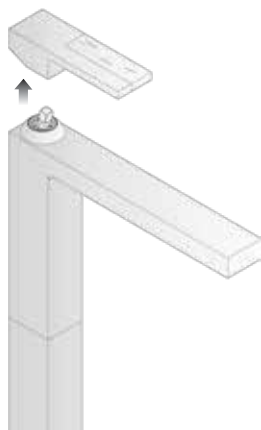

3

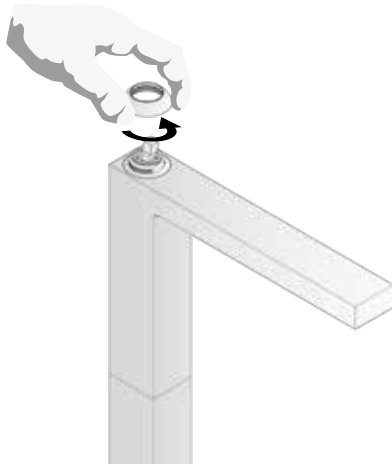

4



5

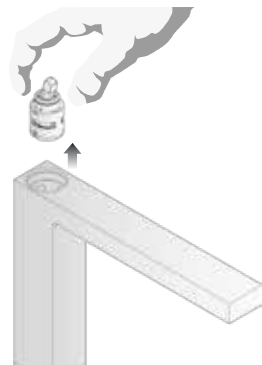

- Replace following the instructions in reverse order (5-4-3-2-1)
- Colocar según el procedimiento inverso (5-4-3-2-1)

- Aerator replacement
- Sustitucion del aireador

1

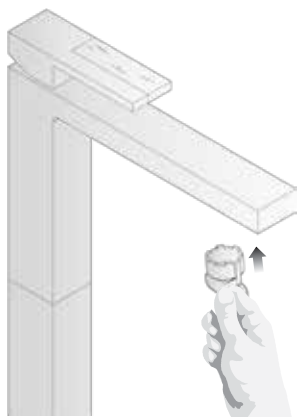

2

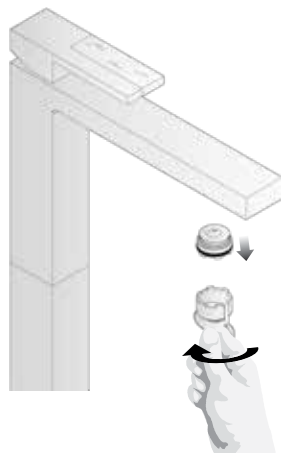

- Replace following the instructions in reverse order (2-1)
- Colocar según el procedimiento inverso (2-1)

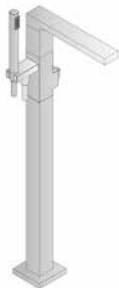

Art. 3380SBU

- Floor-standing bath mixer tap
- Mezclador bañera de columna

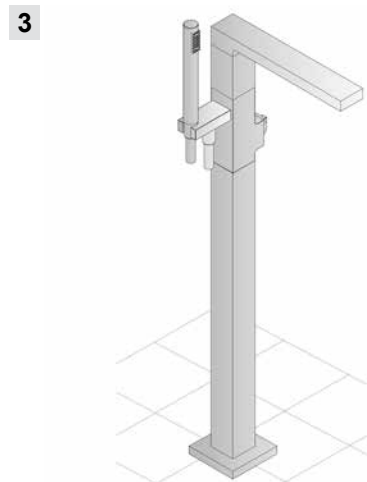
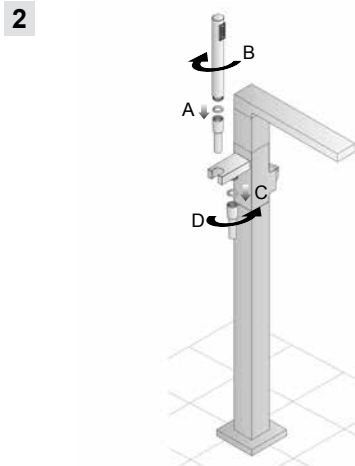
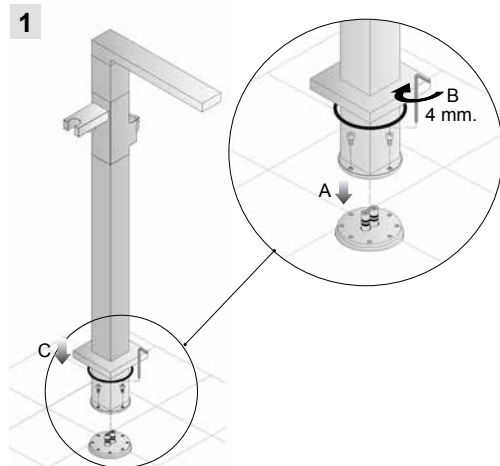
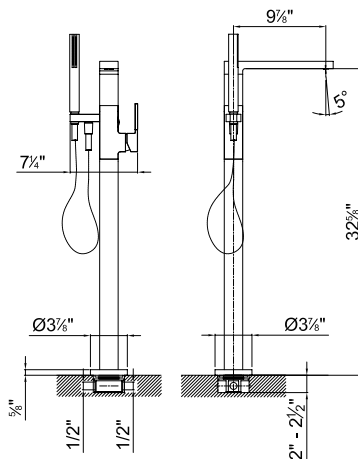

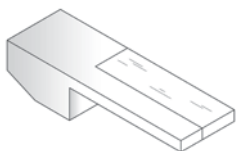

Art. 3347U

- Handle
- Maneta

1

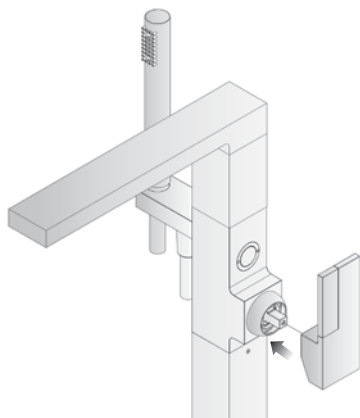

2

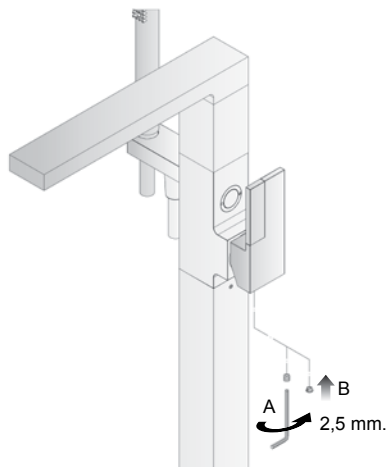

3

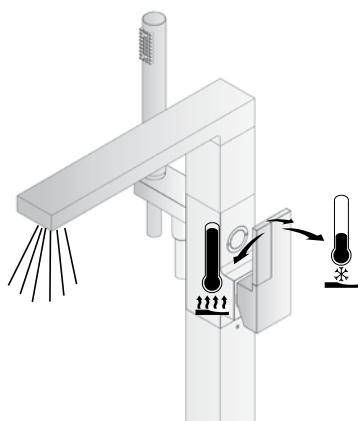

4

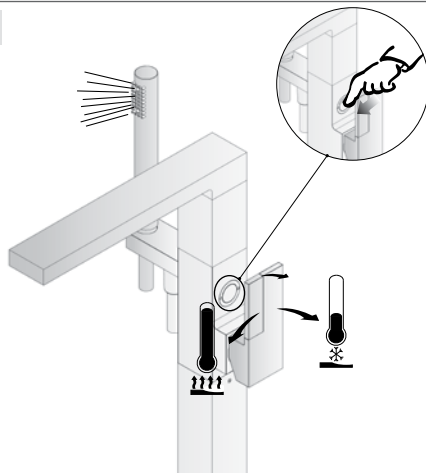

- Cartridge replacement
- Sustitucion del cartucho

1

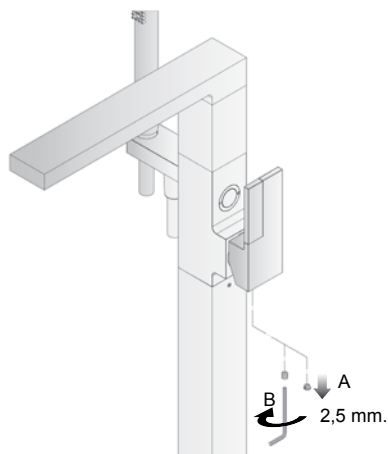

2

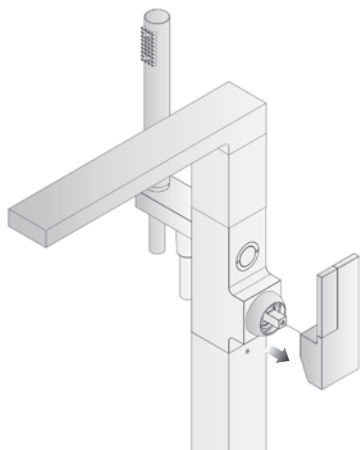

3

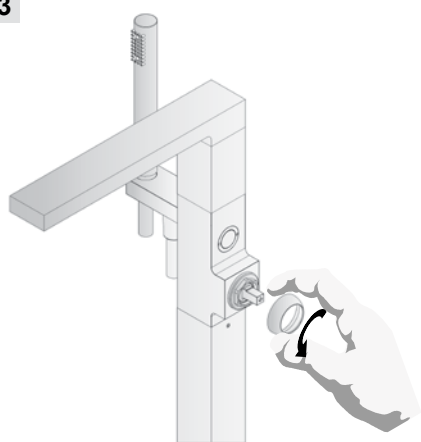

4

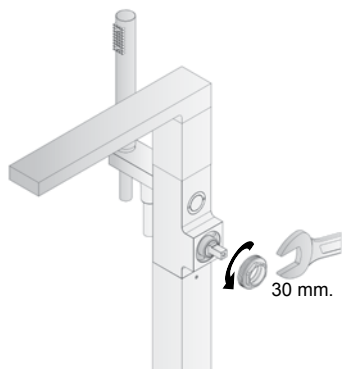

5

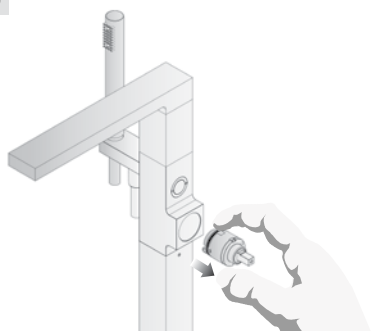

- Replace following the instructions in reverse order (5-4-3-2-1)
- Colocar según el procedimiento inverso (5-4-3-2-1)

- Aerator replacement
- Sustitucion del aireador

1

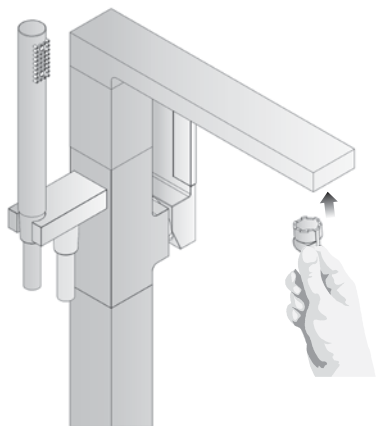

2

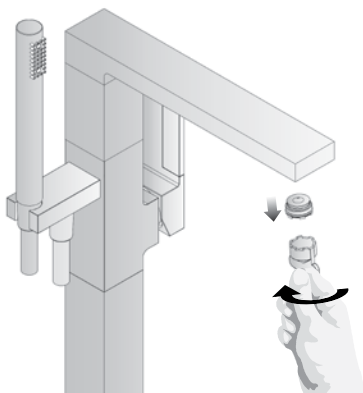

- Replace following the instructions in reverse order (2-1)
- Colocar según el procedimiento inverso (2-1)

Technical characteristics

MINIMUM PRESSURE.....	14 PSI
MAXIMUM PRESSURE.....	145 PSI
RECOMMENDED	
WORKING PRESSURE.....	30-70 PSI
MAXIMUM WATER TEMPERATURE.....	176°F
MAXIMUM WATER	
TEMPERATURE RECOMMENDED.....	150°F
MAXIMUM IN-LET PRESSURE	
DIFFERENCE (HOT - COLD).....	22 PSI

Operating instructions

These mixers can be used with cumulus boilers or instantaneous water heaters. (NOT OPTIMUM SOLUTION)

Warning

The supplying pipes must be carefully cleaned before installation.
Remember that the hot water supply must ALWAYS be connected to the tube on the LEFT.

Datos Técnicos

PRESION MÍNIMA.....	14 PSI
PRESION MÁXIMA.....	145 PSI
PRESION DE TRABAJO	
ACONSEJADA.....	30-70 PSI
TEMPERATURA MÁXIMA.....	176°F
TEMPERATURA MÁXIMA	
ACONSEJADA.....	150°F
DIFERENCIAL MÁXIMA DE	
PRESIÓN DE ENTRADA (CALIENTE - FRIA).....	22 PSI

Aplicaciones

Estos monomandos pueden ser utilizados con acumuladores de agua caliente a presión. (SOLUCIÓN NON OPTIMALE)

Advertencias

Antes de conectar el monomando es necesario purgar correctamente la instalación hidráulica de alimentación de cualquier impureza que pueda tener.
Recuerde que el agua caliente debe ser SIEMPRE conectada al tubo o flexo de la IZQUIERDA.

ADVICE ON PRODUCT CARE

To clean de surface use a soap and water solution.

Never use for any reason cleaning solutions containing abrasive substances, chloric acids, ammonia, varnish remoner, bleach, domestic acids, disinfectants, or anytype of abrasive pad.

WARNING! Incorrect cleaning may permanently ruin the surface of the products and in such case *FANTINI S.p.A.* may not be held liable for damage.

The Manufacturer reserves the right to modify product and accessories at any time without prior notice. Datas, products and sketches included in this document are just for information and do not bind the producer.

CONSEJOS PARA EL CUIDADO DEL PRODUCTO

La limpieza de las superficies se hace utilizando un jabón líquido diluido en agua.

No usar en ningún caso detergentes líquidos que contengan sustancias abrasivas ó a base de ácido clorhídrico, estropajossabrasivos, amoníaco, acetona, lejía, ácidos de uso doméstico, desinfectantes varios.

ATENCIÓN! El uso de productos desaconsejados puede dañar irremediablemente las superficies de los elementos, de lo cual *FANTINI S.p.A.* no se hará responsable en ningún caso.

La sociedad se reserva el derecho de modificar sus productos y accesorios en cualquier momento y sin previo aviso.



FRATELLI FANTINI S.p.A.
28010 Pella (NO) - Via M. Buonarroti, 4
Telefono + 39 0322.918411 r.a. - Telefax + 39 0322.969530
e-mail: fantini@fantini.it www.fantini.it

