

FF3450 and FFP3450 Repair Guide

Spare/Replacement List

- A. F3419 Spray Hose Assembly
- B. F3420 Spray Head Assembly
- C. F3429 Aerator
- D. F3418 Aerator Wrench
- E. F0304 Cartridge
- F. F3412 Cartridge Nut
- G. F3413 Cartridge Cap
- H. F3414 Handle Assembly
- I. F3415 Fastening Set
- J. F3416 Hot Supply Hose
- K. F3417 Cold Supply Hose
- L. F3421 Check Valve Holder
- M. F3422 Check Valve
- N. F3423 Weight

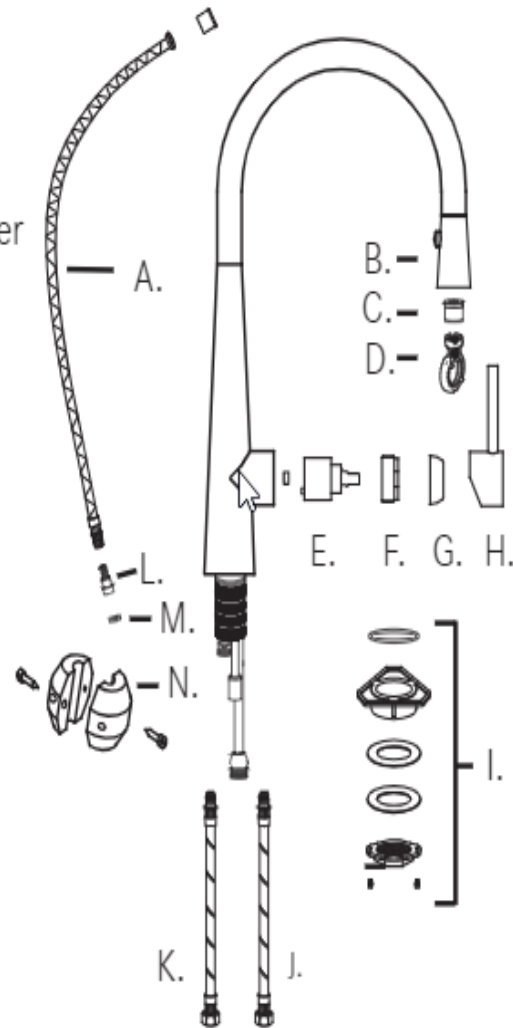

Cartridge Change Guide

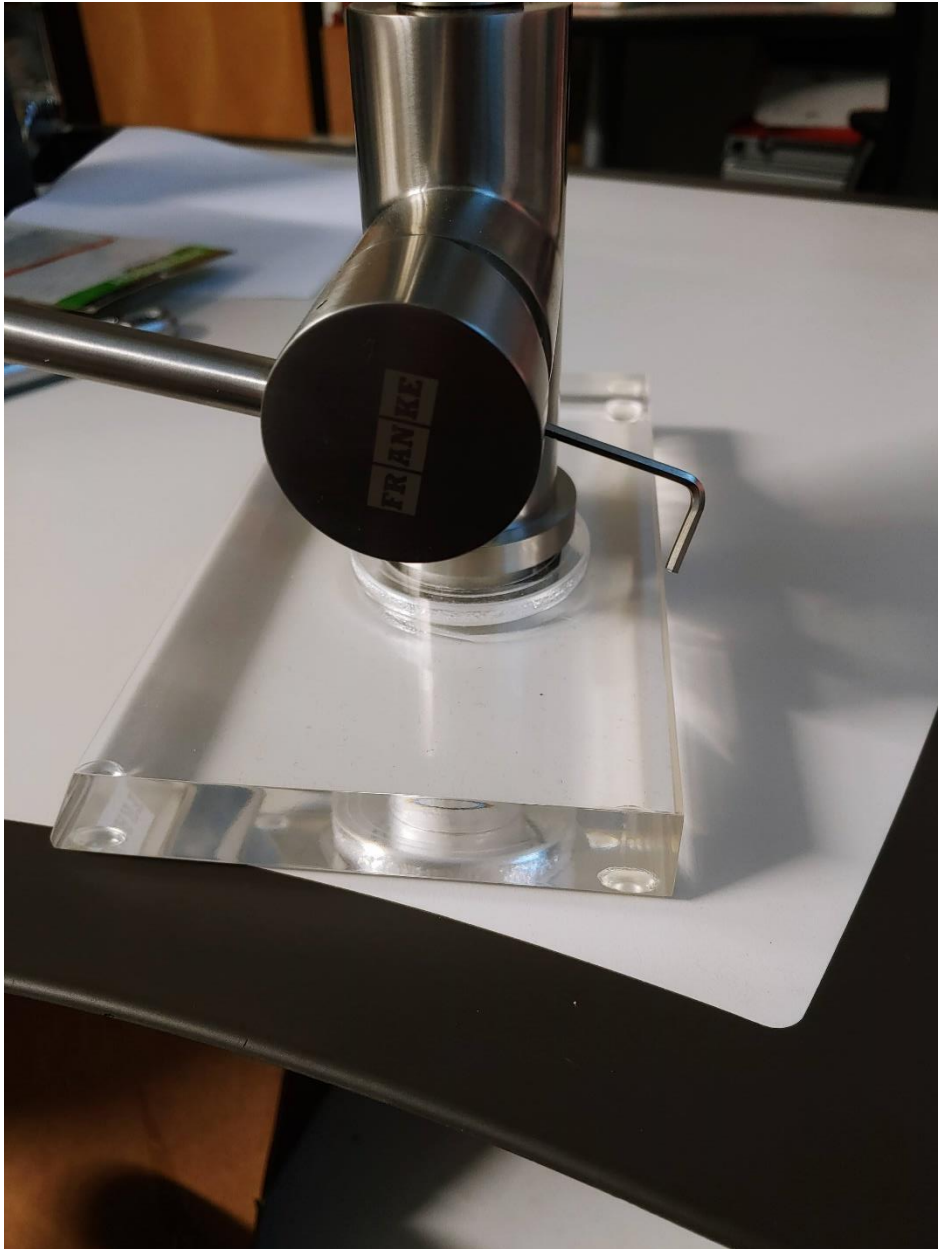

Turn off the hot and cold water supplies to the faucet
Remove the lever by inserting a 2.5mm Allen wrench on the bottom to loosen the 2.5mm set screw (see photo for positioning.)

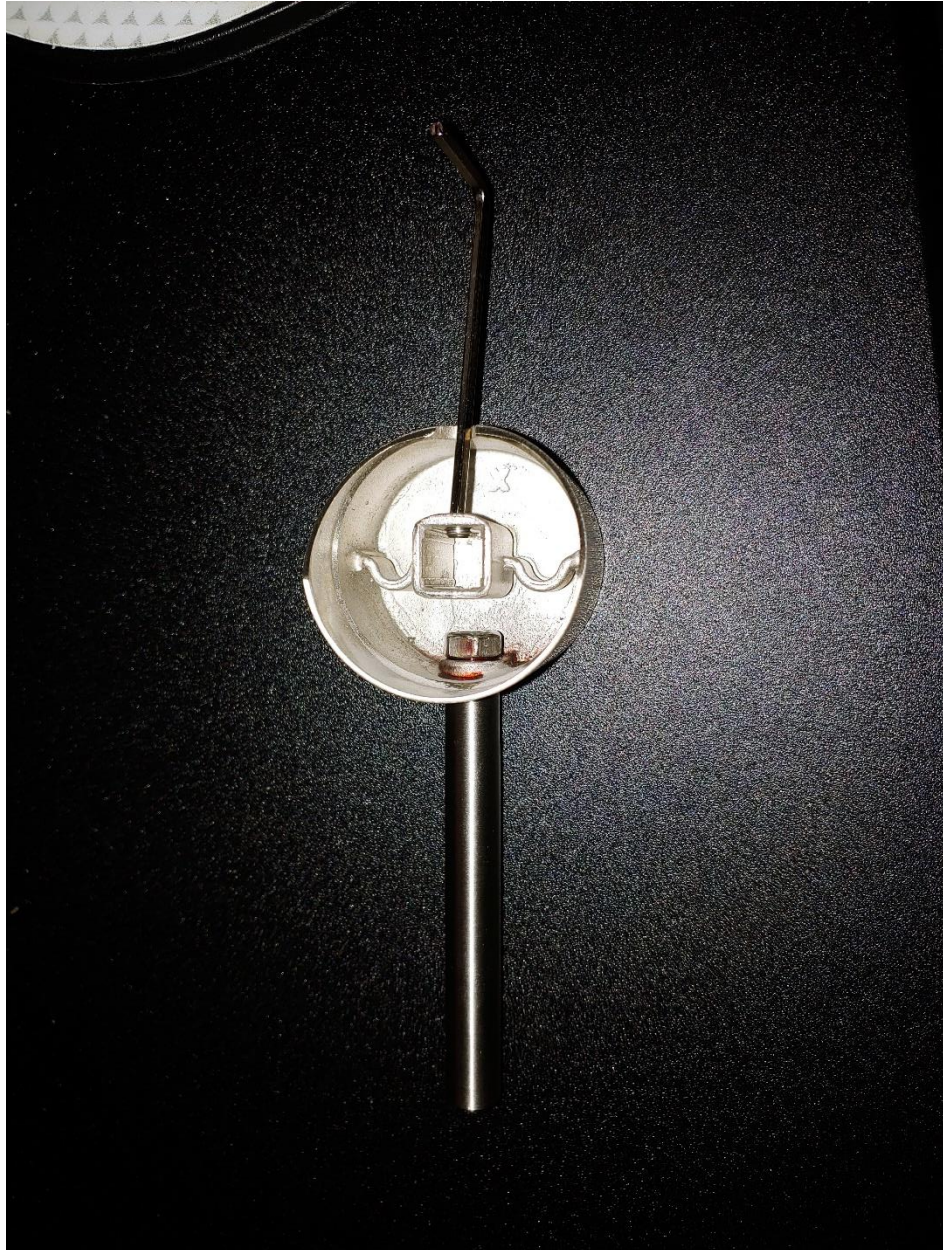

Once the set screw is sufficiently loose the lever (Part H) can be separated from the faucet.



Remove the cap (Part G) by rotating counterclockwise to remove from faucet.



Rotate cartridge nut (Part F), with a crescent wrench or 30mm socket wrench and rotate counterclockwise until removed.



This is what the faucet looks like with the cartridge removed

Flow Rate Issues



To troubleshoot flow rate issues, remove the cartridge as stated above. Once the cartridge is removed locate the flow regulator (see photo). Remove the flow regulator with a small pair of needle nose pliers and reassemble the faucet. Turn the water suppliers back on and examine flow rate.

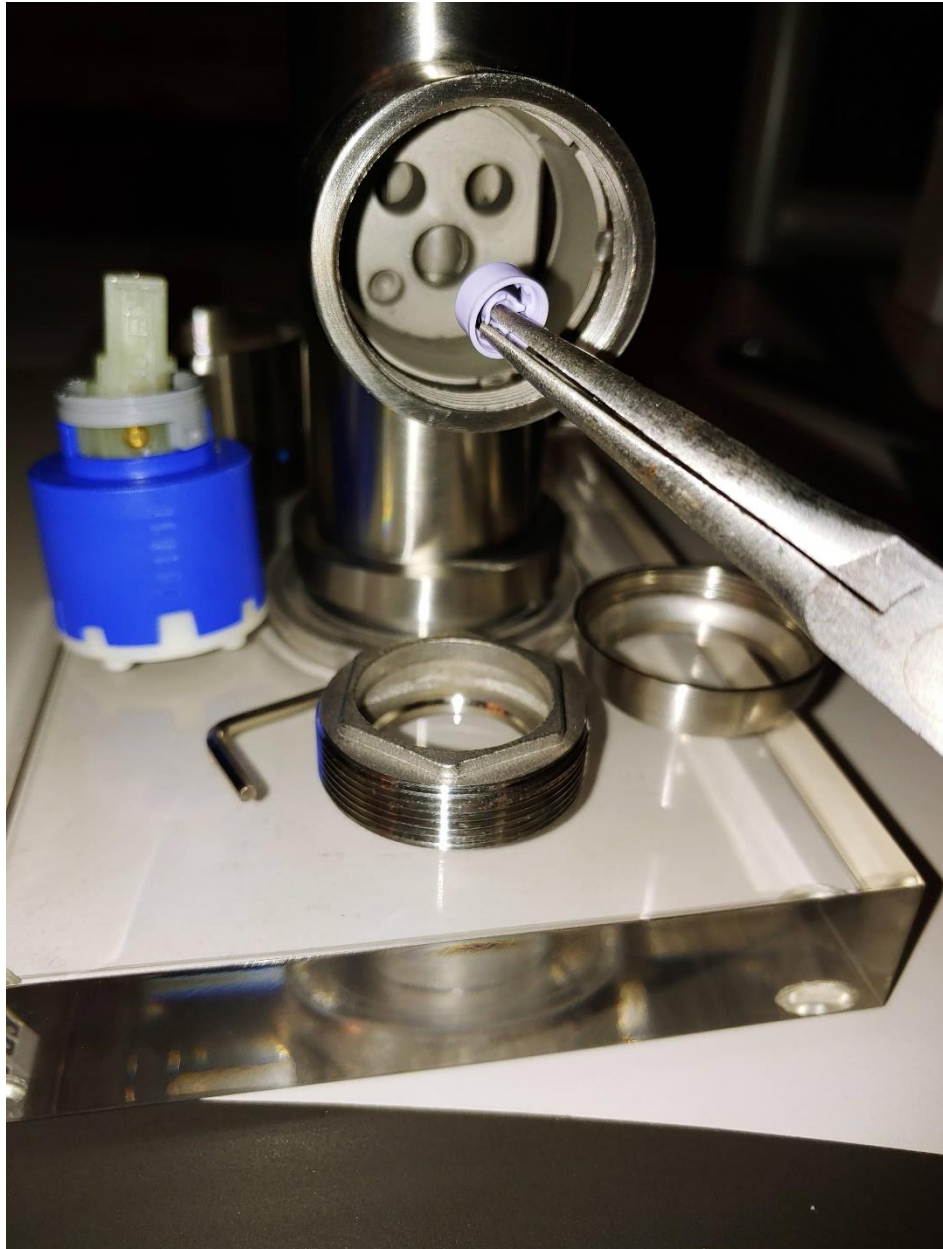

This is what the flow regulator looks like when removed

Type 1 Spray hose removal



Locate the nut pictured above and rotate counter-clockwise



Once this nut is sufficiently loose slide it down the spray hose to get it out of the way.



Pull down on the spray hose until the check valve holder at the end of the hose comes free. This should normally have 3 O-rings.



Twist off the check valve holder so it can be transferred to the new hose.

Type 2 and 3 spray hose change