



SENZA

INSTALLATION GUIDE

FVN9048-D

CONTENTS:

Mirror	FMC8010	PAGE 3
Cabinet	FCB9048-D	PAGE 5
Sink	FVS9048WH-D	PAGE 5

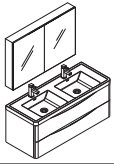

FVN9048-D
SENZA
INSTALLATION GUIDE



FVN9048-D
Vanity Front

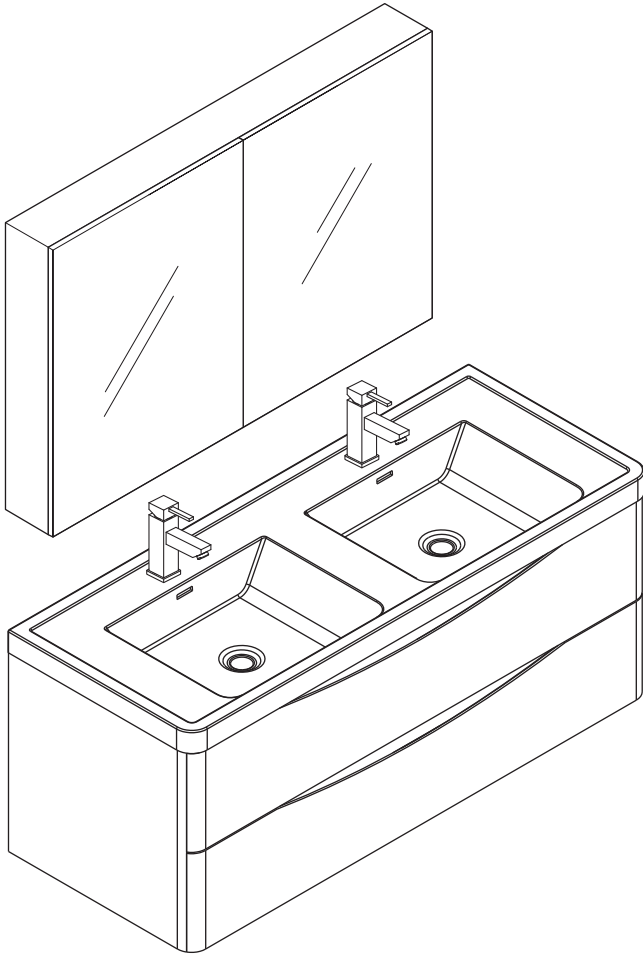

FMC8010
Medicine Cabinet Front

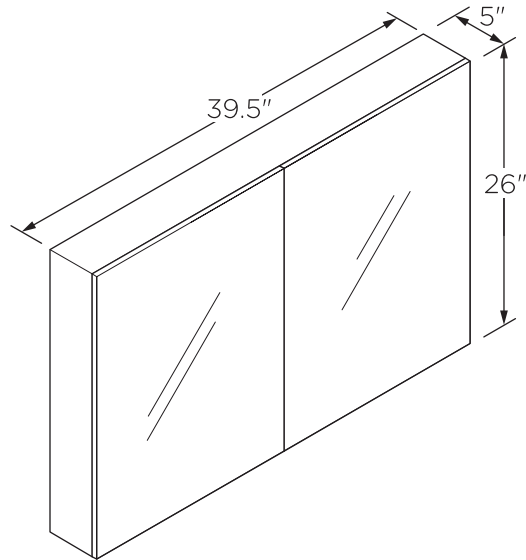

FVS9048WH-D
Counter Top Front

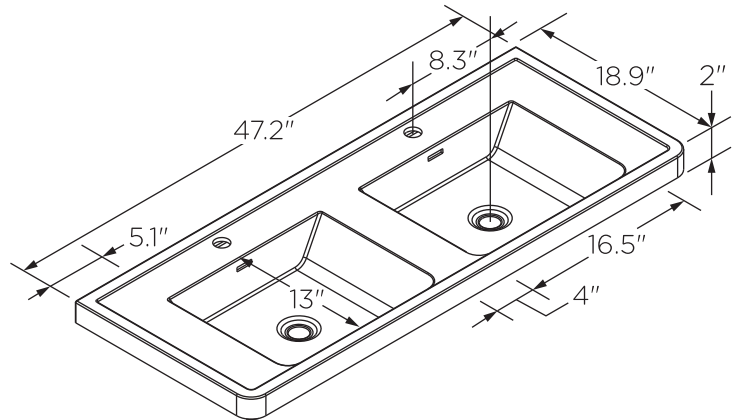

FCB9048-D
Cabinet Front

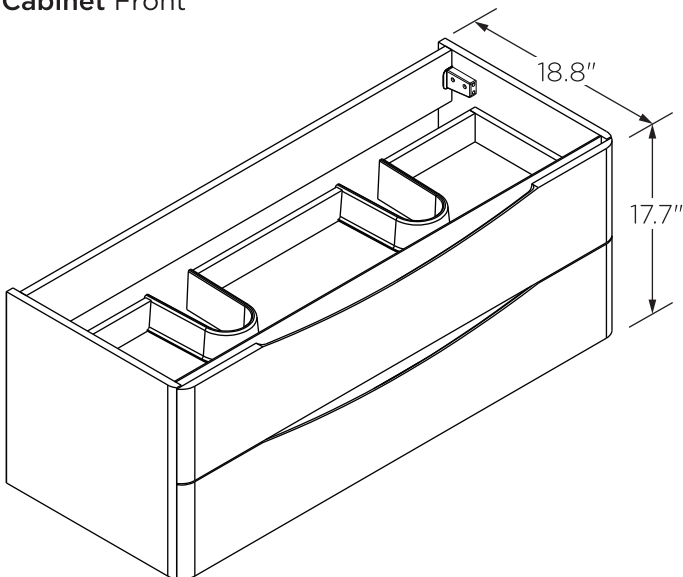

FCB9048-D
Cabinet Back

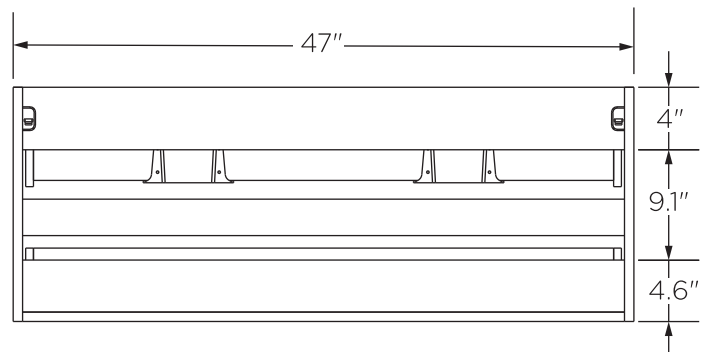

NOTE: All dimensions & specifications are approximate and subject to change without notice.

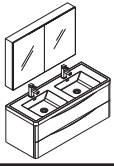

FVN9048-D SENZA INSTALLATION GUIDE



TOOLS FOR ASSEMBLY

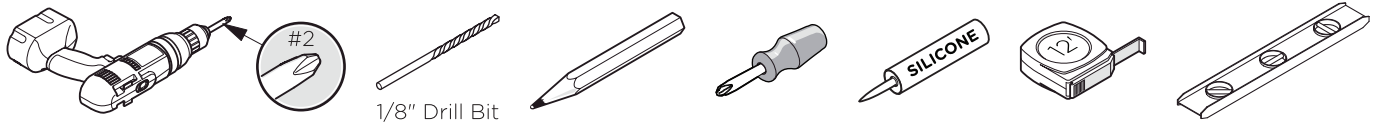

SUPPLIED PARTS

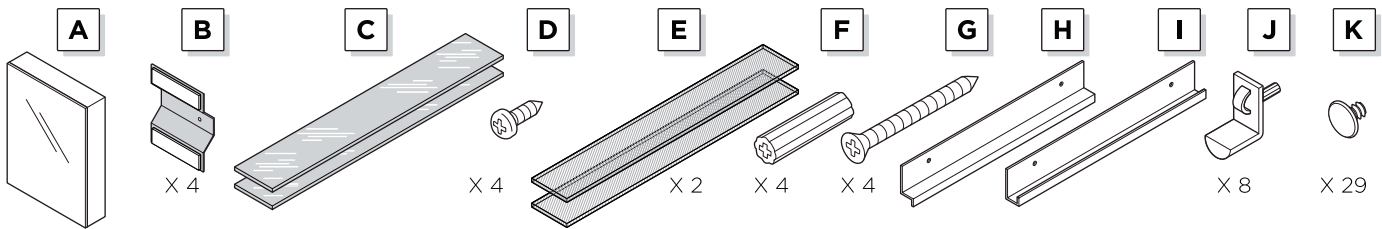

Your item may appear slightly different from the illustration

MEDICINE CABINET DIMENSIONS

Model SKU	Width A	Height B	Depth
FMC8058	19.5"	26"	5"
FMC8090	29.5"	26"	5"
FMC8010	39.5"	26"	5"

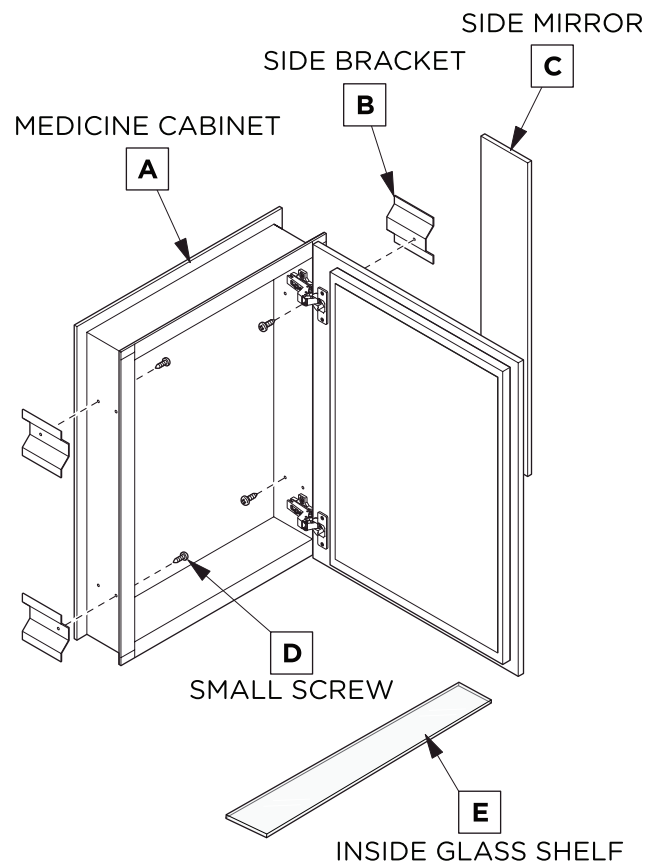
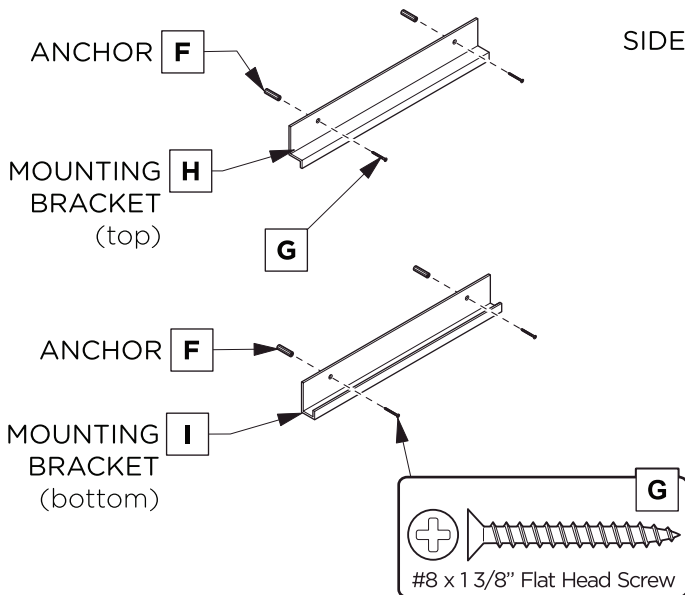

DANGER:
Risk of electronic shock. Avoid existing electrical wiring or plumbing when mounting this product to the wall.



WARNING:
Risk of property damage. Use anchors rated for the loaded weight of the product. Refer to the anchor manufacturer's instructions.

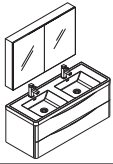

FVN9048-D SENZA INSTALLATION GUIDE



SURFACE-MOUNT INSTALLATION

1

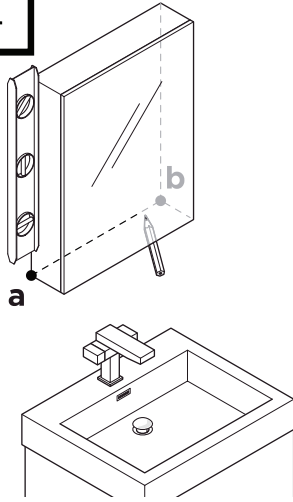

Level and mark the medicine cabinet's location on the wall from point **a** to point **b**.

2

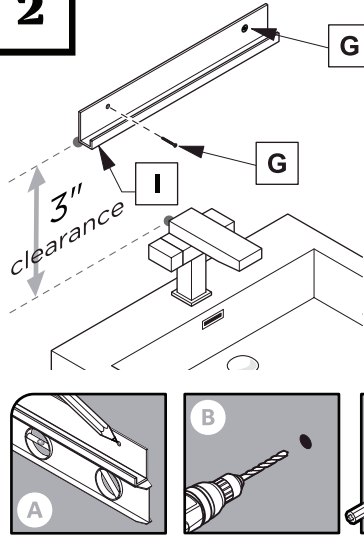

Level and mark.

Drill the holes in the wall with a 3/16" drill bit.

Insert the anchors in the holes.

Attach bottom bracket to the wall.

IMPORTANT: Consult an expert for the proper screws/bolts to use when attaching to various constructions. Screws provided **do not** attach to all wall construction types. Anchors are not required if brackets are installed in stud.

3

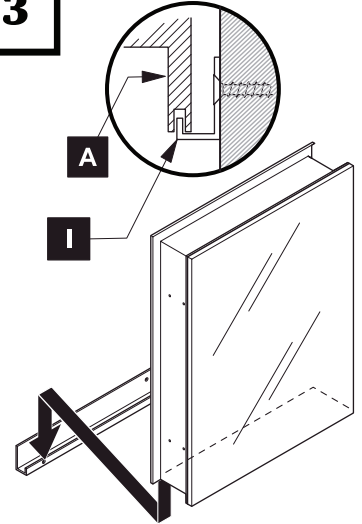

With assistance, rest the medicine cabinet on the bottom mounting bracket and hold it in place.

4

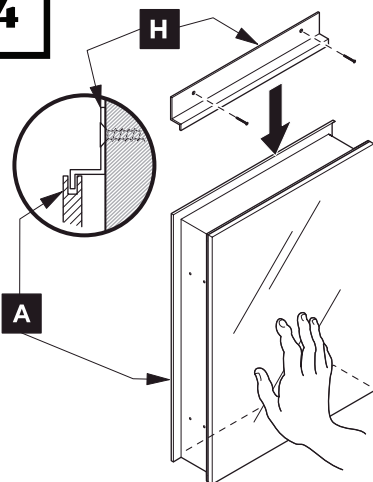

Hold the medicine cabinet (**A**) while it's placed on the bottom bracket, then secure by fitting the top bracket (**H**) on top of the medicine cabinet, and attach the top bracket (**H**) to the wall.

5

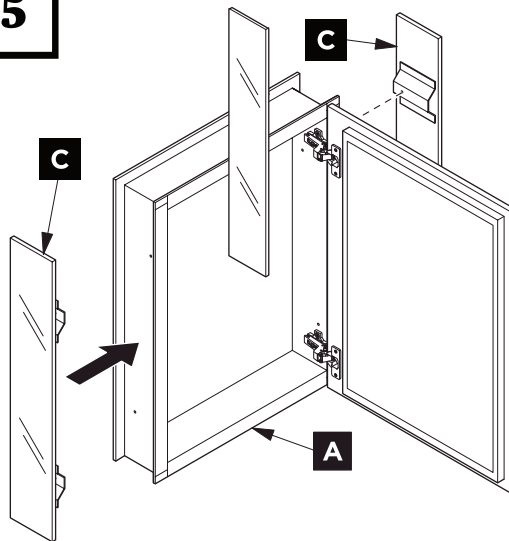

Align mirrored side panels (**C**) to each side of the medicine cabinet.

6

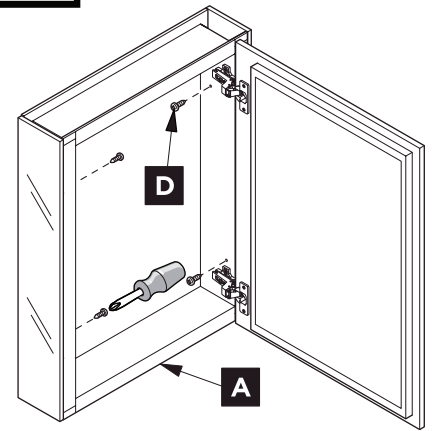

Attach mirrored side panels to the medicine cabinet using a screwdriver and provided screws (**D**).

7

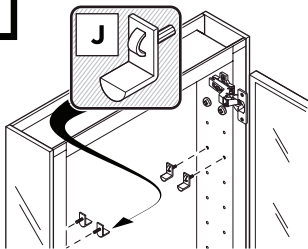

Push and twist the snap-in pins (**J**) into place.

8

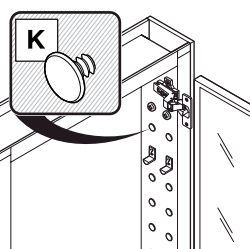

Fill remaining holes with the plugs (**K**).

9

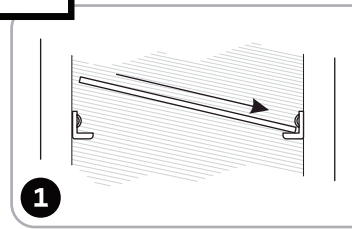

Push a side of the shelf (**E**) into left or right pins (**J**).

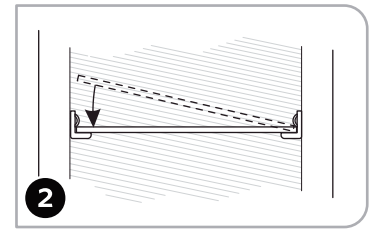

Snap the shelf (**E**) down into the opposite side.

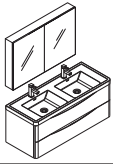

FVN9048-D SENZA INSTALLATION GUIDE



RECESS-MOUNT INSTALLATION

1

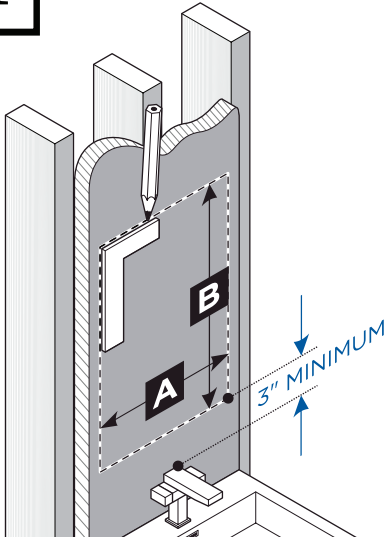

Draw the perimeter of the medicine cabinet on the wall.

2

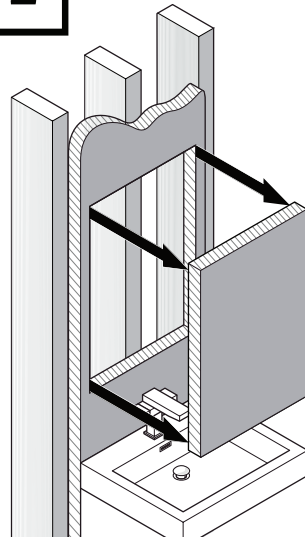

Place and hold the medicine cabinet in the cutout opening.

3

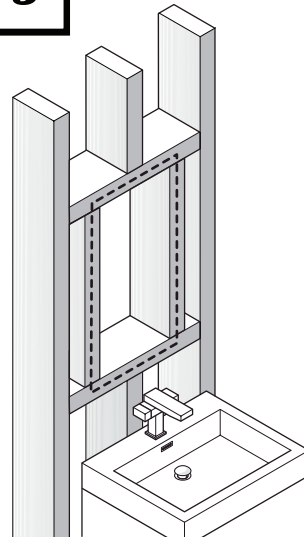

Frame the cutout opening.

4

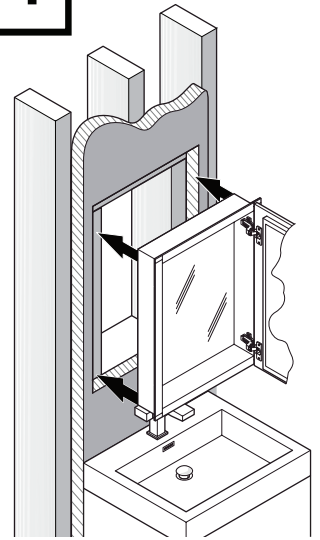

Cut the marked perimeter with appropriate tool.

ROUGH IN DIMENSIONS

Model SKU	Width A	Height B	Depth
FMC8058	19.5"	26"	5"
FMC8090	29.5"	26"	5"
FMC8010	39.5"	26"	5"

4 STEPS TO FRAME THE CUTOUT OPENING

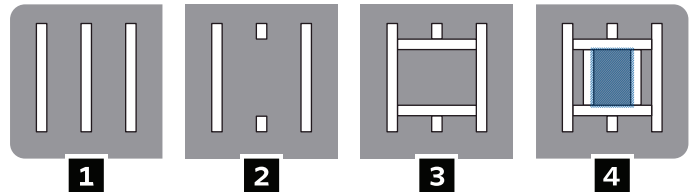

5

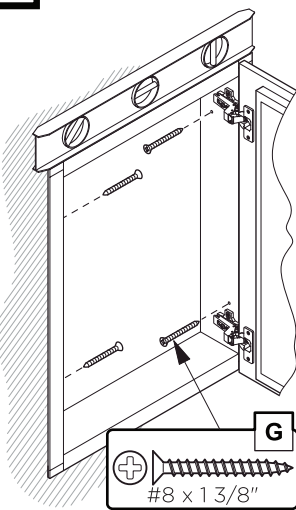

Level, then secure the medicine cabinet with the screws (**G**) through the mounting holes into the framing studs.

6

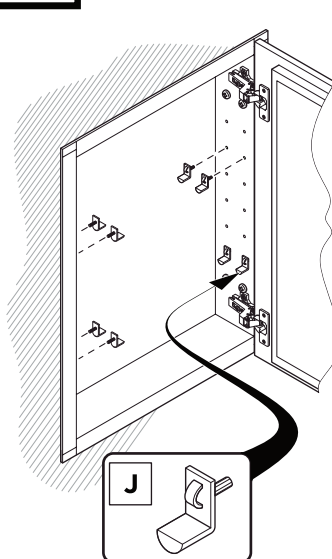

Choose the position for your shelves then push and twist the snap-in pins (**J**) into place.

7

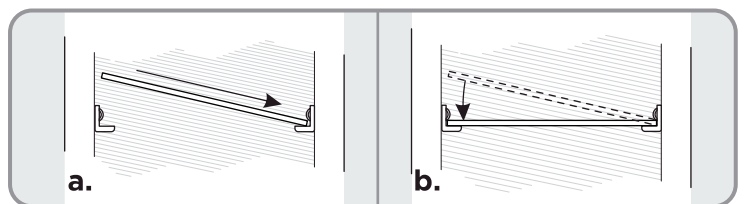

a. Push a side of the glass shelf (**C**) into left or right pins (**J**).

b. Snap the glass shelf (**C**) into the opposite side.

c. Fill remaining holes with the plugs (**K**).

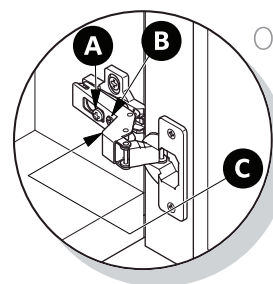
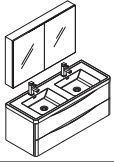

Illustration A.

OPTIONAL DOOR ADJUSTMENT:

- A** This screw allow you to adjust pitch side to side.
- B** This screw releases cabinet's door and allows up and down adjustment.
- C** This screw allow you to adjust the gap between doors.



FVN9048-D SENZA INSTALLATION GUIDE



CABINET INSTALLATION

1 Locate cabinet & mark location on the wall

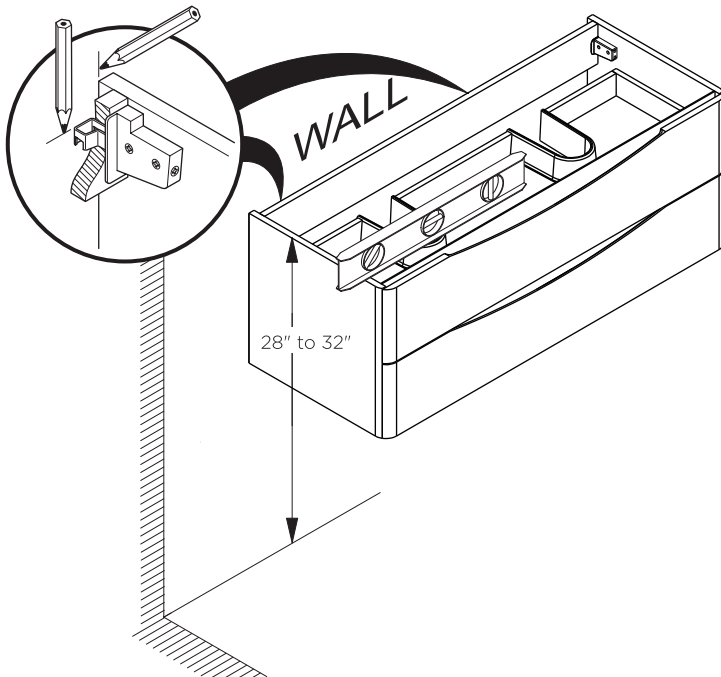

2 Install wall brackets

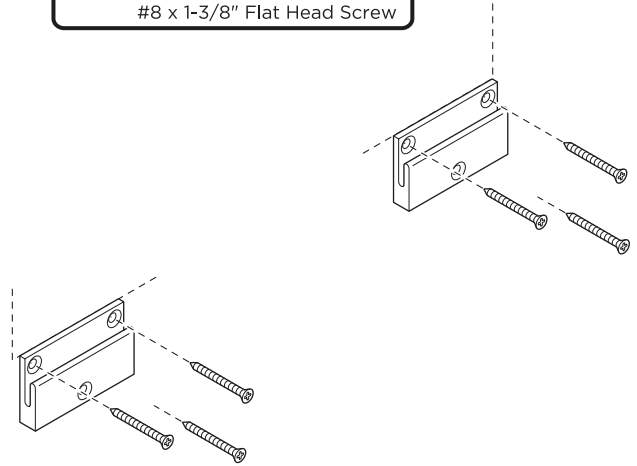
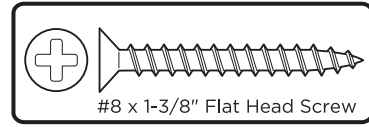

3 Install cabinet

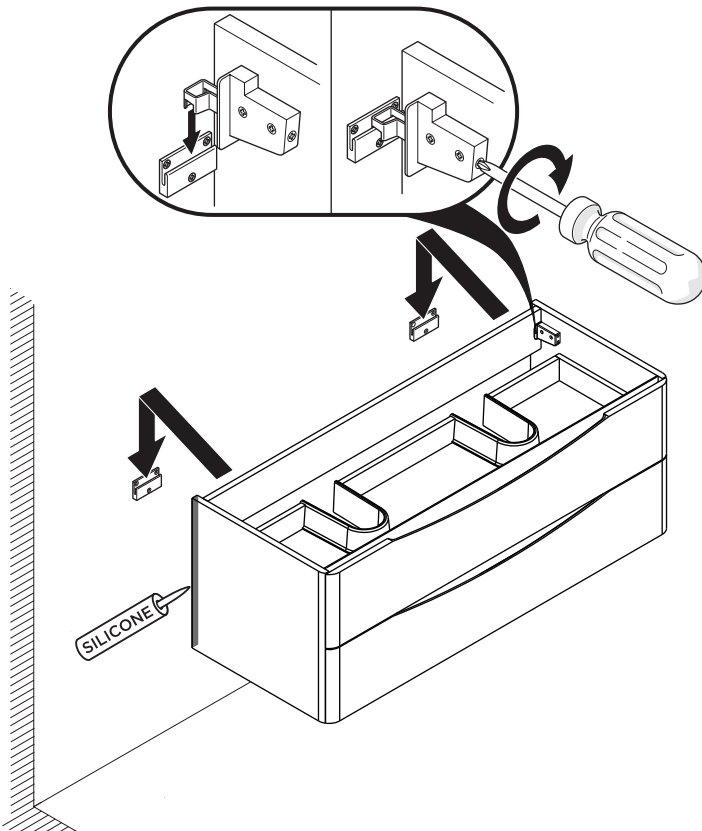

4 Apply a bead of silicone on the top of the cabinet and place sink on the cabinet

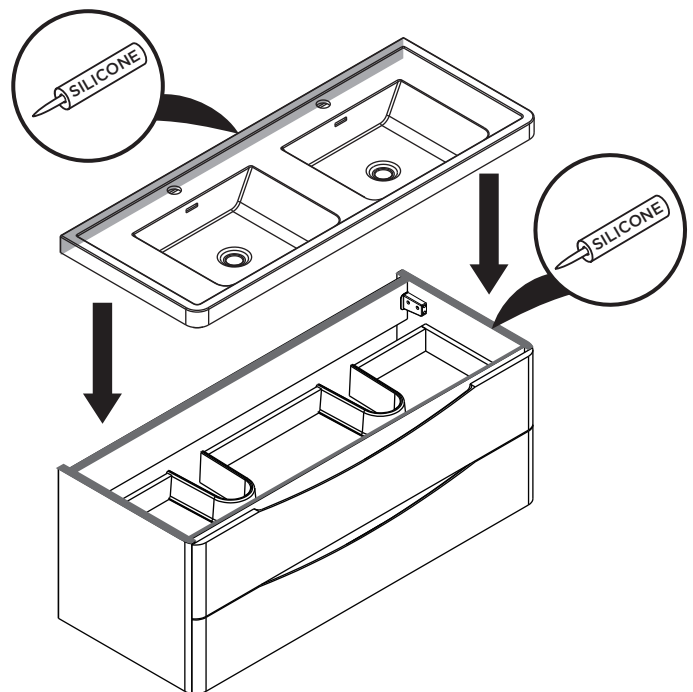

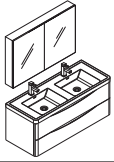

DRAWER REMOVAL & INSTALLATION

REMOVAL

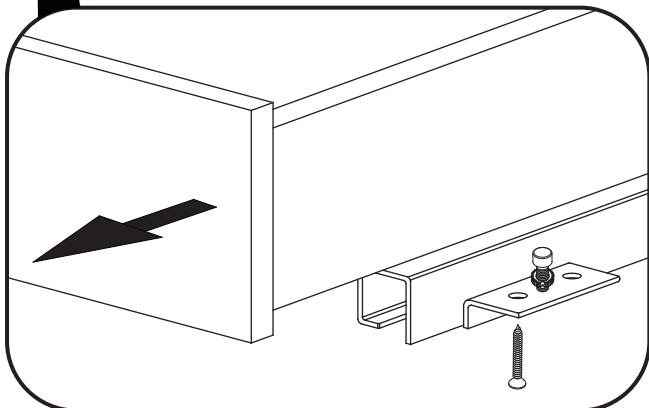
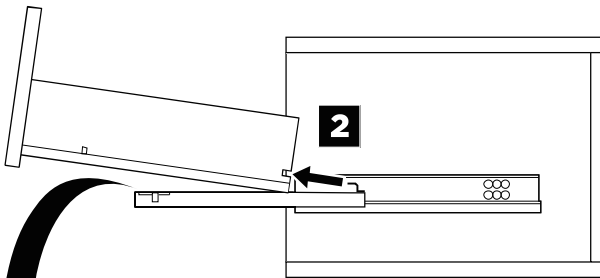
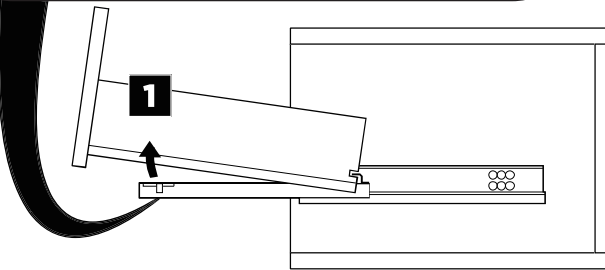
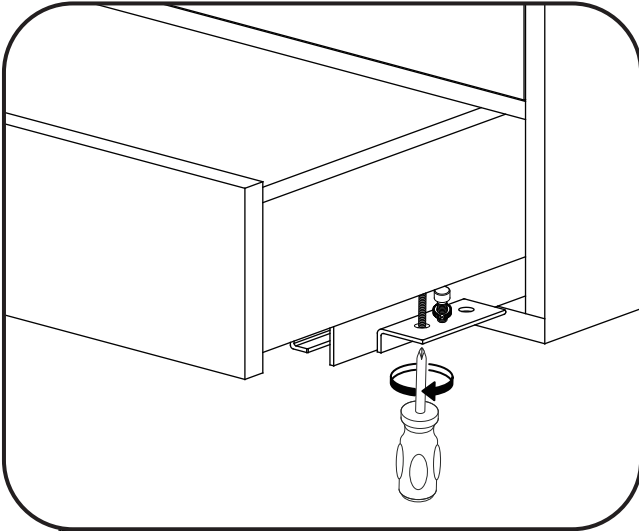

INSTALLATION

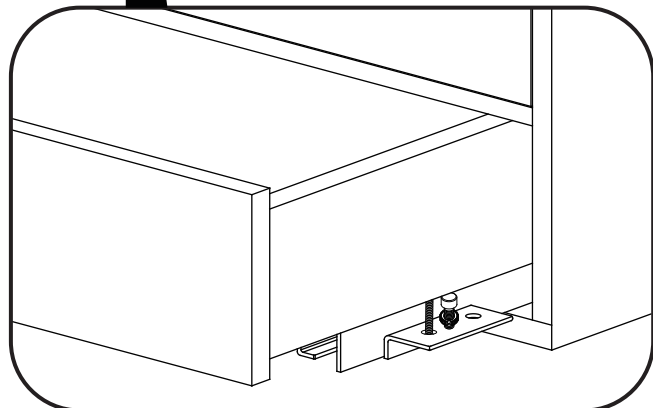
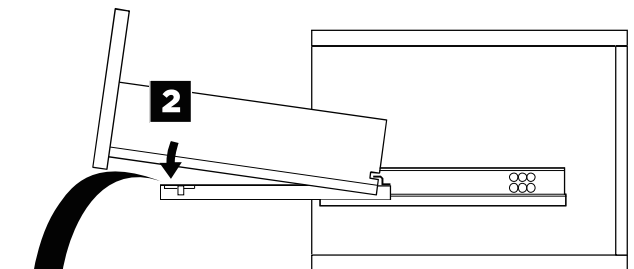
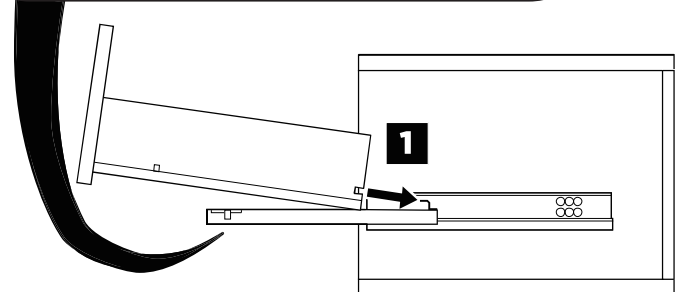
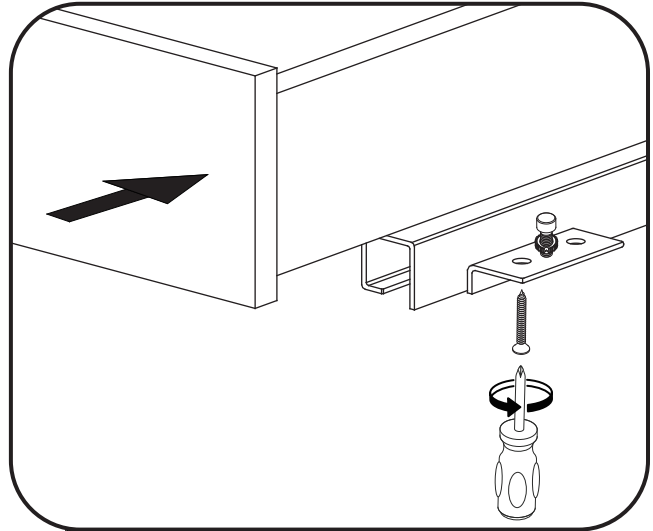

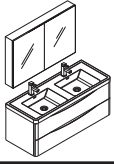

P-TRAP AND POP-UP INSTALLATION INSTRUCTIONS

NOTE:
Your item may appear slightly different from the illustration.

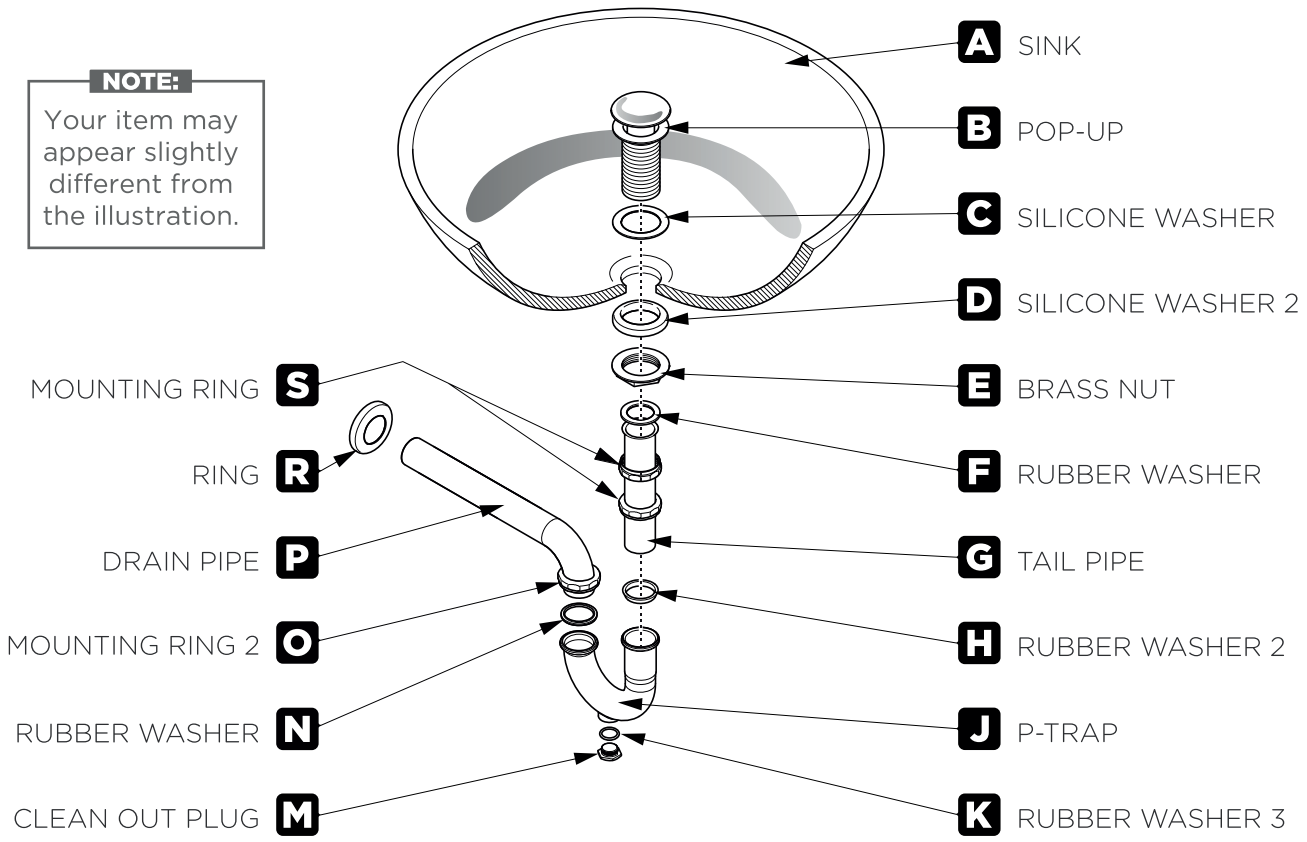

POP-UP INSTALLATION INSTRUCTIONS

FOR SINKS WITHOUT OVERFLOW

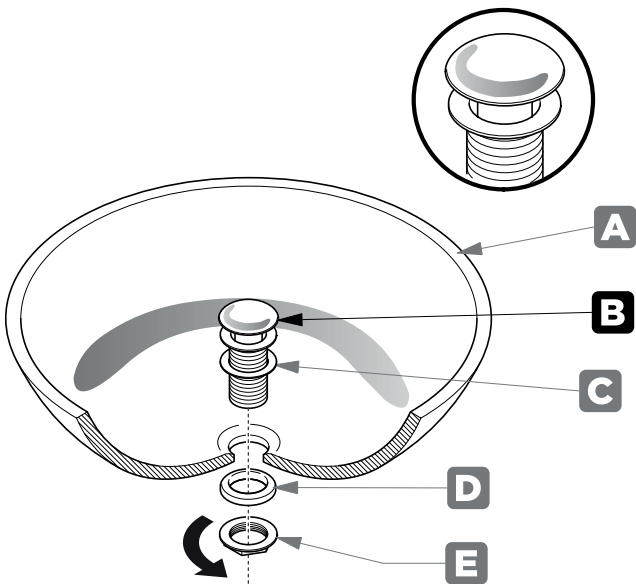

OR

FOR SINKS WITH OVERFLOW

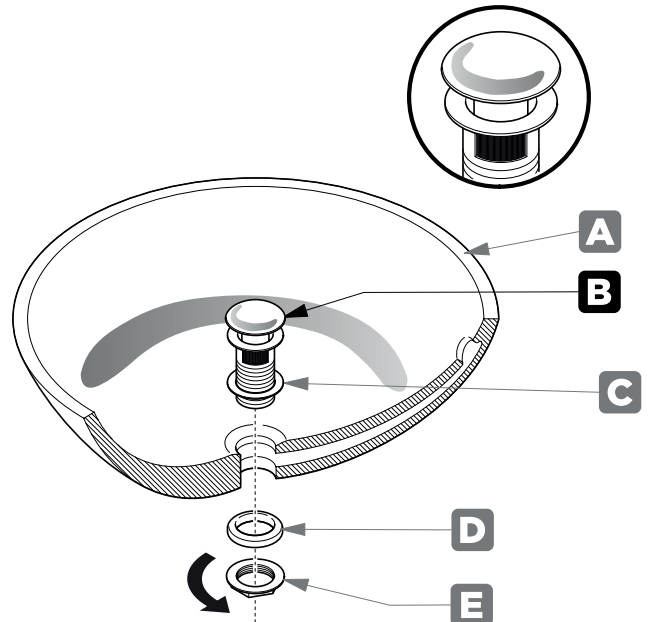

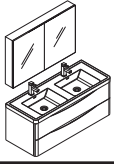

P-TRAP INSTALLATION

1 Install tail pipe (G)

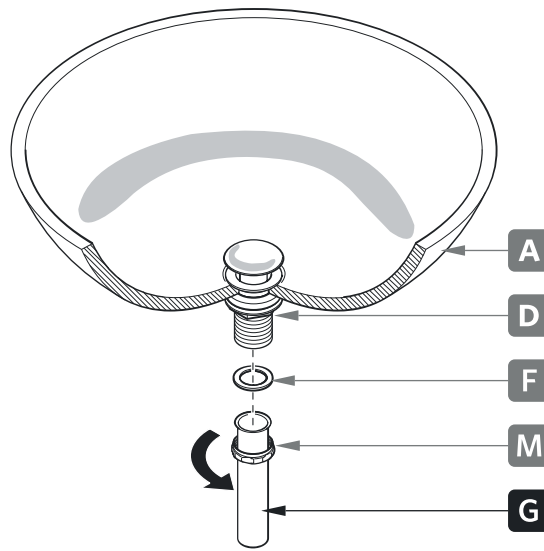

2 Install p-trap (J)

