

1512-MC24 24" Medicine Cabinet

SPECIFICATION SHEET

Features

- Materials: Poplar Solids
- Doors: 1*
- Hinges: Fully concealed
- Shelves: 3 (glass) (adjustable)
- Hardware: Brushed Nickel
- Mirror: 5/8" bevel
- Mounting: Cleat

Colors / Finish

1512-Polar White

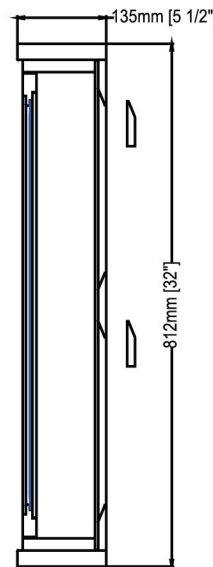
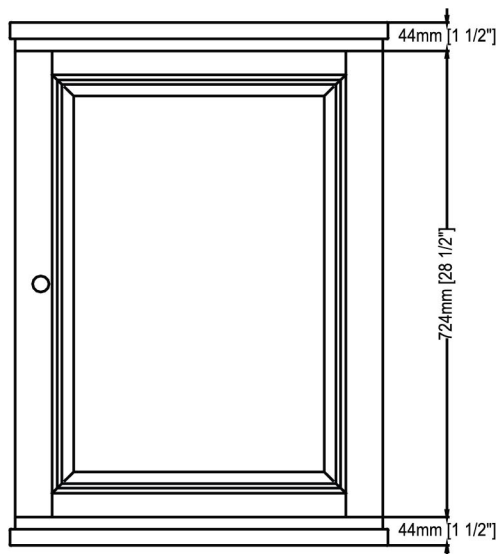
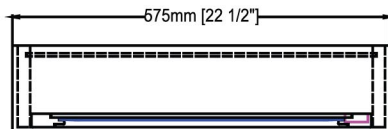
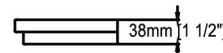
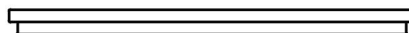
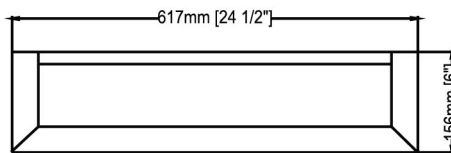
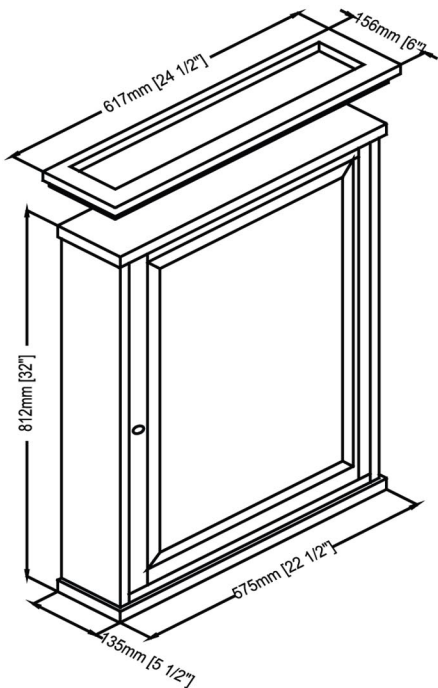

*Cabinet can be hung with door right or left. Crown is packed separately to be mounted at the jobsite.