

Dawn

Model No: ASU110L

Overall size:

$29\frac{3}{16}$ " X $20\frac{7}{8}$ " X $9\frac{7}{16}$ " (B), 7" (S)

FEATURES:

Type 304 stainless steel
 18 Gauge thickness
 Satin finish.

INSTALLATION

Undermount installation
 Supplied With Cutout
 template.

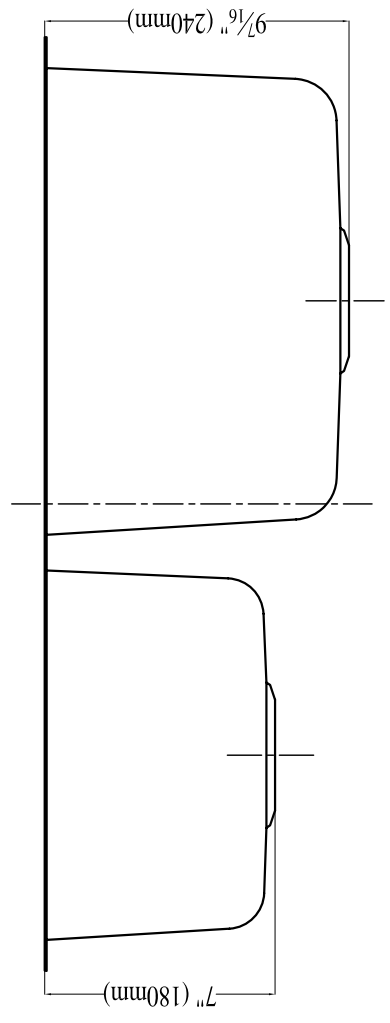

Dawn Kitchen & Bath Products, Inc.