

Quick Installation Instructions

Model: Acadia Shower Set

DSSAA01C (Chrome) • DSSAA04BN (Brushed Nickel)

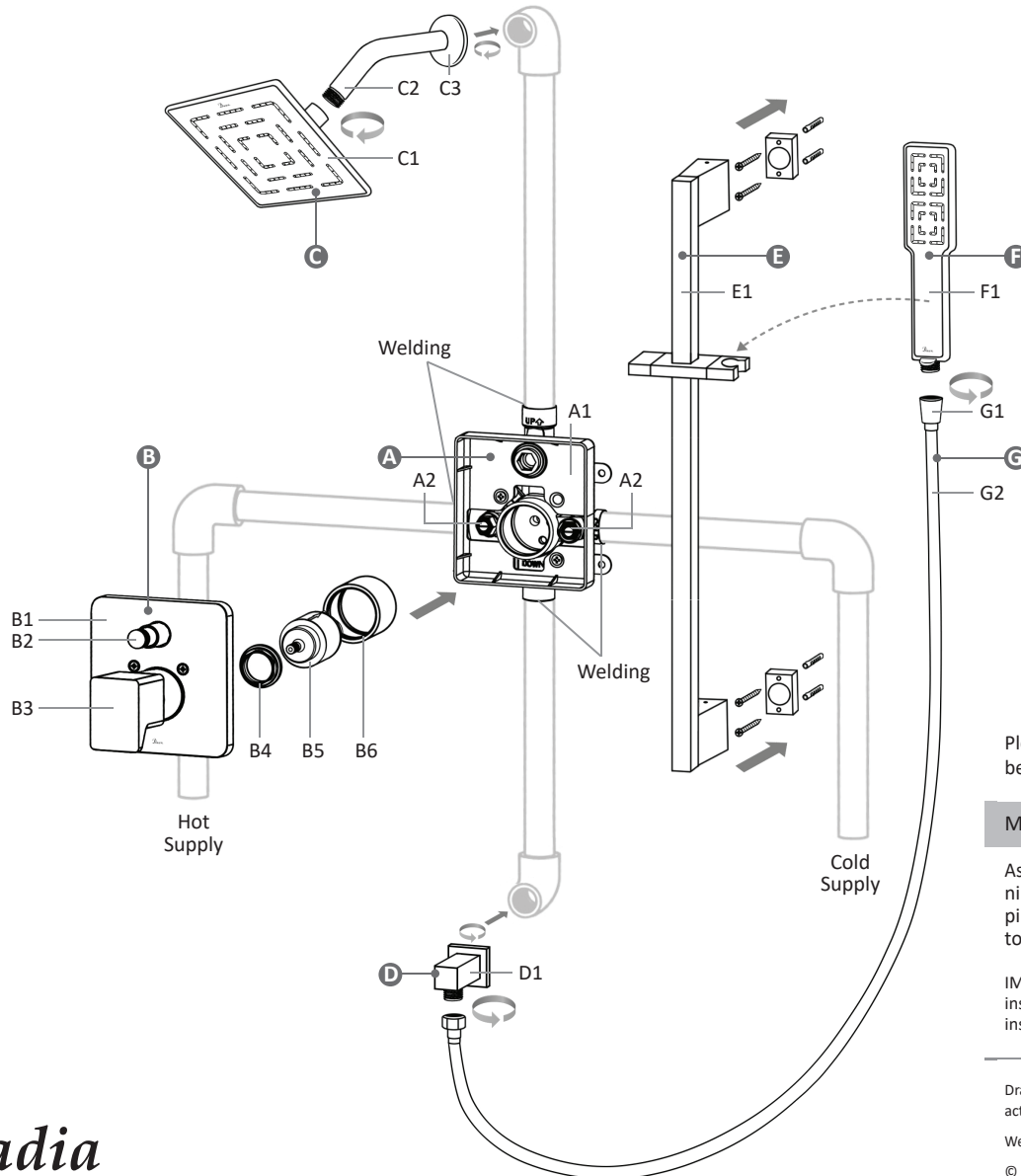

Please read all the instructions carefully before starting the installation.

Material & Tools:

Assorted screwdrivers, adjustable wrenches, nipple connector, safety glasses, pencil, pipe plugs, level, sealant tape, and other tools as needed.

IMPORTANT: Recommended for professional installers only. The installer is responsible for installing the product safely.

Drawings are for reference only. Please refer to the actual product for exact size, shape and parts.

We reserve the right to make any changes and corrections.

© 2017 Dawn Kitchen & Bath Products, Inc.

Acadia

Shower Set Includes:

- | | | | | | | |
|--|---|---|--|---|---|--|
| <p>A
D1267300
Diverter Valve *</p> <p>A1. Main Body & Plastic Guard (remove plastic guard after water flush)</p> <p>A2. Fixing Nuts
— Screws
— Socket Spanner</p> | <p>B
D0040701 (C/BN)
Diverter Trim *</p> <p>B1. Cover Plate</p> <p>B2. Diverter Button (switches between rainhead or handshower)</p> <p>B3. Handle</p> <p>B4. Cartridge Nut</p> <p>B5. Cartridge</p> <p>B6. Cartridge Cover
— Screws</p> | <p>C
HSS0920100-6 (C)
HSS0920400-6 (BN)
6" Rainhead</p> <p>C1. Main Body
— Filter
— Restrictor</p> <p>SRT010100 (C)
SRT010400 (BN)
6" Arm & Flange</p> <p>C2. 6" Arm</p> <p>C3. Flange</p> | <p>D
WCA050100 (C)
WCA050400 (BN)
Elbow</p> <p>D1. Main Body</p> <ul style="list-style-type: none"> • Nipple Connector (not included) is required to connect between elbow and water pipe | <p>E
R41010100 (C)
R41010400 (BN)
27" Slide Bar</p> <p>E1. Main Body
— Screws
— Screw Anchors
— Wall Brackets
— Alley Key</p> | <p>F
HS0810101 (C)
HS0810401 (BN)
Handshower</p> <p>F1. Main Body
— Filter
— Restrictor</p> | <p>G
HF0400160 (C)
HF0400460 (BN)
PVC Hose</p> <p>G1. Connectors (both ends)</p> <p>G2. Hose</p> |
|--|---|---|--|---|---|--|

* Please refer to the "Installation Instructions - Pressure Balancing Shower and Bath Valve/Trim" (included in this package) for complete step by step instructions regarding Valve/Trim installation.