

**XViu Furniture washbasin c-bonded with vanity wall-mounted # XV4616 E/N/O**

| < 39 3/8" Inch > |

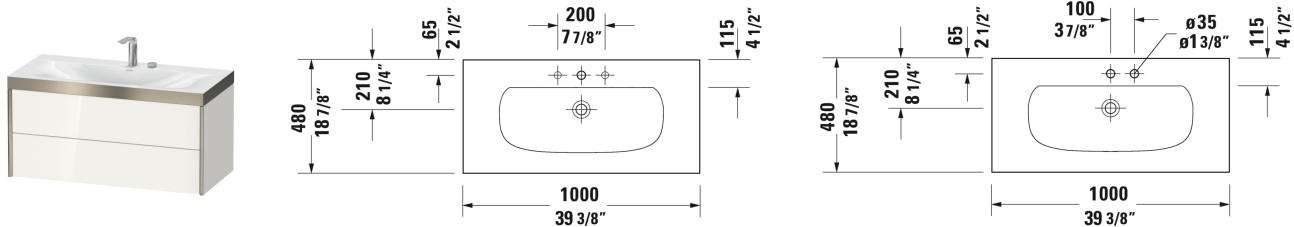

Furniture washbasin c-bonded with vanity wall-mounted	Dimension	Weight	Order number
2 drawers, upper drawer including cut-out for siphon and siphon cover, furniture washbasin Viu included, without overflow, with faucet deck, ceramic covered slotted waste included, space-saving siphon included			
<b>Colors</b>			
M07 Concrete Gray Matte (Decor) M09 Light Blue Matte (Decor) M11 Cashmere Oak M12 Brushed Oak (Real wood veneer) M13 American Walnut (Real wood veneer) M16 Black Oak M18 White Matte M21 Walnut Dark (Decor) M22 White High Gloss (Decor) M30 Natural Oak M31 Pine Silver (Decor) M35 Oak Terra M38 Dolomiti Gray High Gloss (Lacquer) M40 Black High Gloss (Lacquer) M43 Basalt Matte (Decor) M47 Stone Blue High Gloss (Lacquer) M49 Graphite Matt (Decor) M51 Pine Terra (Decor) M52 European Oak (Decor) M53 Chestnut Dark (Decor) M69 Brushed Walnut (Real wood veneer) M71 Mediterranean Oak (Real wood veneer) M72 Brushed Dark Oak (Real wood veneer) M75 Linen (Decor) M79 Natural Walnut (Decor) M80 Graphite Super Matte M85 White High Gloss (Lacquer) M86 Cappuccino High Gloss (Lacquer) M89 Flannel Gray High Gloss (Lacquer) M90 Flannel Gray Satin Matte (Lacquer) M91 Taupe Matte (Decor)			
<b>Variant</b>			
	39 3/8" x 18 7/8" Inch		XV4616 E/N/O
<b>Infobox</b>			
This product is only available in the combination with the ceramic series Viu and the furniture series XViu, The vanity unit is permanently bonded to the washbasin and delivered together as one unit, Washbasin not available with WonderGliss, Ceramic is additionally secured to the wall via a separate enclosed mounting rail. Complete hardware set is included with delivery. Please follow the mounting instructions, Required specification for ordering:., - Finish of three-sided c-bonded frame, in color of profile = 12. Position P, in color of body = 12. Position C, see page XXX			

All drawings contain the necessary measurements which are subject to standard tolerances. They are stated in inch & mm and are non-binding. Exact measurements, in particular for customized installation scenarios, can only be taken from the finished ceramic piece.