

**Brioso Furniture washbasin c-bonded with vanity floorstanding**  
**# BR4700 N/O**

| < 23 5/8" Inch > |

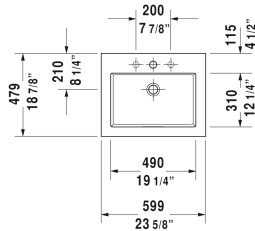

Furniture washbasin c-bonded with vanity floorstanding	Dimension	Weight	Order number
2 pull-out compartments, without overflow, with faucet deck, ceramic covered slotted waste included, space-saving siphon included			
<b>Colors</b>			
M07 Concrete Gray Matte (Decor) M16 Black Oak M18 White Matte M21 Walnut Dark (Decor) M22 White High Gloss (Decor) M30 Natural Oak M35 Oak Terra M43 Basalt Matte (Decor) M49 Graphite Matt (Decor) M52 European Oak (Decor) M53 Chestnut Dark (Decor) M75 Linen (Decor) M79 Natural Walnut (Decor) M91 Taupe Matte (Decor)			
<b>Variant</b>			
furniture washbasin Vero Air included	23 5/8" x 18 7/8" Inch		BR4700 N/O
<b>Infobox</b>			
This product is only available in the combination with ceramic series Vero Air and furniture series Brioso, The vanity unit is permanently bonded to the washbasin and delivered together as one unit, Washbasin not available with WonderGliss, Ceramic is additionally secured to the wall via a separate enclosed mounting rail. Complete hardware set is included with delivery. Please follow the mounting instructions, Dividing system optional for self-install # UV 9845, Floorstanding vanities require wall fixation as per installation instructions, Legs # UV 9993, UV 9994 or # BR 9793, BR 9794 are mandatory for installation and required to be ordered as a separate line item, Required specification for ordering:			
<b>Suitable products</b>			
Dividing system self-install dividing system including lid, Black Diamond, for vanity unit, 4 1/2" x 12 5/8" Inch	4 1/2" x 12 5/8" Inch		UV9845

*All drawings contain the necessary measurements which are subject to standard tolerances. They are stated in inch & mm and are non-binding. Exact measurements, in particular for customized installation scenarios, can only be taken from the finished ceramic piece.*