

## Brioso Furniture washbasin c-bonded with vanity wall mounted # BR4605 N/O

| < 600 mm > |

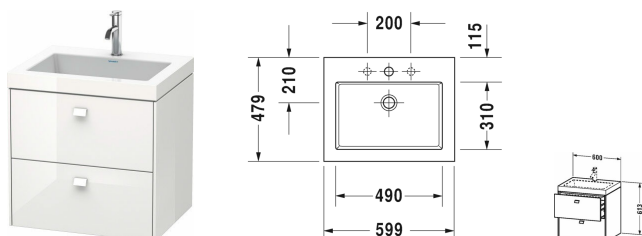

Furniture washbasin c-bonded with vanity wall mounted	Dimension	Weight	Order number
2 drawers, upper drawer including cut-out for siphon and siphon cover, without overflow, with tap platform, ceramic covered slotted waste included, space saving siphon included			
<b>Colors</b>			
M07 Concrete Grey Matt Decor M16 Black Oak M18 White Matt Decor M21 Walnut Dark Decor M22 White High Gloss Decor M30 Natural Oak M35 Oak Terra M43 Basalt Matt Decor M49 Graphite Matt Decor M53 Chestnut Dark Decor M75 Linen Decor M79 Natural Walnut Decor M91 Taupe Matt Decor			
<b>Variant</b>			
furniture washbasin Vero Air included	600 x 480 mm		BR4605 N/O
<b>Infobox</b>			
Price, please see page XXX, This product is only available in the combination with the ceramic series Vero Air and the furniture series Brioso, The c-bonded frame is permanently bonded to the washbasin and is delivered together with the vanity unit as one unit, Washbasin not available in WonderGliss, Ceramic is attached to the wall via a separate enclosed mounting rail, hanger bolts for the mounting rail are not included in the delivery, follow mounting instructions, Dividing system optional, lay-in component # UV 9845 , Description of furniture washbasin c-bonded on page XXX, Balance to terms of furniture, Please specify when ordering: , - tap hole (N = without tap hole: •, 0 = with one tap hole: p) , - Handle variant, please see page XXX			
<b>Suitable products</b>			
Dividing system Individual and retrofittable dividing system with cover, Black diamond, for vanity unit, 115 x 320 mm	115 x 320 mm		UV9845

All drawings contain the necessary measurements which are subject to standard tolerances. They are stated in mm and are non-binding. Exact measurements, in particular for customised installation scenarios, can only be taken from the finished piece.