

Vero Washbasin ground # 0454600025 / 0454600027

< 23 5/8" Inch >

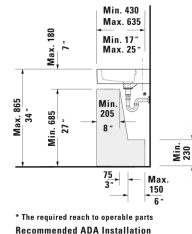

* The required reach to operable parts
Recommended ADA Installation

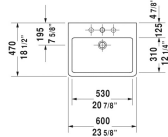
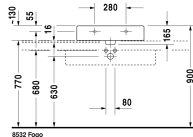
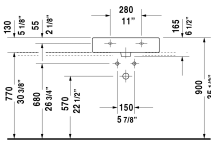

Washbasin ground	Dimension	Weight	Order number
with faucet deck, hardware included, wall-mounted, cUPC® listed*, 23 5/8" Inch			
Colors			
00 White			
Variant			
●●● with overflow	23 5/8" x 18 1/4" Inch	39.5 lb	0454600025
● with overflow	23 5/8" x 18 1/4" Inch	39.5 lb	0454600027
Infobox			
* Complies with following standards: ASME A112.19.2/CSA B45.1, Washbasin is not ADA compliant in combination with pedestal, siphon cover or metal console			
Sanitary ceramics with the special WonderGliss surface finish will remain clean and attractive-looking for a long time to come. When ordering WonderGliss please add a "1" as eleventh digit to the model number.			
Accessory for ceramics			
Push button drain assembly for washbasins with overflow	2" Inch	0.8 lb	005052
Design Siphon		3.3 lb	005036
Suitable products			
Vanity unit for console Compact 2 drawers, upper drawer including cut-out for siphon and siphon cover, 31 1/2" x 17 5/8" Inch	31 1/2" x 17 5/8" Inch		VE5607
Vanity unit for console Compact 2 drawers, upper drawer including cut-out for siphon and siphon cover, 35 3/8" x 17 5/8" Inch	35 3/8" x 17 5/8" Inch		VE5608

Vero Washbasin ground  # 0454600025 / 0454600027

| < 23 5/8" Inch > |

Vanity unit for console Compact 2 drawers, upper drawer including cut-out for siphon and siphon cover, 39 3/8" x 17 5/8" Inch	39 3/8" x 17 5/8" Inch	VE5609
Vanity unit for console Compact 2 drawers, upper drawer including cut-out for siphon and siphon cover, 27 1/2" x 17 5/8" Inch	27 1/2" x 17 5/8" Inch	VE5606
Vanity unit for console 2 drawers, upper drawer including cut-out for siphon and siphon cover, 27 1/2" x 20 3/8" Inch	27 1/2" x 20 3/8" Inch	VE5616
Vanity unit for console 2 drawers, upper drawer including cut-out for siphon and siphon cover, 35 3/8" x 20 3/8" Inch	35 3/8" x 20 3/8" Inch	VE5618
Vanity unit for console 2 drawers, upper drawer including cut-out for siphon and siphon cover, 39 3/8" x 20 3/8" Inch	39 3/8" x 20 3/8" Inch	VE5619

All drawings contain the necessary measurements which are subject to standard tolerances. They are stated in inch & mm and are non-binding. Exact measurements, in particular for customized installation scenarios, can only be taken from the finished ceramic piece.