



Bathtub - CL.1

Showerhead - polished chrome

Article number: 28 504 670-00 0010

- 7-1/8"-8-1/4" Projection
- Ball-joint pivotable through 30°
- Standard spray mode
- Descaling system
- Ø 3-7/8"
- Flange 2-3/8" x 2-3/8"
- 1/2" connection
- Water flow rate limited to max. 1.8 gpm

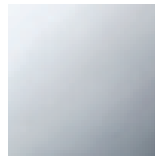

polished chrome

Dimensional drawing

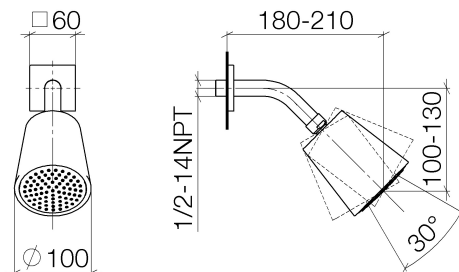

All dimensions in mm / inch = mm x 0,0394



Bathtub - CL.1
Showerhead - polished chrome
Article number: 28 504 670-00 0010

Flow rate chart

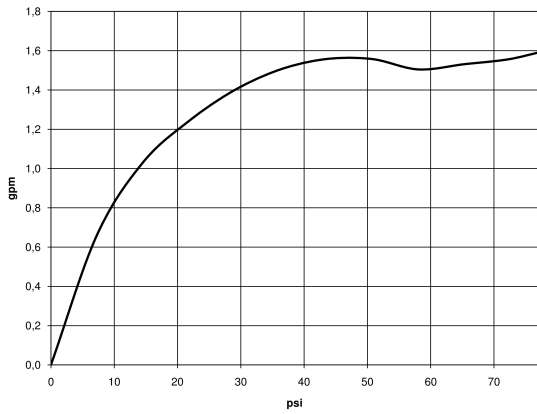



Bathtub - CL.1
Showerhead - polished chrome
Article number: 28 504 670-00 0010

Other surface finishes



platinum matte
28 504 670-06 0010



platinum
28 504 670-08



platinum
28 504 670-08 0010

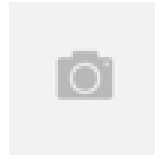

Brushed Durabrass
28 504 670-28 0010



Dark Platinum matte
28 504 670-99 0010

More custom finish options are available via special production (xTra Service). Please see our finish matrix for availability and pricing or contact a Dornbracht representative.

Spare parts list

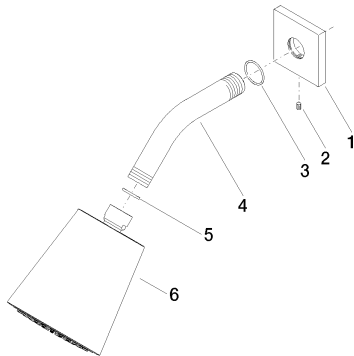

Number	Item Number	Designation	Number of units
2	09 31 11 048 90	pin	2
3	09 14 10 026 90	seal	1
4	09 11 03 011-00	connection	1
5	09 14 20 002 90	seal	1
6	90 12 05 054 01-00	shower	1