



SEMI-CAST GRID PATENT OVERFLOW PLUGS TECHNICAL SPECIFICATION

Job Name _____ Item # _____
 Location _____
 Engineer _____ Contractor _____
 PO # _____ Tag _____
 Representative _____

SPECIFICATIONS

Dearborn Two Piece Patent Overflow Plug is designed for use in tubular drain applications with lavatory sinks. Two piece design allows overflow to flow to sink drain. Available in 5", 6" 8" or 12" lengths.

DESCRIPTION

- Chrome Finish
- 20 Gauge Brass
- Two Piece Assembly

APPROVALS AND LISTINGS



PRODUCT SELECTOR

SEMI-CAST GRID PATENT OVERFLOW PLUGS				
✓	Product Number	Size	Description	Carton Quantity
	760-1	1-1/4" x 6"	Semi-Cast Grid Patent Overflow Plug w/ 1-1/4" x 6" - 17 Ga. Tailpiece	25
	7760-1	1-1/4" x 6"	Semi-Cast Grid Patent Overflow Plug w/ 1-1/4" x 6" - 17 Ga. Tailpiece, White Box	25
	761-1	1-1/2" x 6"	Semi-Cast Grid Patent Overflow Plug w/ 1-1/2" x 6" - 17 Ga. Tailpiece	25

Data is subject to manufacturing tolerances.

DIMENSIONS

[A]:	Diameter A	2.2"	[C]:	Height C	2.8"
[B]:	Diameter B	See Chart A.1	[D]:	Height D	6"

A.1 - LENGTHS		
	1-1/4" x 6 Tailpiece	1-1/2" x 6 Tailpiece
Diameter B:	1-1/4"	1-1/2"

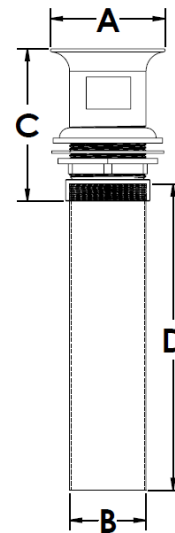

Access BIM/Revit content through www.Oatey.com