



SINK TRAPS WITH CLEANOUT & EXTENSION COVER TUBE TECHNICAL SPECIFICATION

Job Name _____	Item # _____
Location _____	
Engineer _____	Contractor _____
PO # _____	Tag _____
Representative _____	

SPECIFICATIONS

Dearborn Sink Trap with Cleanout & Extension Cover Tube is designed for use in tubular drain applications. Cleanout plug provides convenient access to drain trap.

DESCRIPTION

- Chrome Finish
- 17 Gauge Brass
- Sink Trap with Cleanout & Extension Cover Tube
 - (1) Metal Flange
 - (1) Sink J-Bend with Ground Joint Flange
 - (1) Chrome Plated Cover Tube
 - (1) Schedule 40 PVC Adapter
 - (1) Cleanout Plug
 - (1) Fiber Cleanout Washer
 - (1) Brass Nut
 - (1) Rubber Washer
 - (1) Polyethylene Reducing Washer



APPROVALS AND LISTINGS



DIMENSIONS

[A]:	Inlet Size	1.5"	[F]:	Approximate Slip	2.6"
[B]:	Cover Tube OD	2"	[G]:	Approximate Seal	1.8"
[C]:	Length C	3.25"	[H]:	Approximate Height H	5.9"
[D]:	Length D	1.4"	[I]:	Flange Diameter	2.95"
[E]:	Length E	6"	[J]:	Flange Depth	1.44"

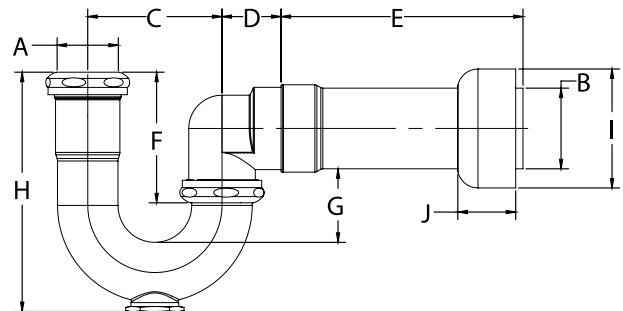

PRODUCT SELECTOR

SINK TRAPS WITH CLEANOUT & EXTENSION COVER TUBE				
✓	Product Number	Size	Description	Carton Quantity
	732GPBN-6-1	1-1/2" x 1-1/4"	Sink Trap w/ Cleanout, Schedule 40 PVC Adapter, Ground Joint, Cover Tube & Escutcheon & Brass Nuts	5

Data is subject to manufacturing tolerances.

Access BIM/Revit content through www.oatey.com