



California Faucets®

# Morro Bay™

## SINGLE HOLE LAVATORY FAUCET

CF-7701-1

### Features

- 4-7/8" spout center to center
- Single handle operation cartridge with ceramic disc
- Flexible braided hoses for ease of installation
- $\phi$  1-1/4" all brass touch style pop up drain assembly
- Flush mount aerator insert
- 1.2 gpm (4.5 L/min) max flow rate
- All brass construction
- Over 30 finishes including 15 PVD finishes

### Codes/Standards

Product meets or exceeds the following:

- ASME A112.18.1/CSA B125.1
- NSF/ANSI 61 & NSF/ANSI 372
- CEC / DOE
- EPA WaterSense High Efficiency Lavatory
- Commonwealth of MA
- ADA compliant

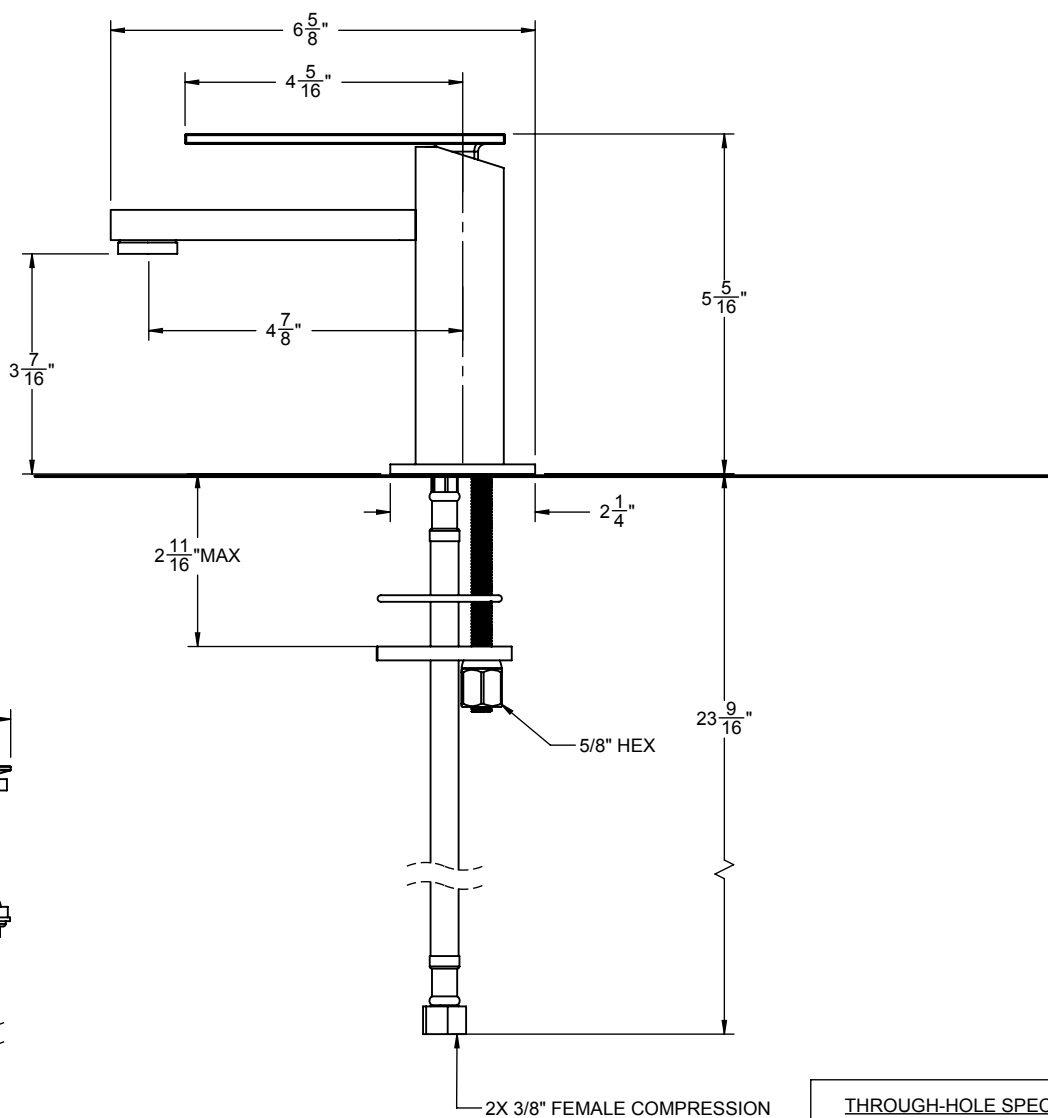

#### THROUGH-HOLE SPECIFICATIONS

	MIN	RECOMMENDED
SPOUT:	$\phi$ 1-1/4"	$\phi$ 1-3/8"
DRAIN:	$\phi$ 1-1/2"	$\phi$ 1-3/4"