



California Faucets®

DELUXE DECK MOUNT "TELEPHONE" HANDSHOWER AND TUB FILLER

Balboa™

Features

- All brass construction
- Over 28 finishes including 13 PVD finishes
- No additional wall or trap stabilizer required
- Tub filler maximum flow rate: 10 gpm (37.9 L/min) at 60 psi
- Handshower flow rate: 2.0 gpm (7.6 L/min) or 1.8 gpm (6.8 L/min)
- 1/4 turn ceramic cartridges
- Replace .FR with desired max flow rate:
 - 1508-D-XX.13M.20 for 2.0 gpm
 - 1508-D-XX.13M.18 for 1.8 gpm
 - 1508-D-XX.20 for 2.0 gpm
 - 1508-D-XX.18 for 1.8 gpm

1508-D-XX.13M.20
 1508-D-XX.13M.18
 1508-D-XX.20
 1508-D-XX.18

Codes/Standards

- Product meets or exceeds the following:
- ASME A112.18.1/CSA B125.1
 - CEC (1.8 gpm) / DOE (2.0 & 1.8 gpm)
 - Commonwealth of MA
 - EPA WaterSense (2.0 gpm)
 - ADA compliant (with lever handles)
 - Local codes may require installation of an upstream tempering valve



1508-D-47.FR SHOWN



XX= DENOTES HANDLE SERIES

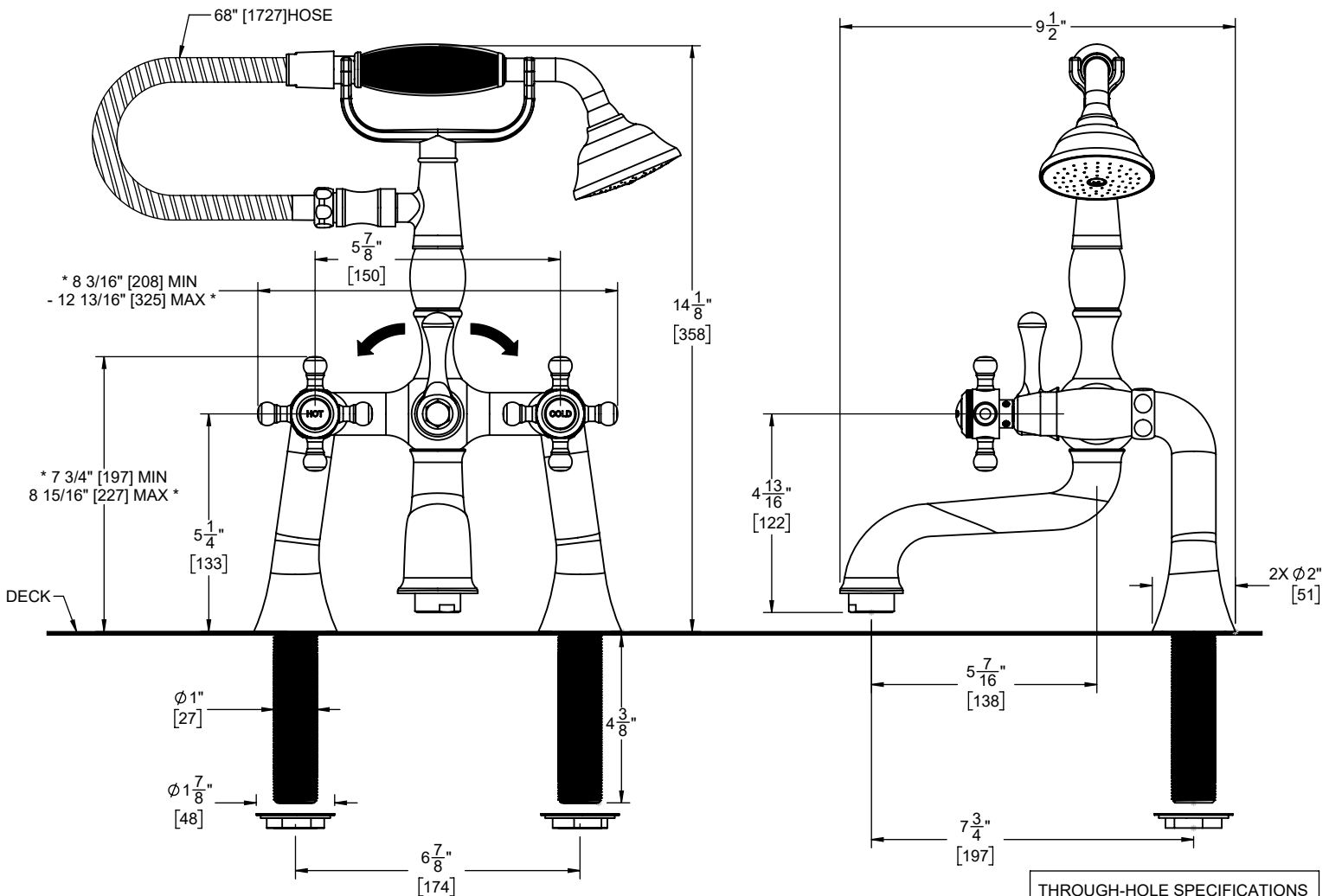

THROUGH-HOLE SPECIFICATIONS		
MIN	RECOMMENDED	MAX
Ø 1" [25]	Ø 1-1/8" [29]	Ø 1-1/2" [38]

* = DIMENSION VARIES BASED ON HANDLE SERIES
 SPECIFICATIONS SUBJECT TO CHANGE WITHOUT NOTICE

ALL DIMENSIONS SHOWN TO NEAREST 1/16"
 [ALL DIMENSIONS SHOWN TO NEAREST 1MM]