



California Faucets®

Shower Arm

TRADITIONAL & CONTEMPORARY

Features

- Available in 28 finishes including 13 PVD finishes
- All brass construction
- 1/2" FIP inlet via quick connect
- 1/2" MIP outlet
- 20" wall to center
- 16-5/16" overall height
- Secure quick connect prevents rotation of arm
- Supports showerhead weight of 14 LBS. max
- Includes all mounting hardware

Codes/Standards Applicable

Meets or exceeds the following at date of manufacture:

- None applicable

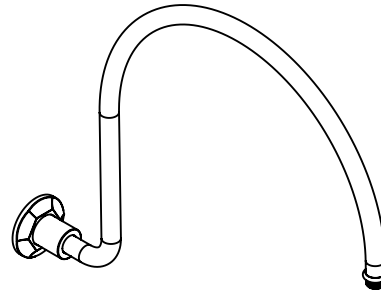

9107-47 SHOWN

9107-47
9107-48
9107-60
9107-65
9107-77

SHOWER ARM	DIM. A	DIM. B
9107-47	17 ¹¹ / ₁₆ " [449mm]	Ø 2 ¹³ / ₁₆ " [71mm]
9107-48	17 ¹¹ / ₁₆ " [449mm]	Ø 2 ³ / ₄ " [70mm]
9107-60	17 ¹¹ / ₁₆ " [449mm]	Ø 2 ¹³ / ₁₆ " [71mm]
9107-65	17 ⁵ / ₈ " [448mm]	Ø 2 ⁵ / ₈ " [67mm]
9107-77	17 ⁵ / ₈ " [448mm]	2 ⁵ / ₈ " SQ. [67mm]

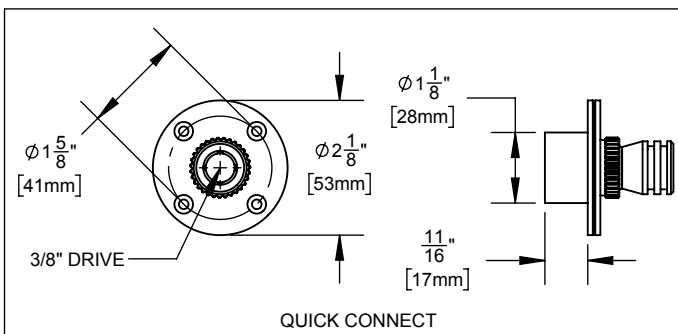
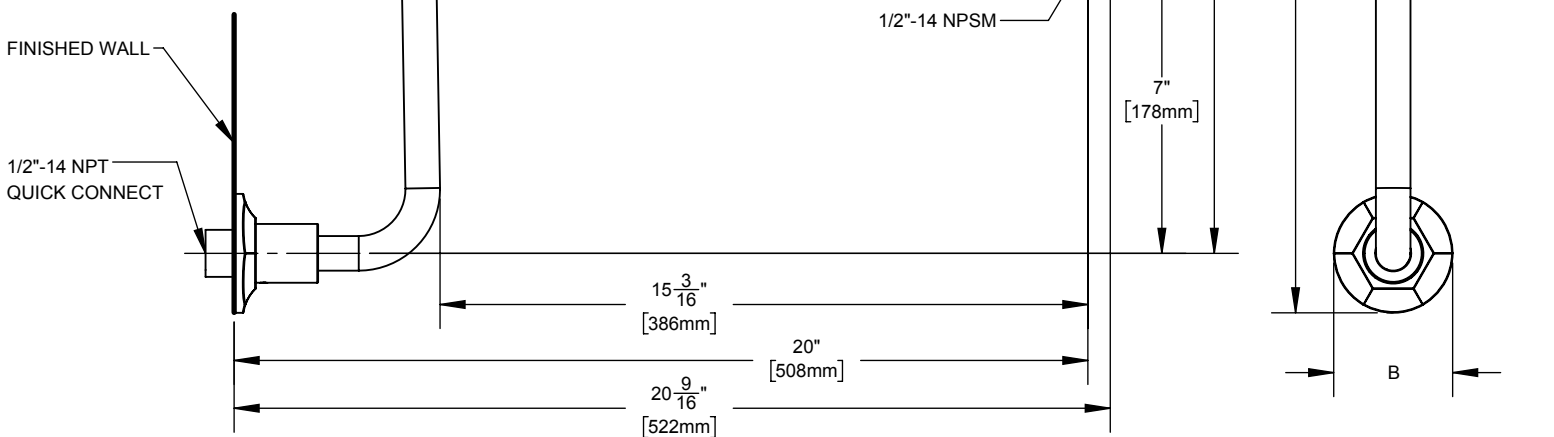

- (4X) - #6 X 1-1/2" PHILLIPS HEAD SCREW
- (4X) - ANCHOR, FINNED

SPECIFICATIONS SUBJECT TO CHANGE WITHOUT NOTICE

ALL DIMENSIONS SHOWN TO NEAREST 1/16"
[DIMENSIONS SHOWN TO NEAREST 1mm]