



California Faucets®

Balboa™

DELUXE WALL MOUNT "TELEPHONE" HAND SHOWER & TUB FILLER

Features

- All brass construction
- Over 28 finishes including 13 PVD finishes
- Tub filler maximum flow rate: 10 gpm (37.9 L/min) at 60 psi
- Handshower flow rate: 2.0 gpm (7.6 L/min) or 1.8 gpm (6.8 L/min)
- 1/4 turn ceramic disc cartridges
- Replace .FR with desired max flow rate:
 - 1508-D-XX.13M.20 for 2.0 gpm
 - 1508-D-XX.13M.18 for 1.8 gpm
 - 1508-D-XX.20 for 2.0 gpm
 - 1508-D-XX.18 for 1.8 gpm

Codes/Standards

Product meets or exceeds the following:

- ASME A112.18.1/CSA B125.1
- CEC (1.8 gpm) / DOE (2.0 & 1.8 gpm)
- Commonwealth of MA
- EPA WaterSense (2.0 gpm)
- ADA compliant (with lever handles)
- Local codes may require installation of an upstream tempering valve



1506-D-47.FR SHOWN

1506-D-XX.13M.20
1506-D-XX.13M.18
1506-D-XX.20
1506-D-XX.18



XX = DENOTES HANDLE STYLE

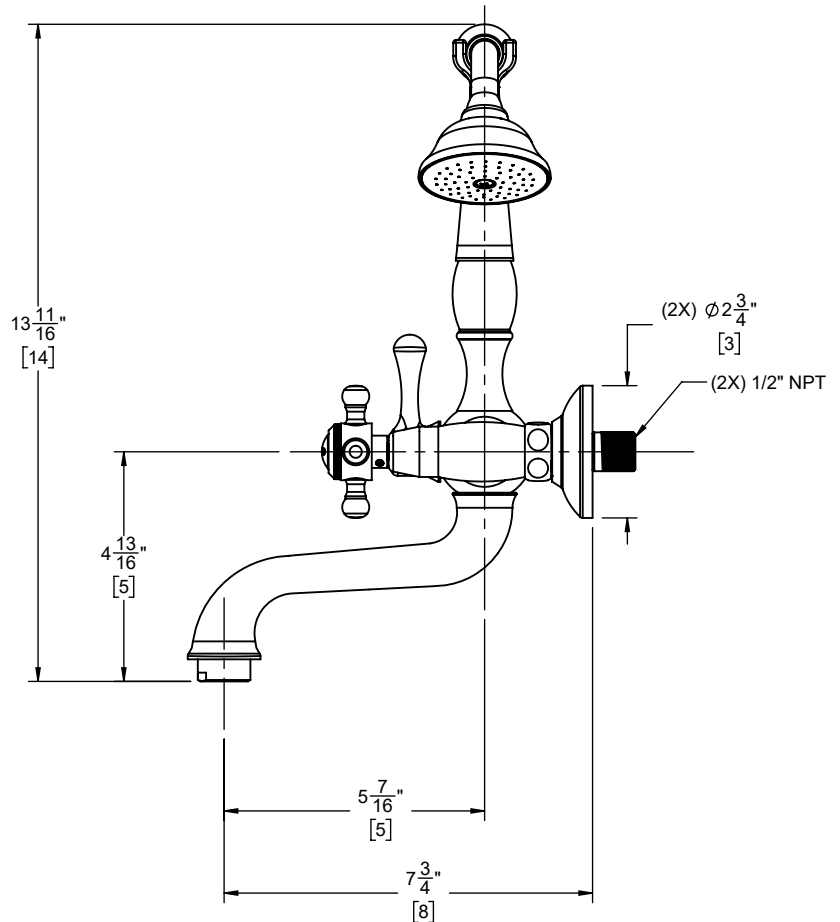
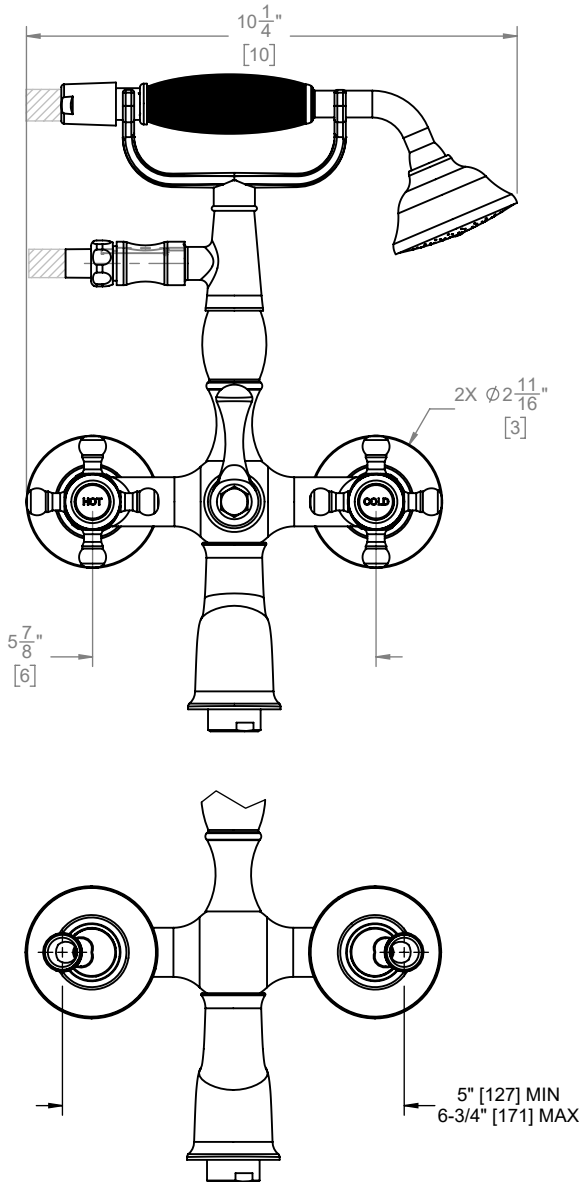

THROUGH-HOLE SPECIFICATIONS		
MIN	RECOMMENDED	MAX
$\phi 13/16$ " [21]	$\phi 1$ " [25]	$\phi 2-1/2$ " [64]

SPECIFICATIONS SUBJECT TO CHANGE WITHOUT NOTICE

ALL DIMENSIONS SHOWN TO NEAREST 1/16"
[ALL DIMENSIONS SHOWN TO NEAREST 1MM]