



California Faucets®

# TO-V3902-7, TO-V3902K-7, TO-V3902R-7, TO-V3902RI-7, TO-V3902H-7, TO-V3902P-7, TO-V3902PI-7, TO-V3902-9, TO-V3902K-9, TO-V3902R-9, TO-V3902RI-9, TO-V3902H-9, TO-V3902P-9, TO-V3902PI-9, **Two Handle Lavatory Wall Faucet Installation Instructions**

**CALIFORNIA FAUCETS RECOMMENDS THAT ALL PLUMBING PRODUCTS BE INSTALLED BY A LICENSED PROFESSIONAL**

**IMPORTANT:** Read all instructions prior to installation and provide copy of instructions to consumer.

## Operating Specifications:

Recommended Supply Pressure: 20 to 70 psi [1.4 to 4.8 bar] <sup>††</sup>

Maximum Flow Rate: 1.2 gpm [4.5 L/min]

\* Operating pressures between hot and cold supplies should vary no more than 30 psi [2.1 bar].

† If water pressure exceeds 70 psi [4.8 bar], install a Pressure-Reducing Valve (PRV).

## I INSTALLING SPOUT TO IN-WALL VALVE

- Prior to installing faucet trim in-wall vessel rough VALVE (1), **VL-R**, must be properly installed and wall surface must be completely finished

**NOTE:** Recommended through-hole size is  $\varnothing 1\text{-}1/4"$  [32mm]

- Slide spout RING (2a) onto SPOUT (2)
- Apply thread SEALANT (3) (not supplied) to threaded end of SPOUT (2) and tighten into center outlet of VALVE (1)
- If SPOUT (2) is not properly aligned when fully tightened, turn counter-clockwise till properly aligned

**IMPORTANT:** Do not overtighten SPOUT (2)

- Apply silicone caulk to back side of spout RING (2a)
- Push spout RING (2a) firmly against wall

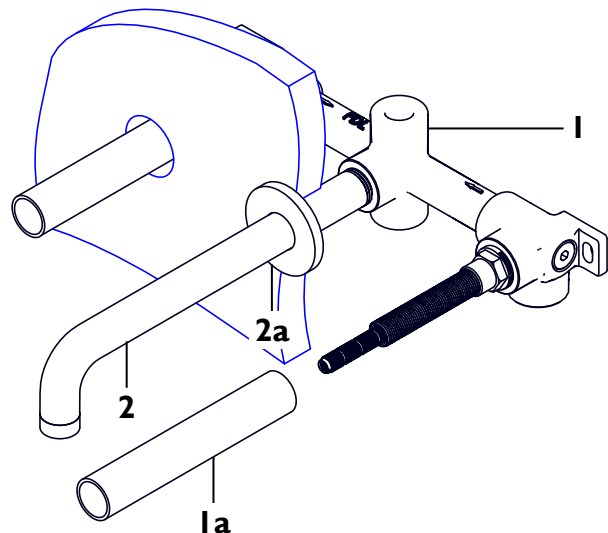
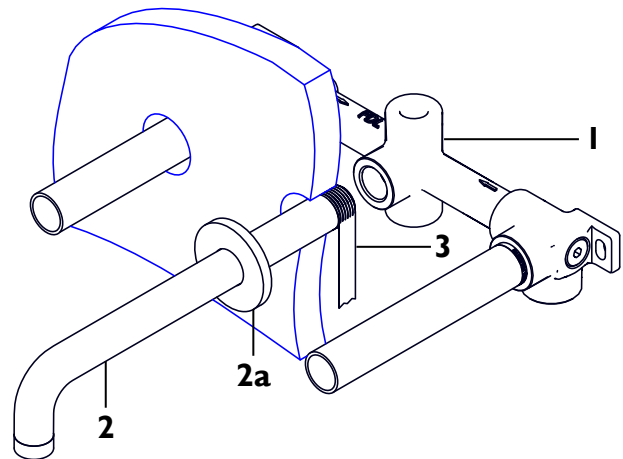

## 2

### ALIGN & TRIM VALVE STEM

- Remove MUDGUARD (1a) from VALVE (1)
- To obtain proper handle CARRIER (4) alignment it may be necessary to re-align cartridge STEM (1b); to align STEM (1b), slightly loosen the cartridge NUT (1d), place CARRIER (4) on STEM (1b) and **TIGHTEN** in CW direction until desired alignment is achieved; retighten cartridge NUT (1d) to factory torque setting of 14 ft-lbs [19Nm].

**IMPORTANT:** Handle will be aligned with carrier FLATS (4b)

**WARNING:** Cartridge NUT (1d) **MUST** be properly torqued to prevent possible failure and/or water damage

- Using a marking device (e.g. pencil or marker) indicate a distance of 5/8" [16mm] from finished wall on ALL-THREAD (1c); unscrew ALL-THREAD (1c) from valve STEM (1b)
- Cut STEM (1b) 1-3/8" [35mm] from finished wall surface
- Cut off excess ALL-THREAD (1c) at indicated mark and reattach ALL-THREAD (1c) onto valve STEM (1b) – repeat on other side

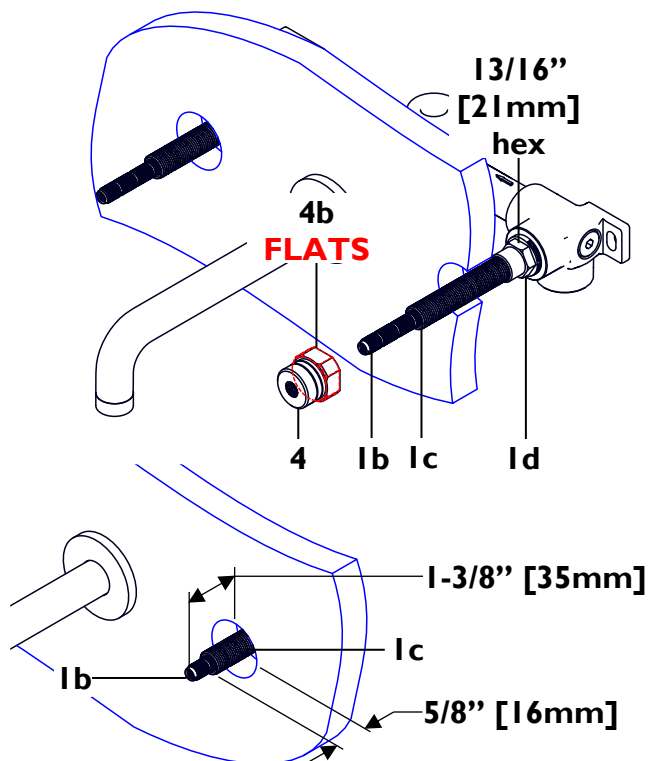

## 3

### INSTALLING HANDLE

- Tighten handle RING (5) onto ALL-THREAD (1c)
- Place handle SPACER (6) down onto ALL-THREAD (1c)
- Slide handle CARRIER (4) down onto and engage valve STEM (1b)
- Secure CARRIER (4) with SETSCREW (4a)
- Place and press down HANDLE (7) onto CARRIER (4)

**IMPORTANT:** handle FLATS (7a) **MUST** align with carrier FLATS (4b)

- Turn on water supply and check for leaks

#### TO REMOVE HANDLE

- Grip HANDLE (7) and pull out
- If HANDLE (7) does not come off, pry between HANDLE (7) and handle RING (5) with thin non-marring object

