



CALIFORNIA FAUCETS RECOMMENDS THAT ALL PLUMBING PRODUCTS BE INSTALLED BY A LICENSED PROFESSIONAL

2

INSTALLING VALVE

- From underneath insert VALVE (7) through appropriate sink/deck hole

IMPORTANT: VALVES (7) are labeled as follows:

BLUE is **COLD** left turning (counter-clockwise) closed

RED is **HOT** right-turning (clockwise) closed

- Position flange NUT (8) and WASHER (9a) & cup SPACER (10) so that VALVE (7) extends above sink/deck surface 1-3/8"
- Secure VALVE (7) with inverted NUT (11) and WASHER (9b)
- Place handle RING (12) onto valve THREADS (7a) and secure to sink/deck surface

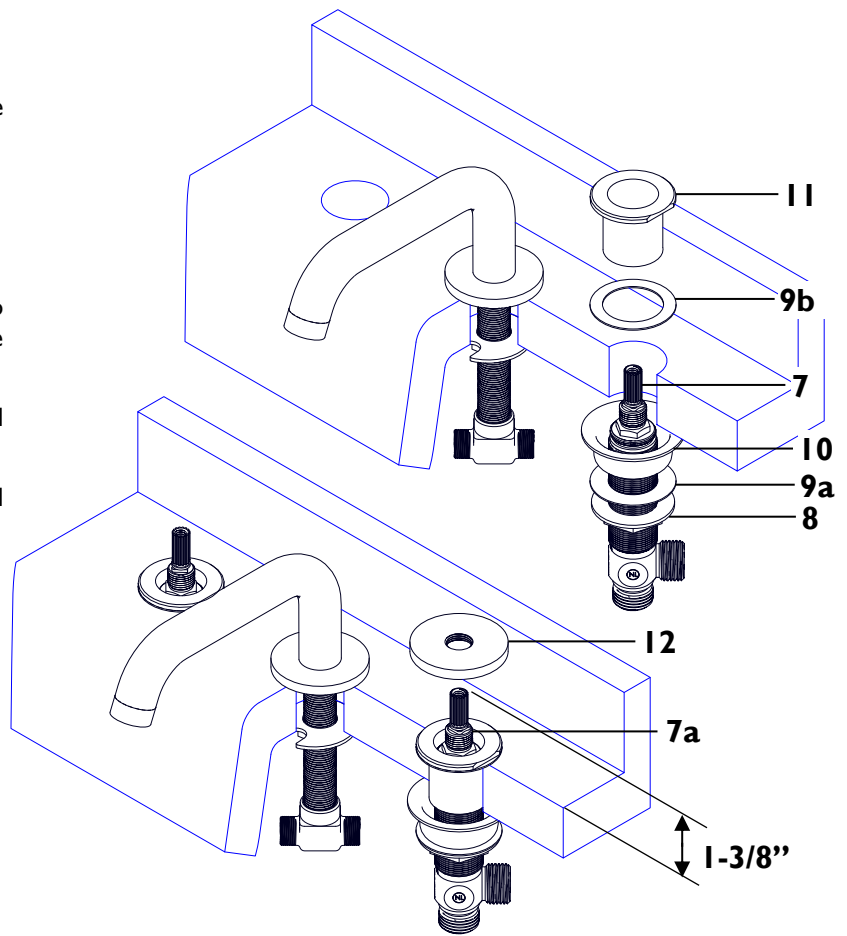

3

INSTALLING HANDLE

- Place handle SPACER (13) onto valve THREADS (7a)
- Slide handle CARRIER (14) down onto and engage valve STEM (7b)

IMPORTANT: HANDLE (15) will be aligned with carrier FLATS (14b). To obtain proper alignment it may be necessary to rotate VALVE (7) so that HANDLE (15) is aligned to desired orientation.

- Secure CARRIER (14) with SETSCREW (14a)
- Place and press down HANDLE (15) onto CARRIER (14)

IMPORTANT: handle FLATS (15a) **MUST** align with carrier FLATS (14b)

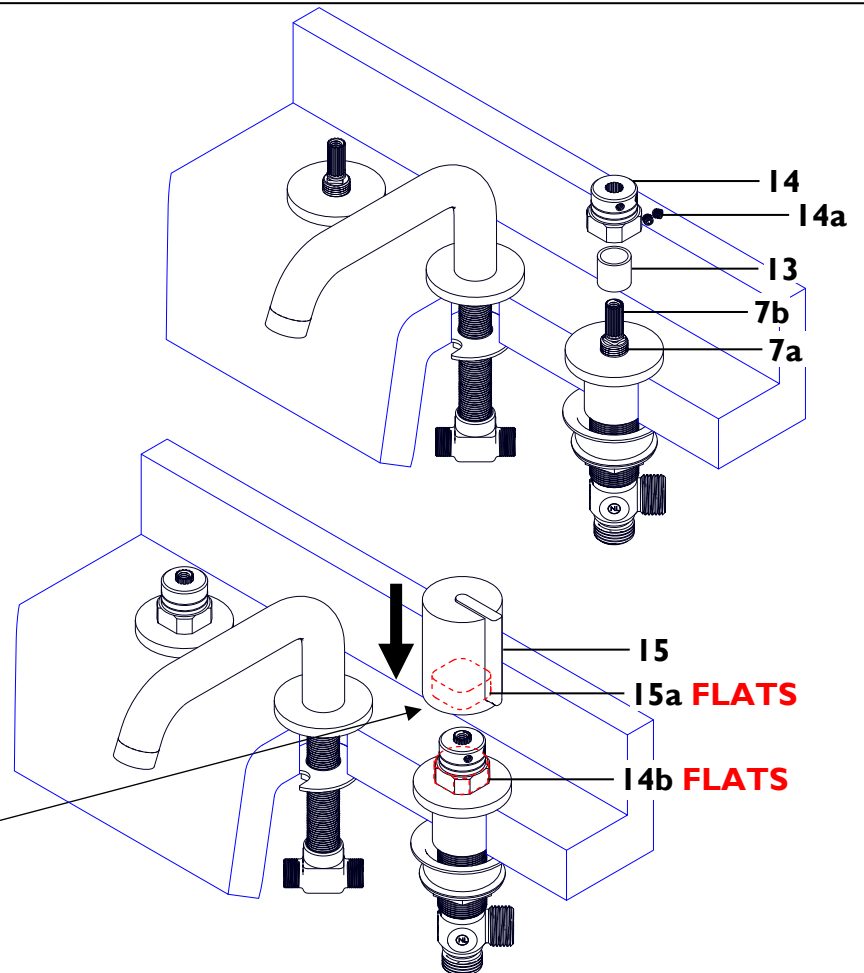
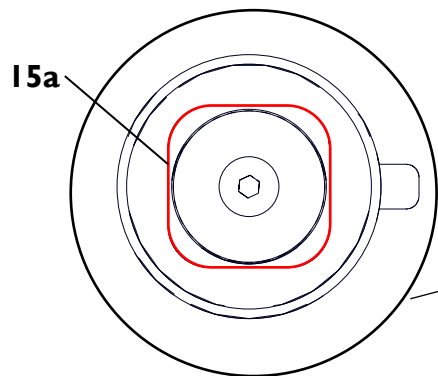

NOTE: Refer to **SECTION 8** for HANDLE (15) removal

4

INSTALLING VALVE HOSE

- Attach small hose NUT (16a) to spout TEE (6)
- Attach large hose NUT (16b) to valve side OUTLET (7c)
- Repeat for other side valve

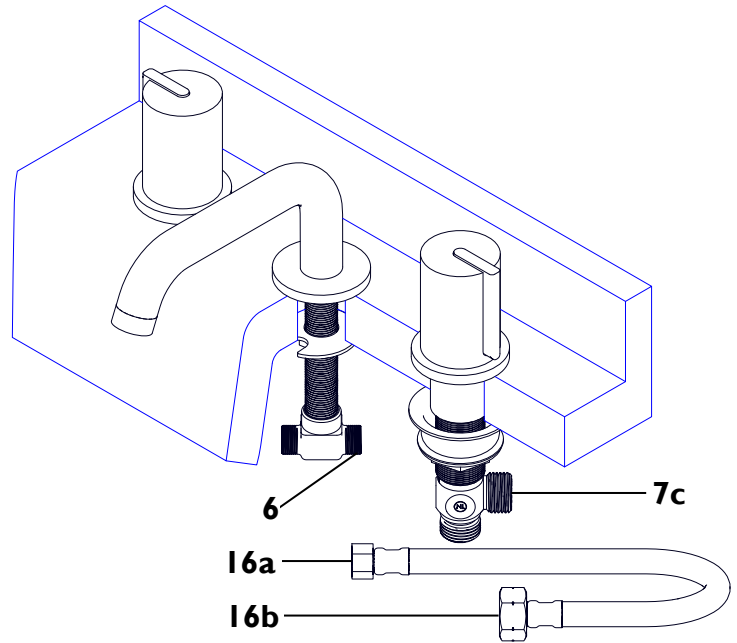

5

INSTALLING SUPPLY LINES

IMPORTANT: Prior to attachment, flush supply lines to remove debris that may cause damage or malfunction to valve cartridge.

The following are two types of supply lines (not included) that may be installed to the valve bodies:

Ballnose riser for exposed application

- Install BALLNOSE RISER (17a) using valve NUT (7e) to secure riser to valve INLET (7d)

Flexible riser for non-exposed application

- Discard valve NUT (7e) & install FLEX RISER (17b) to valve INLET (7d)

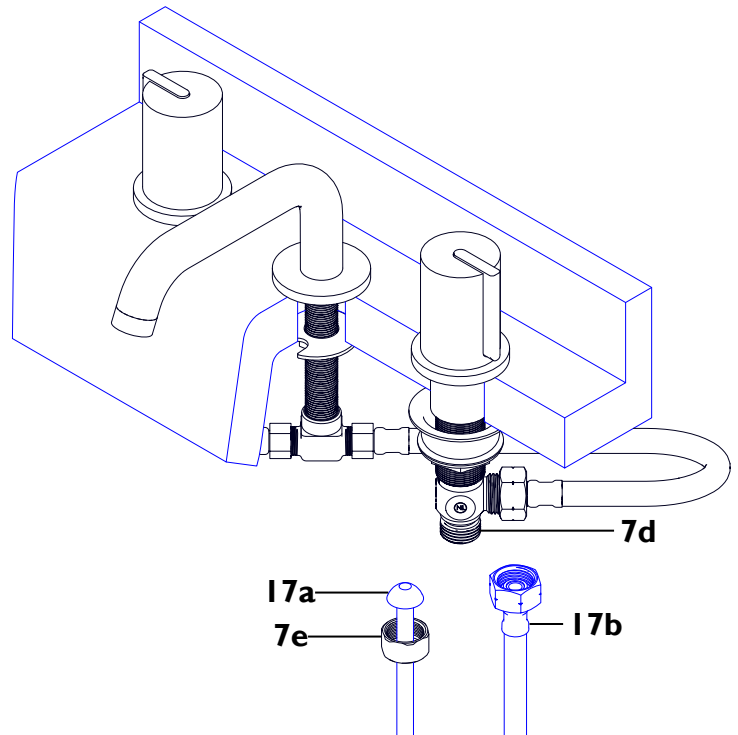

6

INSTALLING DRAIN

- Slide white foam WASHER (19) up under flange of BODY (20)
- or -
- Apply thin film of silicone caulk (or equivalent) to underside of flange on BODY (20)
- Insert BODY (20) down through sink drain hole
- From underside, slide MACH-WASHER (21) and FRICTION-WASHER (22) up onto BODY (20)
- Secure BODY (20) into place with flange NUT (23)
- Apply thread sealant to threads on TAILPIECE (24) & tighten onto BODY (20)
- Attach TAILPIECE (24) to p-trap (not supplied)

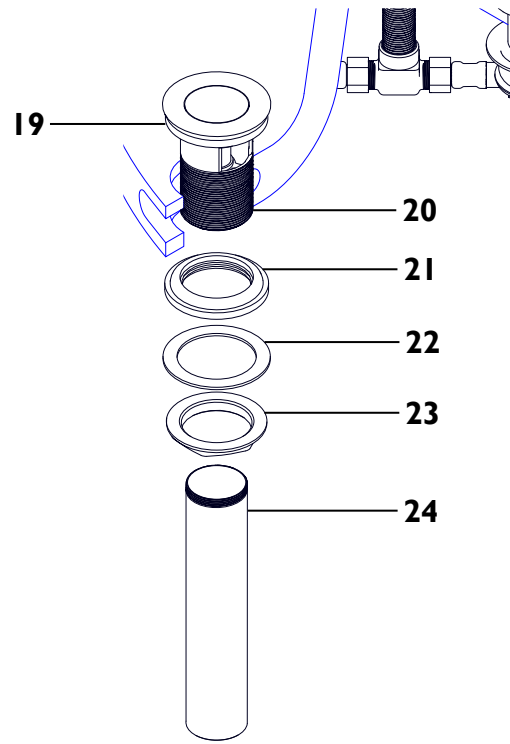

7

FLUSH SYSTEM & CHECK FOR LEAKS

- Remove AERATOR (25) from SPOUT (1) using KEY (26); rotate counterclockwise to loosen
- Turn on water supply valves
- Turn faucet HANDLE (15) to full open to flush system for 1 minute

IMPORTANT: This flushes any debris from the system that could cause damage to internal parts

- Check for leaks at all connections
- Reinstall AERATOR (25) into SPOUT (1) using KEY (26)

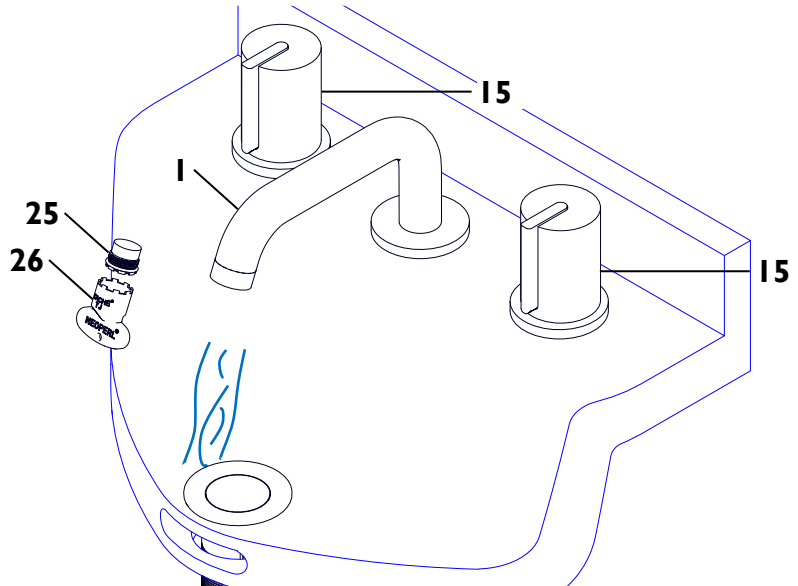

8

REMOVE HANDLE

- Grip HANDLE (15) and pull up
- If HANDLE (15) does not come off, pry between HANDLE (15) and handle RING (12) with thin non-marring object

