BERTAZZONI
INSTALLATION AND USER MANUAL
REFRIGERATOR

EN

BERTAZZONI
INSTRUCTIONS D'INSTALLATION ET D'UTILISATION
REFRIGERATEUR

FR

BERTAZZONI
INSTRUCCIONES DE INSTALACION Y USO
REFRIGERADOR

ES



REF24BMBPNB

WWW.BERTAZZONI.COM

CONTENT

IMPORTANT NOTICE.....	2
APPLIANCE ACCESSORIES.....	3
INSTALLATION AND OPERATING CONDITIONS OF THE APPLIANCE.....	4
DOOR REVERSAL	6
INSTALLATION INSTRUCTION.....	8
BEFORE FIRST USE.....	11
STORAGE INSTRUCTIONS.....	13
CONTROLS	14
DEFROSTING.....	15
CARE AND CLEANING.....	16
TROUBLESHOOTING.....	17
WARRANTY.....	18

IMPORTANT NOTICES

1. This manual is generic and may reference several refrigerator models. The Manufacturer shall not be held liable for damage arising from the failure to observe the instructions contained in this manual.
2. Keep this manual for future reference, or to pass it over to the next user.
3. The appliance operates properly at room temperature (see product fiche). Do not use it in the basement or unheated summer cottage during autumn and winter.
4. When placing, moving, lifting the appliance, do not hold the door handles, do not pull the condenser at the rear part of the refrigerator and do not touch the compressor unit.
5. When transporting, moving or positioning the fridge-freezer do not tilt it by more than 40° from the vertical position. Should such a situation occur, the appliance should be switched on after minimum 2 hours from its replacement in the right position.
6. Pull the plug out from the mains socket before each maintenance activity. Do not pull on the cord, but hold the body of the plug instead.
7. The “cracking” sound, which the appliance may emit is caused by the expansion and contraction of parts as a result of temperature variations.
8. For safety reasons do not repair the appliance yourself. Repairs carried out by people who do not have the required qualifications may result in serious danger for the user of the appliance.
9. Air the room in which the appliance is placed for a few minutes (the size of the room for a product containing isobutane/R600a must be at least 4m³) to avoid damage to the cooling system.
10. Do not refreeze partly thawed products.
11. Do not store beverages in bottles and cans, especially carbonated beverages, in the freezer chamber. The cans and the bottles may explode.
12. Do not put frozen products, taken out directly from the freezer (popsicles, ice cubes, etc.) into your mouth, their low temperature may cause severe frost-bite.
13. Make sure you do not damage the cooling system, by puncturing the refrigerant pipes in the evaporator or breaking the pipes. The refrigerant is flammable. If the refrigerant makes contact with the eyes, rinse them with clean water and call for medical assistance immediately.
14. This appliance is intended for food storage, do not use it for other purposes.
15. When performing activities, such as cleaning, maintenance or moving, the appliance must be completely disconnected from power supply (by pulling the plug out from the socket).
16. This appliance can be used by children aged 8 years and older or by people with physical, mental or sensory handicaps, or by those who are inexperienced or unfamiliar with the appliance, provided they are supervised or have been instructed how to safely use the appliance and are familiar with risks associated with the use of the appliance. Ensure that children do not play with the appliance. Cleaning and maintenance of the appliance should not be performed by children unless they are 8 years or older and are supervised by a competent person.
17. The Anti-bacteria System (varies depending on the model, its presence is indicated by the label inside the appliance chamber) protects foods and products inside the refrigerator from bacteria and mould, which may cause unpleasant smells and shorten storage time. The Anti-bacteria System prolongs the freshness of food. The special material used to construct the fridge liner prevents bacterial, microorganism and mould growth.

ACCESSORIES OF APPLIANCE

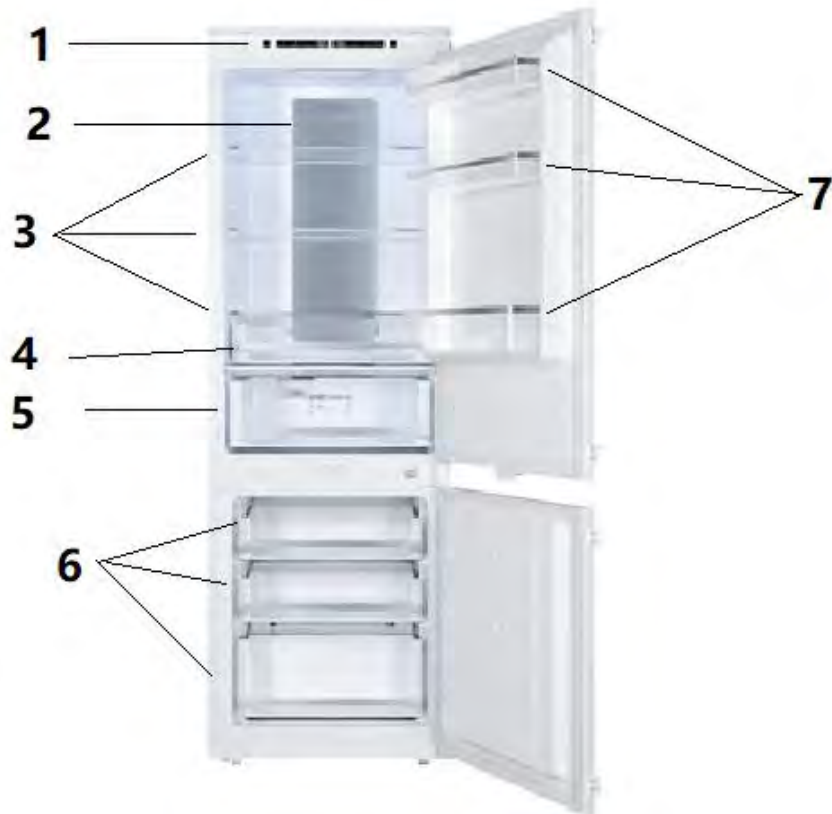

1. Control panel

2. Air duct panel

3. Glass shelves

4. Crispers

5. Fresh zone

6. Drawers

7. Door bins

INSTALLATION AND OPERATING CONDITIONS OF THE APPLIANCE

Installation before using the appliance for the first time

- Make sure there is enough space around the refrigerator to make it work properly. A free space of 25/64" (10 mm) is required on the rear of the equipment so that the air can circulate to cool the compressor. Space above the refrigerator should be kept at 1 3/16" (30 mm).
- Make sure the appliance is placed in a level position by screwing in the 2 adjustable front legs.

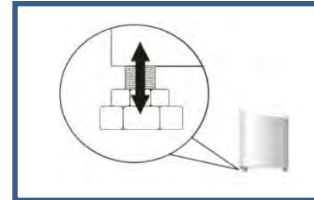

Minimum distances from the heat sources

- from the electric gas and other ovens - 1 3/16" (30 mm),
- from oil or coal fired ovens - 11 13/16" (300 mm),
- from built-in ovens - 1 31/32" (50 mm)

Installation must be precise and carried out as specified with nothing left to interpretation.

Connect to the power supply

- Prior to connection, it is recommended to set the temperature control knob to an "OFF" or other position that disconnects the appliance from the power supply (see page with the control description).
- This appliance should be connected to AC 110-120V 60HZ supply socket. The socket must be fitted properly, and must be supplied with an earthing conduit and a 10A fuse.
- It is a legal requirement that the appliance is properly grounded. The manufacturer will not be held liable for any damage or injury which may result from the failure to fulfil this requirement.
- Do not use adapters, multiple sockets and two-wire extension leads. If it is necessary to use the extension lead, it must be equipped with a protection ring and a single socket and must have a VDE/GS safety certificate.
- If an extension lead is used (with a protection ring and safety certificate), its socket must be located at a safe distance, away from the sinks, and must not be in a place where it could be flooded by water or waste water.
- See the data plate at the lower part of the internal wall of the appliance for detailed specifications

Disconnect to the power supply

- Make sure the appliance can be easily disconnected from the mains, either by pulling the plug out of the receptacle, or by switching the breaking off.

INSTALLATION INSTRUCTIONS

CHANGE THE OPENING DIRECTION OF YOUR PRODUCT

Remove the right upper hinge cover and hinge by screw driver.

1

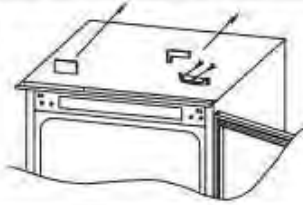

Remove the upper door.

2

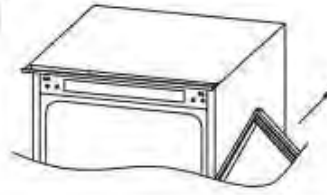

Remove the middle hinge and its connecting pin underneath.

3

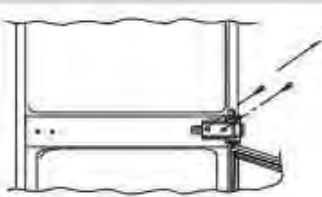

Remove the bottom door.

4

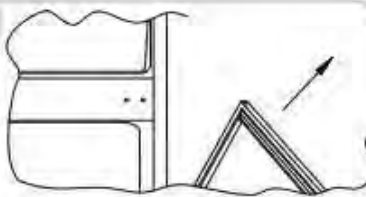

Remove the right bottom hinge and left plastic plugs, and refit them onto the opposite side.

5

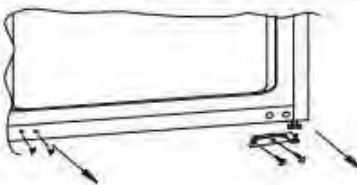

Assembly the right upper hinge to the left bottom and fit the cover.

6

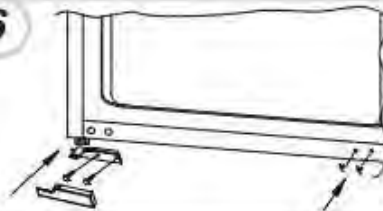

Reassemble the doors and hinges working from bottom to top, from 1-4.

7

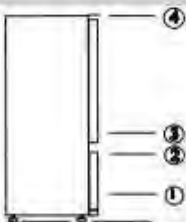

Ensuring the door seals correctly:

It is normal for the seal to be compressed after the door has been reversed. With the door closed, use a hair dryer to expand the seal and fill the gap between the door and the body of the appliance. Take care not to use the hair dryer too close to the appliance, which could damage the seal. A distance of approximately 4" (10cm) should be adequate. When completed, allow the seal and door to cool before touching them. Once done, the seal should remain in position.

INSTALLATION INSTRUCTIONS

The main consideration when installing any refrigeration unit into a fitted kitchen is ventilation. The heat removed from the cooling compartment needs to be dissipated into the atmosphere. Incorrect ventilation can lead to premature compressor failure, excessive power consumption, total system failure and may invalidate the warranty provided with the appliance.

For products intended to be installed into a tall housing unit, the following requirements need to be met:

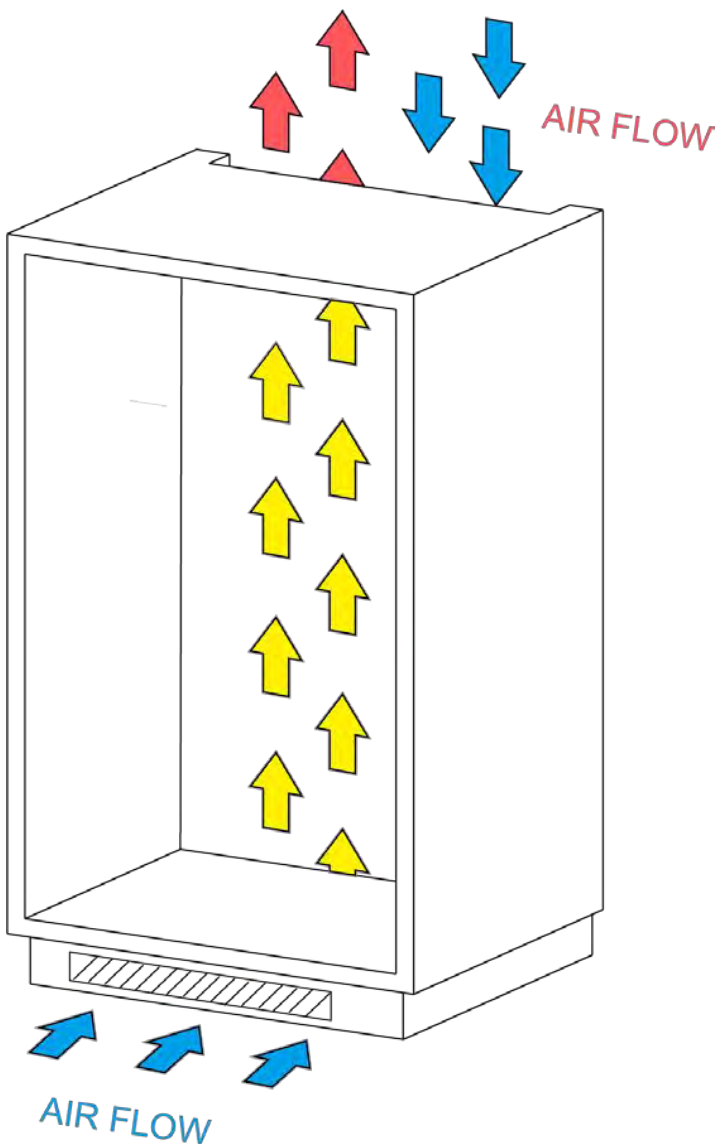

An air passageway should be provided in the top of the cabinet run to allow free air in and out.

There should be space at the rear of the cabinet to allow cool air to be drawn over the condenser.

A cutout should be made in the plinth below the fridge/freezer and this finished neatly using the air vent grille. Alternatively, a thin section of the plinth can be removed to allow air into the unit. Size recommended is 23 5/8" x 1 37/64" (600 mm x 40 mm).

INSTALLATION INSTRUCTIONS

REQUIRED CAVITY DIMENSION

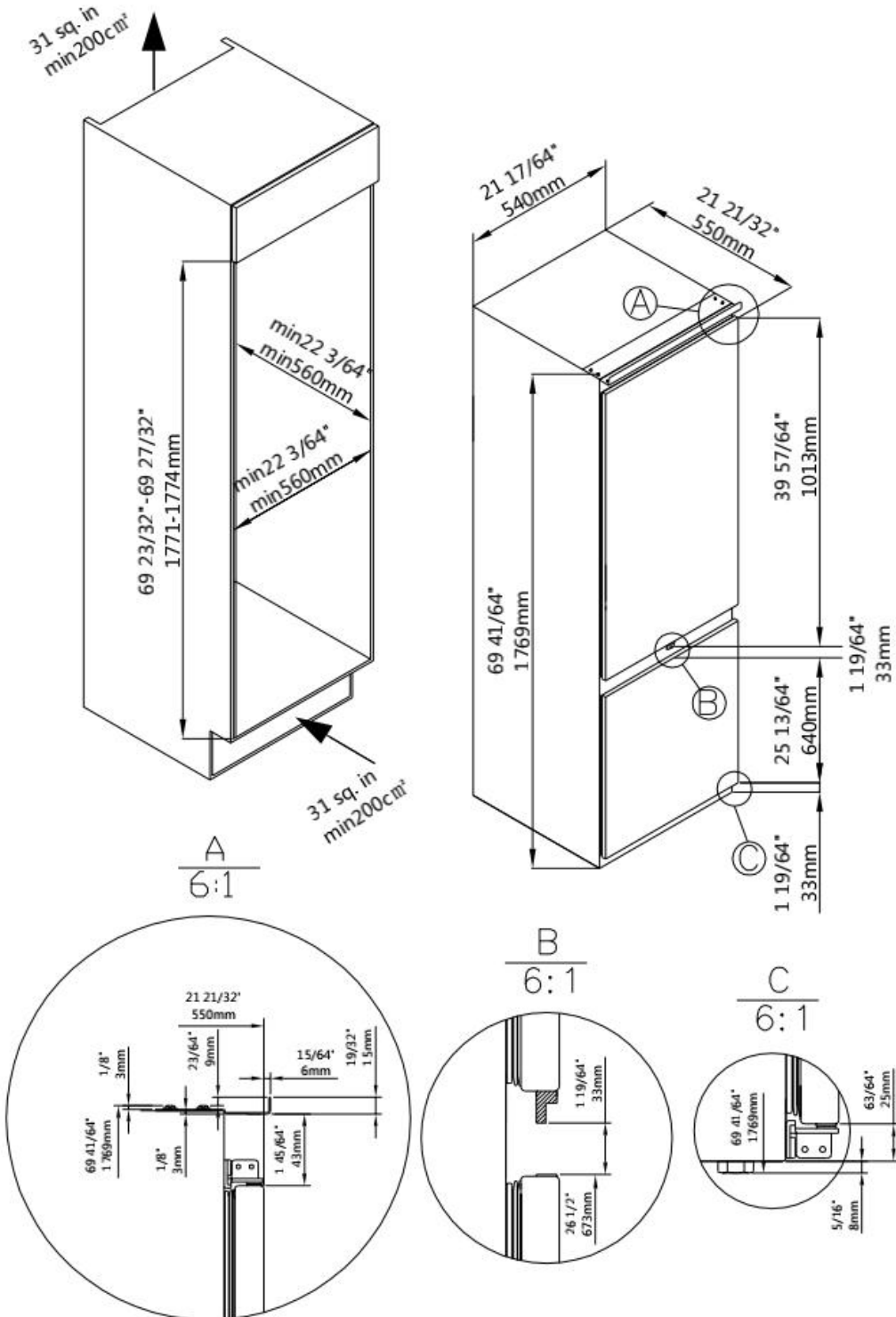

INSTALLATION INSTRUCTIONS

Installation into the cabinet

With the help of another individual, or two, move the appliance into the cabinet. There are two metal plates at the base of the appliance. Fit the supplied white spacers to these plates.

Insert the appliance into the column placing it on the opposite site of the hinges, and make sure $1/8''-13/64''$ distance gap.

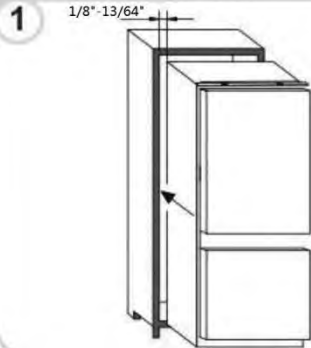

After ensuring the match between appliance door and column door, fix the plastic covers from accessories bag.

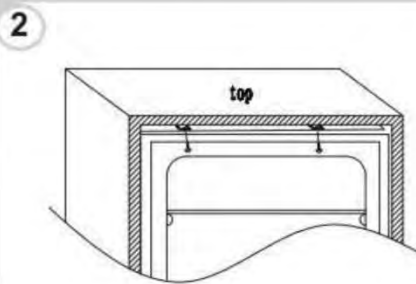

Screw the appliance lower part.

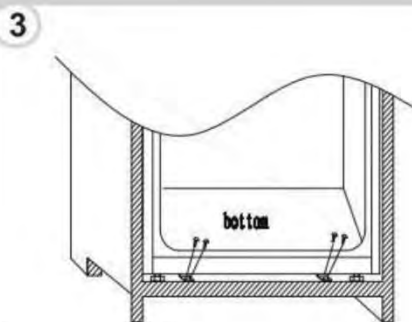

Fit the seal to the appliance, cut off the excessive part if necessary. Fit the bottom parts with plastic covers.

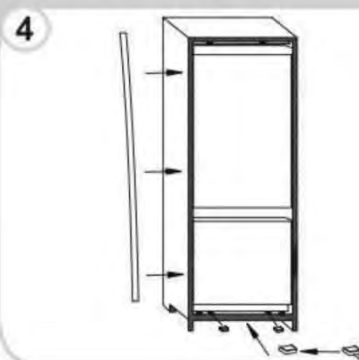

Use a cross-screwdriver to loosen the connecting pin underneath the right middle hinge, and adjust to screw onto the right cabinet wall.

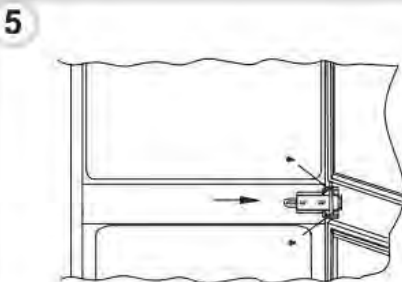

INSTALLATION INSTRUCTIONS

Mounting the fascia doors

- Ensure that there is a gap of 1/8" to 5/32" (3 to 4mm) between the non-hinged side and the cabinet wall.
- Locate the slider in the bracket and fix the slider to the fascia door 51/64" to 7/8" (20 to 22mm) from the edge of the fascia as shown in the following image, ensuring that the slider is positioned centrally and horizontally within the bracket. Tighten securely by hand.
- Fill the gap on the non-hinged side with the gasket/seal strip provided.
- The finished look for the door sliders should be similar to those shown in the following image, which shows 2 sliders in place.

Ensure the appliance doors open, close and seal properly.

Once complete, and if you are happy with the fit of the appliance in the cabinet, bend and snap the parts of the white spacers marked 'S' as shown by the dotted outline. Leave the rest of the spacer cover in place over the metal plates.

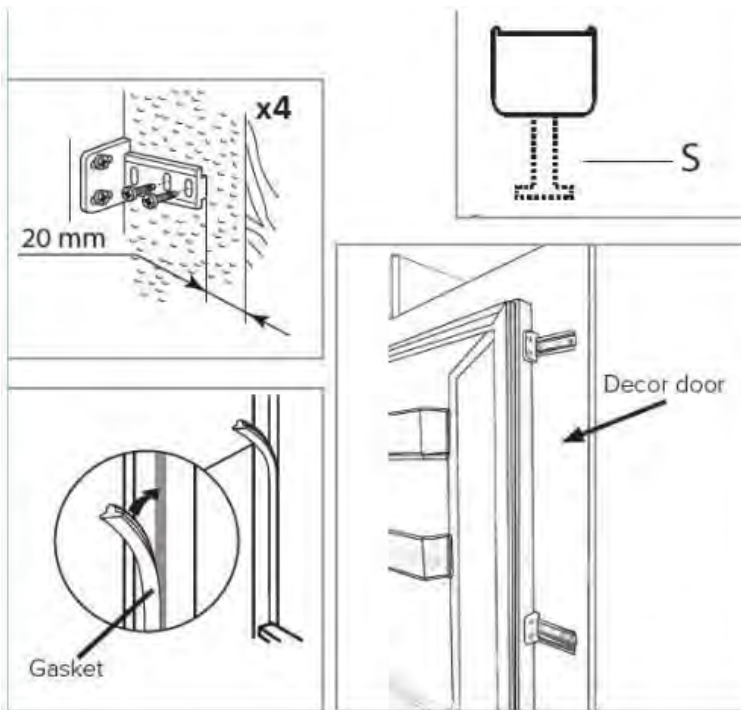

Important: After completing the installation, check that the appliance is secured within the unit and that the door(s) close and open properly. If there is no resistance from the door seals when opening the doors, then it is probable that the appliance and/or decor doors are not fitted properly.

BEFORE USE

Before first use, you must allow the fridge to settle for at least twenty four hours prior to switching the power on.

It is recommended that you clean the interior of the appliance prior to first use using a solution of baking soda and warm water, then thoroughly dry the interior. The fridge may have an odor to it at first use. This will disappear as the appliance cools.

Please note:

The appliance will start at 41 °F (5°C) for fridge and 0 °F (-18 °C) for freezer and work continuously until it comes down to the correct temperature. If the appliance is switched off, you should allow five minutes before switching it on again to prevent unnecessary damage to the compressor. Never store flammable or explosive items and strong corrosive acids or alkalis in the appliance. This fridge cools your food by making the inside back of the cavity cold. It is normal for frost to build up on this surface; it then dissipates and drains through a small drain at the bottom, where it evaporates harmlessly. The presence of frosting at the back is not a malfunction of the fridge.

STORAGE INSTRUCTION

Fridge use

1. Never put liquids in the refrigerator uncovered.
2. Never put hot foods in the refrigerator. Warm food should be allowed to cool to room temperature before being put into the refrigerator.
3. Nothing should rest against the rear wall of the refrigerator, as this will cause frost and possible condensation problems which will be difficult to remove.
4. Make sure food is clean and any extra water is wiped away before putting into the fridge.
5. Wrap or cover food before putting into the fridge. This will help prevent the loss of moisture, keep food fresh and avoid unpleasant odors.
6. Any foods to be used soon should be stored at the front of the shelf to prevent deterioration caused by the door being open for prolonged periods.
7. Do not overfill the fridge. There should be sufficient space between the foods to allow the cool air to circulate.
8. Thawing frozen foods in the fridge compartment will help to keep the temperature low and save energy.
9. Never store raw meats on shelves above cooked meats or other produce. This will help to prevent juices from raw meat contaminating other foodstuffs.

Note:

The fridge shelves can be moved according to the storage requirements within the fridge section. To move the shelf, lift up the rear section and then pull it outwards.

To replace, slide the shelf back into the slot, and then lower the rear section.

Freezer use

1. The freezer compartments are designed to store only frozen food.
2. Never put hot or warm foods in the freezer, allow them to cool fully before putting them into the freezer.
3. Follow the instructions on the food packaging for storage of frozen food. If no information is provided, foods should not be stored for more than three months after the purchase date.
4. Store food in small packages (ideally less than 1kg). This reduces the freezing time and improves the quality of the food after thawing.
5. Wrap food before putting into the freezer. To stop the wrapping sticking together, ensure it is dry.
6. Label the food before freezing with information including type of food and dates of storage and expiry.
7. Once food is thawed, it must not be refrozen. Only defrost as much food as is required to prevent wastage.
8. Bottled or canned drinks should not be stored in the freezer compartments as they could explode.
9. The maximum amount of fresh food that can be frozen within a 24 hour period is 5.7 lb (2.6kg).
10. Do not attempt to freeze more than the maximum amount.

STORAGE INSTRUCTION

The fridge section is for short term food storage. Although low temperatures can be maintained, extended periods of food storage is not recommended.

As the cold air circulates within the fridge, the temperature can vary between the different sections. As such, foods should be stored in different sections according to type.

1. Butter, cheeses etc.
2. Food in jars and bottles
3. Drinks, e.g. milk
4. Cooked food
5. Yogurts, preserves etc.
6. 75cl bottles or ready meals etc.
7. Fresh meat and fish
8. Fruit and vegetables



- The fridge shelves can be moved according to the storage requirements within the fridge section.
- To move the shelf, lift up the rear section and then pull it outwards.
- To replace, slide the shelf back into the slot, and then lower the rear section.

Fresh Zone

- ◆ You can control the temperature inside the fresh zone independently.
- ◆ Temperature ranges of fresh zone from 37°F (3°C) to 27°F (-3°C).
- ◆ Zero-degree biological preservation technology makes the refrigerator contain a relatively stable, independent, very close to 37°F (3°C), but not less than 27°F (-3°C) fresh-keeping compartment. The temperature of the Fresh Zone ensures that food will not get frozen and will be kept fresh for a period of time.
- ◆ Suggestions for use: It is recommended to store fresh fish, fresh meat and dried fruit in condition of 28°F (-2°C) to 32°F (0°C). Put the frozen ingredients into the fresh zone 4-5 hours before use, you can cut or cook frozen foods effortlessly and enjoy a more modern, faster and healthier cooking experience.
- ◆ It is recommended to store vegetables and fruits in condition of 32°F (0°C) to 37°F (3°C).
- ◆ Note: If you want to put easy-drying ingredients such as meat into the zero temperature zone for more than 4 hours, you should use plastic wrap to wrap the ingredients to avoid excessive moisture loss and affect the taste.

Crisper drawer humidity adjustment

- ◆ The crisper drawer within this appliance features a humidity level adjustment slider. Vegetables and similar foods that are subject to wilting (e.g. arugula, spinach leaves, herbs such as basil etc.) should be kept in the crisper drawer and the adjustment slider kept closed (fully to the left - high). By keeping the adjustment slider closed, water vapour is held in the drawer and subsequently greens are kept crisper and fresher for longer.
- ◆ By contrast, fruits that are susceptible to rotting should be stored in the crisper drawer with the humidity adjustment slider fully open (to the right - low). This will allow gases, emitted by certain foods and that accelerate the rotting process, to exit the crisper drawer.
- ◆ The drawer is marked high and low with vegetable and fruit symbols to aid you.

CONTROLS

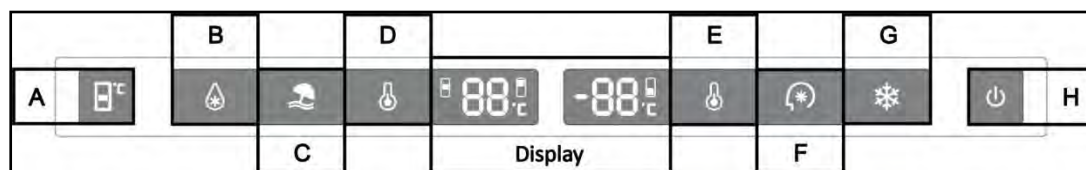

1. First time of switching on the appliance or re-supply after power failure, the appliance always works at settings: 41 °F (5°C) for fridge, 37°F (3°C) for My Zone and 0 °F (-18°C) for freezer. If you want to adjust the temperature or functions manually, press any button to wake up the control panel, then any change can be made.
2. Fridge temperature adjustment –press button **D** on left part of control panel to achieve different temperatures from 34°F (1°C) to 43°F (6 °C).
3. Freezer temperature adjustment –press button **E** on right part of control panel to achieve different temperatures from 5°F (-15)°C to -9°F (-22°C).
4. Fast Cooling function – Press button **B**, button illuminates and Fast Cooling function is turned on, fridge starts to work automatically at temperature setting 34°F (1°C) and quits after 2.5 hours. Light will turn off.
5. Holiday function – Press button **C**, button illuminates, Holiday function is turned on and whole appliance starts to work automatically at settings: fridge at 63°F (17°C) and freezer at 0°F (-18°C). The Fresh Zone works at 63°F (17°C).
6. Smart function – Press button **F** on control panel, Smart function is turned on and button illuminates, fridge compartment works at setting 41°F (5°C) and freezer compartment works at setting of 0°F (-18°C). The Fresh Zone works at setting of 37°F (3°C).
7. Fast Freezing function – Press button **G**, button illuminates and freezer start to work at Fast Freezing function, temperature setting -9°F (-22°C). After 6 hours, Fast Freezing function quits automatically.
8. Press button **H** for 3 seconds to switch off your appliance and the button illuminates, power is cut off. Internal light stop working, compressor stops working. Press the button **H** for 3 seconds to switch on your appliance, the symbol light and power is connected again.
9. Press the button **A** to temporarily turn the display section corresponding to the Fresh Zone, press the button **A** again to adjust the temperature. Temperature ranges of fresh zone from 27°F (-3°C) to 37°F (3°C).
10. On No Frost models, there is a function: Forced Defrosting. Press the buttons **D/E + H** for 5 seconds to switch on the Forced Defrostin function to clean the freezer evaporator, freezer temperature will be displayed. Press the buttons **D/E + H** for 3 seconds to switch off the Forced Defrosting function, freezer temperature will be displayed.
11. Fault Display – This appliance has 'Fault Display & Alarm' function. Once the sensors fault, there are alarms displayed on the temperature displaying, the appliance still cools but a professional service engineer should be called to check the appliance.

F1 – Sensor of fridge evaporator

F2 – Sensor of fresh zone

F3 – Sensor of fridge compartment

F4 – Sensor of freezer compartment

F5 – Sensor of freezer evaporator

2E – Fault of fan/motor in freezer

EC – Communication fault between main panel and display panel

PS: Main board locates in compressor compartment

DEFROSTING

The product has a No Frost system which is designed to prevent the heavy build up of ice. Under normal use, there should be no need to regularly defrost the freezer system.

Please note: If you are regularly finding heavy ice build up, or pools of water in the freezer section then it is likely that the door is not sealing properly. This could be due to a faulty door seal or incorrect assembly or exceeding the maximum weight. For more information see the troubleshooting section on ice.

CARE AND CLEANING

Always disconnect the appliance from the power supply before any cleaning or maintenance.

The fridge and freezer sections should be cleaned using a solution of bicarbonate of soda and lukewarm water. Do not use abrasive products or detergents. After washing, rinse and dry thoroughly.

Clean the shelves and door bins separately by hand with a mild solution of dish soap and water. Do not put them in the dishwasher.

If the appliance is not going to be used for prolonged periods of time, unplug and clean the appliance. The doors should be left slightly ajar to prevent the formation of mildew and unpleasant odors.

TROUBLESHOOTING

If you have any problems with your appliance, you should check this troubleshooting prior to calling Customer Care.

If the appliance is not working, check:

That there is power to the appliance.

The house fuses are intact and the fuse in the plug has not blown.

The fridge has not been turned off.

The plug socket is functioning fine. To check this, plug another electrical appliance in to see if the socket is faulty.

If the appliance is working, but not very well, check:

The appliance is not overloaded.

The thermostat is set to an appropriate temperature.

The doors are closing properly.

The cooling system at the rear of the appliance is clean and free of dust, and not touching the rear wall.

There is enough ventilation at the side and rear walls.

If the appliance is noisy, check:

The appliance is level and stable.

The side and rear walls are clear, and there is nothing resting on the appliance.

Note: The cooling gas in the refrigerator may make a slight bubbling or gurgling noise, even when the compressor is not running.

If the appliance is beeping, check:

That the doors are closed. An alarm will sound after 60 seconds of a door being open.

If ice has formed on the back wall of the fridge:

It is normal for some ice droplets to form on the back wall of the fridge. This does not constitute a fault with the appliance.

Ensure that no items inside the fridge are in contact with the back wall.

Check that there is some resistance when opening the door of the appliance. If it opens at the slightest touch it may mean that the door seal needs to be replaced.

Check the door seal for any kinks, debris or damage. If you notice any, and are unable to resolve the issue yourself, contact Customer Care so that the seal can be replaced.

This can be due to the decor door(s) not being properly fitted. If you are at all unsure, ask your installer to check the decor doors.

If excessive ice has formed in the freezer:

Check that there is some resistance when opening the door of the appliance. If it opens at the slightest touch it may mean that the door seal needs to be replaced.

Check the door seal for any kinks, debris or damage. If you notice any, and are unable to resolve the issue yourself, contact Customer Care so that the seal can be replaced.

This can be due to the door panel(s) not being properly fitted. If you are at all unsure, ask your fitter to check the door panel(s).

If one or more of the LED units within the appliance is not working:

Contact Customer Care to arrange a service visit.

Warranty

Please kindly register on our web site www.bertazzoni.com to validate your new product warranty and help us to assist you better in case of any inconvenience.

TWO YEAR LIMITED WARRANTY

The warranties provided by Bertazzoni Spa in this statement apply exclusively to Bertazzoni appliances and accessories sold as new products to the original owner by a Bertazzoni authorized distributor, retailer, dealer or service center and installed in the United States and Canada. The warranties provided in this statement are not transferable and have validity from the date of installation.

COVERAGE INFORMATION

Bertazzoni SpA will repair or replace any component part which fails or proves defective due to materials and/or workmanship within 2 years from the date of installation and under conditions of normal residential use. Repair or replacement will be free of charge, including labor at standard rates and shipping expenses. Repair service must be performed by a Bertazzoni Authorized Service Center during normal working hours.

COSMETIC WARRANTY

Bertazzoni will cover parts showing cosmetic defects in material and workmanship for a period of thirty (30) days from date of installation of the unit. This coverage will include scratches, stains, surface imperfections on stainless steel, paint and porcelain, with the exclusion of slight differences in color due to materials and painting/enamelling technologies.

Exclusions are labor costs, B stock items, out - of - box appliances and display units.

HOW TO OBTAIN SERVICE

To obtain service please contact Bertazzoni Customer Service at the numbers below and make sure to have model number, serial number, and date of purchase ready. This information will be requested by our team and is crucial to speeding up resolution.

UNITED STATES

<https://us.bertazzoni.com/more/support>

Phone: 866-905-0010

CANADA

<https://ca.bertazzoni.com/more/support>

Phone : 800-361-0799

Save proof of original purchase or of original installation to establish warranty period. Copy of the product serial tag is affixed to the back cover of the instruction manual.

Warranty

WHAT IS NOT COVERED

1. The product used in any commercial/business application
2. Repair service provided by other than a Bertazzoni authorized service agent.
3. Damage or repair service to correct service provided by an unauthorized agency or the use of unauthorized parts.
4. Installation not in accordance with local electrical codes or plumbing codes.
5. Defects or damage due to improper storage of the product.
6. Defects or damage or missing parts on products sold out of the original factory packaging or from displays.
7. Service calls or repairs to correct the installation of the product and/or related accessories.
8. Service calls to connect, convert or otherwise repair the electrical wiring / gas line / water line to properly use the product.
9. Service calls to provide instructions on the use of a Bertazzoni product.
10. Repair service due to product usage in manner other than what is normal and customary for home use.
11. Replacement of wear and tear parts
12. Replacement of glasses and light bulbs if they are claimed to have failed later than 30 days after installation and in no case later than 4 months after date of purchase
13. Defects and damages arising from accident, alteration, misuse, abuse, improper installation.
14. Defects and damages arising from transportation of the product to the home of the owner.
15. Defects and damage arising from external forces beyond the control of Bertazzoni SpA such as fire, flood, earthquakes and other acts of God.

In case the product will be installed in a remote area, where certified trained technicians are not reasonably available, the customer will be responsible for the transportation costs for the delivery of the product to the nearest authorized service center or for the displacement costs of a certified trained technician.

Bertazzoni does not assume any responsibility for incidental or consequential damages.

Some states do not allow the exclusion or limitation of incidental or consequential damages, so the above limitation or exclusion may not apply to you. This warranty gives you specific legal rights and you may also have other rights which may vary from state to state or province to province.