

thalassa2 7233

72" x 33" x 20"



Product No.

Model	TMU BTHRRB00T-XX	Soaker BTHRRB00N-XX
-------	------------------	---------------------

ThermoMasseur (TMU)

Air Jet System	\$5,195
Jets	46
1 heated backrest	Included
Mia® Control	Included
BU-Touch Control Application BUTOUCH	\$495
Geysair®	Included
AromaCloud®** BAROMAC	\$590
Illuzio Chromatherapy BCHRO6	\$995

Soaker

AromaCloud®** BAROMAC	\$590
Illuzio Chromatherapy BCHRO6	\$995
WarmTouchShell® BWTS	\$1,125
DOT Control	Included with therapy

Features

Installation Type	Drop-in & Alcove (3 walls)
No. of bathers	2
Imp. gallons	47
US gallons	56
Armrests	2
Standard Bath Color	White 01

Options UPCHARGE APPLICABLE

Control (TMU only)	p.13	
MiaPlus®# BMIAP1-XX		\$285
Grab Bars	p.16	\$125
Skirt	p.254	
White 01		\$695
Tile Flange (specify left or right)	p.15	
Ordered with bath (not installed)	BTILEN	\$79
Factory-installed. Right	BTILER, Left	BTILEL, Special installation
BTILEO		\$155
Bath Pillow	BPILLOW p.252	\$240
Drain & Overflow	p.14	
Chrome 07		\$205
White 01		\$165
Brushed Nickel 09		\$205
Polished Nickel 10		\$205
Oil-rubbed Bronze 11		N/A
Matte Black 19	Satin Brass 18	\$260
If Required by Construction Code		
Brass drain & overflow kit	BDRCOB	\$240
Brass drain kit	BDRCB	\$60
16" x 35" Cable driven brass drain & overflow kit	BOVERBR	\$240

† ZenFlow: Integrated overflow without a trim.
** The AromaCloud® is built into the deck (factory installed).
The MiaPlus® Control is Included when purchasing Chromatherapy on a TMU.

thalassa2 7233

72" x 33" x 20"



Shown with optional Grab bars

Technical Specifications

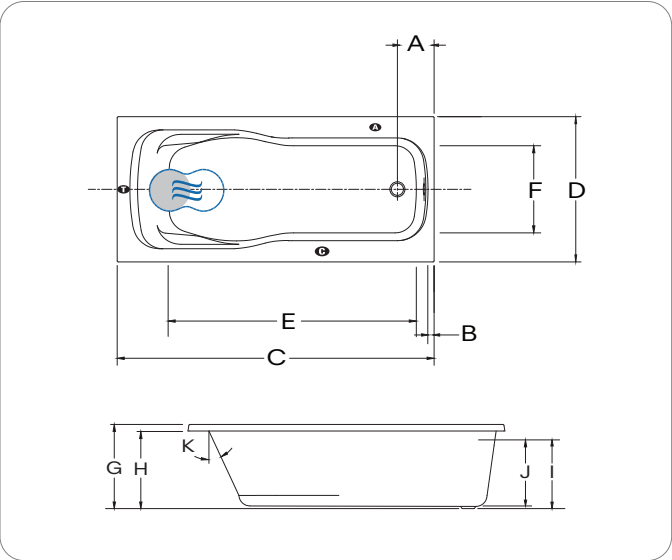

Letter	Description	Measure
A	Outside edge to center drain	8"
B	Outside edge to overflow	2 ¼"
C	Total length	71 ¾"
D	Total width	33"
E	Bathing well length	56 ½"
F	Bathing well width at seat area	23 ¾"
G	Height from bottom of bath to top deck	19 ½"
H	Height from bottom of bath to bottom of deck	18"
I	Height from bottom of drain to center of overflow	15 ¾"
J	Maximum water level (Drain & overflow 16" x 35")	13 ⅞"
K	Slope of backrests	25°

- Ⓐ AromaCloud® position Ⓢ Control position when factory-installed (Mia® or DOT)
Ⓜ Turbine position (TMU) ● Indicates heated backrest (TMU)
Ⓢ Indicates WarmTouchShell® position (Soaker)

Hot water supply required	The hot water supply should be 70% or more of the bath's total water capacity.
Turbine	Access to the pump must be at least 18" x 22". Standard connection is 20 A. 120 V, 60 Hz, dedicated line with a ground-fault circuit interrupter (GFCI). For any additional option, a second line is needed 15 A. 120 V, 60Hz, dedicated line with a GFCI. Air vent necessary: 2" x 4" minimum.
Others	The Geysair® is located on the same side as the heated backrest. It must not be relocated. It must be connected to the hot water supply and be accessible (provide access).
Optional Tile Flange (specify right or left).	

Our products must be installed by certified professionals only and according to our Owner's Manual as well as federal, provincial/state and local building codes and regulations (www.bainultra.com/dealers/dealer-documentation-and-catalog).

Approx. shipping weight	133 lb
Turbine power	550 W
Air heater	600 W

Warranty

Controls-LED-Geysair*	5 years
Bath & turbine*	20 years

* Some restrictions apply | www.bainultra.com/warranty

Dimensions are subject to change; measured at external edges. Bathing well measured at air jet level. Tolerance: ±0.25" (±0.64 cm). Ensure bathtub is received prior to any construction. BainUltra® is not responsible for any preparatory work done before product arrival.