

thalassa2 6031

60" x 31" x 20"



Product No.

Model Drop-in	TMU BTHCRB00T-XX	Soaker BTHCRB00N-XX
Model Alcove, Right	TMU BTHCRB0RT-XX	Soaker BTHCRB0RN-XX
Model Alcove, Left	TMU BTHCRB0LT-XX	Soaker BTHCRB0LN-XX

ThermoMasseur (TMU)

Air Jet System	\$4,795
Jets	36
1 heated backrest	Included
Mia® Control*	Included
BU-Touch Control Application BUTOUCH	\$495
Geysair®	Included
AromaCloud®** BAROMAC	\$590
Illuzio Chromatherapy BCHRO6	\$995

Soaker

AromaCloud®** BAROMAC	\$590
Illuzio Chromatherapy BCHRO6	\$995
WarmTouchShell® BWTS	\$1,125
DOT Control	Included with therapy

Features

Installation Type	Alcove (3 walls)
No. of bathers ♀	Imp. gallons 34 US gallons 41 Armrests 2
Integrated tile flange	Included
Standard Bath Color p.17	
White 01	Included

Options UPCHARGE APPLICABLE

Control (TMU only) p.13		
MiaPlus®# BMIAPI-XX	\$285	
Grab Bars p.16	\$125	
Skirt p.254	Multifit BSMUL-XX	SJ-1 BSJI-XX
White 01	\$695	\$715
Bath Pillow BPILLOW p.252	\$240	
Drain & Overflow p.14	Integrated ZenFlow† BOVERINF-XX	16" x 35" BOVER16-XX
Chrome 07	\$205	\$260
White 01	\$165	\$290
Brushed Nickel 09	\$205	\$290
Polished Nickel 10	\$205	\$290
Oil-rubbed Bronze 11	N/A	\$400
Matte Black 19	\$260	N/A
Satin Brass 18		
If Required by Construction Code		
Brass drain & overflow kit BDRCOB	\$240	
Brass drain kit BDRCB	\$60	
16" x 35" Cable driven brass drain & overflow kit BOVERBR	\$240	

† ZenFlow: Integrated overflow without a trim.
** The AromaCloud® is built into the deck (factory installed).
The MiaPlus® Control is Included when purchasing Chromatherapy on a TMU.

thalassa2 6031

60" x 31" x 20"



Technical Specifications

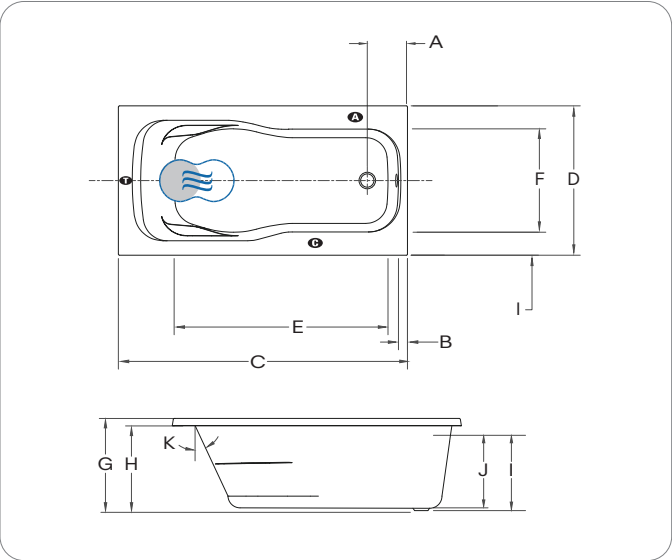

Letter	Description	Measure
A	Outside edge to center drain	8 3/8"
B	Outside edge to overflow	2 3/8"
C	Total length	60"
D	Total width	31"
E	Bathing well length	44 1/2"
F	Bathing well width at seat area	21 1/4"
G	Height from bottom of bath to top deck	19 1/2"
H	Height from bottom of bath to bottom of deck	18"
I	Height from bottom of drain to center of overflow	15 3/4"
J	Maximum water level (Drain & overflow 16" x 35")	13 3/4"
K	Slope of backrests	25°

A AromaCloud® position **B** Control position when factory-installed (Mia® or DOT)
C Turbine position (TMU) **D** Indicates heated backrest (TMU)
E Indicates WarmTouchShell® position (Soaker)

Hot water supply required	The hot water supply should be 70% or more of the bath's total water capacity.
Turbine	Access to the pump must be at least 18" x 22". Standard connection is 20 A. 120 V, 60 Hz, dedicated line with a Ground-Fault Circuit Interrupter (GFCI). For any additional option, a second line is needed 15 A. 120 V, 60 Hz, dedicated line with a GFCI. Air vent necessary: 2" x 4" minimum.
Others	The Geysair® is located on the same side as the heated backrest. It must not be relocated. It must be connected to the hot water supply and be accessible (provide access). There is a height difference for the integrated tile flange (see drawing Detail A). Available with or without integrated Tile Flange (specify right or left) at the same price.

Our products must be installed by certified professionals only and according to our Owner's Manual as well as federal, provincial/state and local building codes and regulations (www.bainultra.com/dealers/dealer-documentation-and-catalog).

Approx. shipping weight	104 lb
Turbine power	550 W
Air heater	600 W

Warranty

Controls-LED-Geysair*	5 years
Bath & turbine*	20 years

* Some restrictions apply | www.bainultra.com/warranty

Dimensions are subject to change; measured at external edges. Bathing well measured at air jet level. Tolerance: ±0.25" (±0.64 cm). Ensure bathtub is received prior to any construction. BainUltra® is not responsible for any preparatory work done before product arrival.