



Sink Specifications

Color	SKU
satin polish	443301

Design and Planning Tips

- Min cabinet size: 42 in (1067 mm)
- Rim height: 1.2 mm

What is included:

Includes bridge cutting board, accessories holder and large colander

Installation on a wooden frame, no clips required.
IMPORTANT: Specific cutout dimensions are required for proper accessories usage. Please refer to the installation instructions. Reversible sink.

Included Accessories

INTEOS Cutting Board	443336
INTEOS Accessory Frame	443337
INTEOS Large Colander	443338

Optional Accessories

INTEOS Grid 39	443346
INTEOS Large Tray	443339
INTEOS Dish Rack	443342
INTEOS Small Colander	443340
INTEOS Small Tray	443341
INTEOS Organizer XL 40	527670
Storage Caddy 40	527668
Storage Caddy 20	527667

INTEOS 39

Stainless steel satin polish

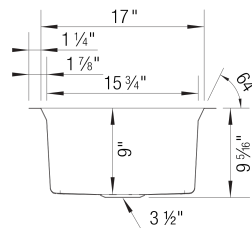
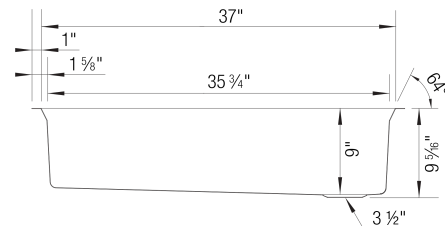
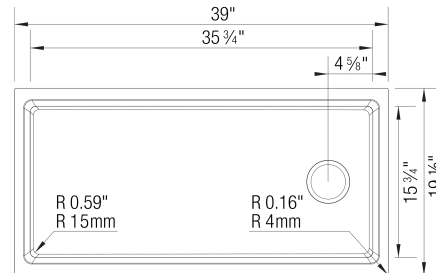

Warranty

BLANCO offers a limited lifetime warranty on all sinks and faucets, as well as a one-year warranty on all custom accessories.

Code/Standards Compliance

BLANCO sinks and faucets are third-party tested and certified to standards and listed by applicable certification bodies. For more information on individual product listings, contact our office or listing organization.



View our how-to videos to learn more about installing and caring for BLANCO products:

<https://www.blanco.com/us-en/service/how-to-videos/how-to-videos-for-sinks/>

Questions? Contact us today



BLANCO America, Inc.
110 Mount Holly By-Pass
Lumberton, NJ 08048

Phone & Fax
Phone: 888-668-6201
Fax: 609-668-6211

While BLANCO endeavors to provide accurate information, all dimensions are nominal, cannot be guaranteed, and are subject to change or cancellation. BLANCO assumes no responsibility for use of superseded or voided specifications.