

## For Residential and Commercial Applications

|                |  |                      |  |
|----------------|--|----------------------|--|
| Job Name       |  | Engineer / Architect |  |
| Job Location   |  | Wholesaler           |  |
| Submittal Date |  | Contractor           |  |

**PLB203/212X 1/4 Turn Straight Ball Stop - Sweat x Compression**

**Use:** For use only in potable water distribution systems, hot and cold, in accessible locations only

**Part Listing:**

- ☐ PLB203X B 1/2" nom sweat x 3/8" OD compression, chrome plated, bulk
- ☐ PLB203X P 1/2" nom sweat x 3/8" OD compression, chrome plated, bagged
- ☐ PLB212X P 1/2" nom sweat w/extension tube x 3/8" OD compression w/bell escutcheon, chrome plated, bagged



| Operating Specifications |                 |
|--------------------------|-----------------|
| Temperature              | Pressure        |
| Intermittent 40°- 140° F | 125 PSI maximum |

| MATERIAL SPECIFICATIONS |                 |
|-------------------------|-----------------|
| Body                    | Brass, plated   |
| Stem                    | Brass           |
| Ball                    | Brass, plated   |
| Seats                   | PTFE            |
| O-ring                  | Rubber          |
| Handle                  | Zinc, plated    |
| Handle Screw            | Stainless steel |
| Compression Nut         | Brass, plated   |
| Compression Sleeve      | Brass           |
| Adaptor                 | Brass, plated   |

This specification and all information contained herein is the confidential and exclusive property of Brasscraft Manufacturing Company, and shall not be disclosed to others without the written consent of Brasscraft Mfg. Co. This specification must be returned to Brasscraft Mfg. Co. if requested.

400.289 PLB203X 1/4 Turn Straight Ball Stop - Sweat x Comp REV 9.19

**PLUMBSHOP®**

©2018 Brasscraft Manufacturing Company

# PLB203/212X 1/4 Turn Straight Ball Stop - Sweat x Compression

| PART DIMENSIONS (Inches) |        |        |        |        |        |
|--------------------------|--------|--------|--------|--------|--------|
| Model                    | DIM. A | DIM. B | DIM. C | DIM. D | DIM. E |
| PLB203X                  | 1.77   | 1.12   | 1.50   | 2.07   | .94    |
| PLB212X                  | 1.77   | 1.50   | 2.40   | N/A    | .94    |

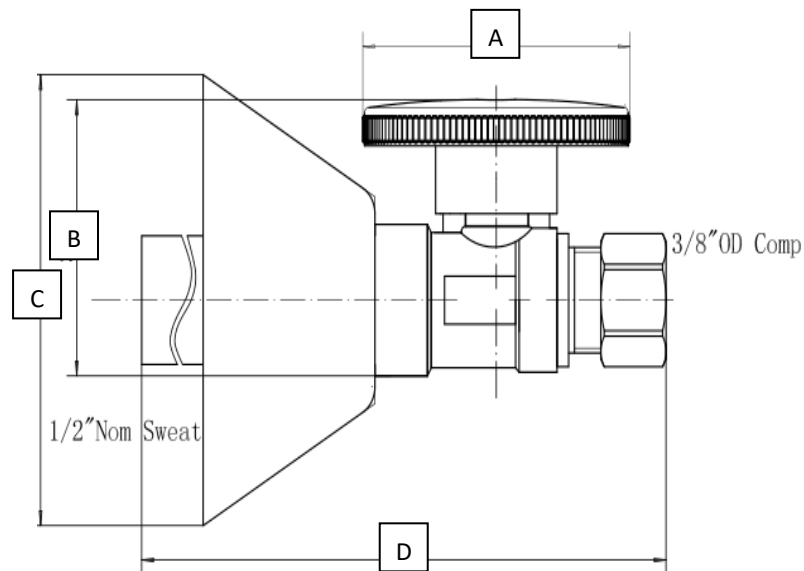
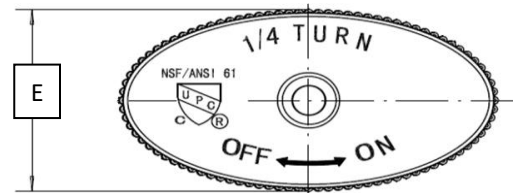
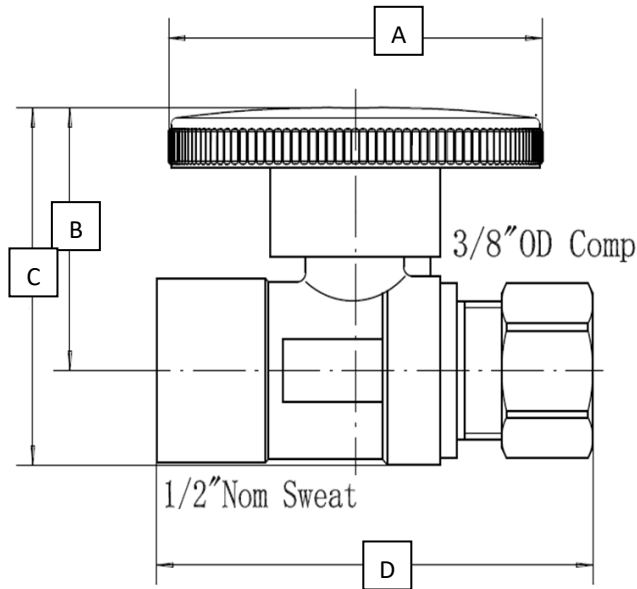

## Listings & Certifications:

- IAPMO listed to ASME A112.18.1 / CSA B125.1 (includes NSF/ANSI 372 and NSF61)



This specification and all information contained herein is the confidential and exclusive property of Brasscraft Manufacturing Company, and shall not be disclosed to others without the written consent of Brasscraft Mfg. Co. This specification must be returned to Brasscraft Mfg. Co. if requested.

400.289 PLB203X 1/4 Turn Straight Ball Stop - Sweat x Comp REV 9.19

**PLUMBSHOP®**

©2018 Brasscraft Manufacturing Company