

*For Residential and Commercial Applications*

Job Name		Engineer / Architect	
Job Location		Wholesaler	
Submittal Date		Contractor	

## P14C CPVC Solvent Weld x Compression Adapter

**Use:** For use in potable water distribution systems to convert CPVC piping to plastic, copper, or aluminum tubing. Not intended for use with steel tubing

\* Plastic tubing requires a plastic insert and a sleeve (see 60PT & 63PT)

**Design Features:**

- **Pre-torqued** to eliminate need for tightening on the job
- **Clean, uniform threads** insure positive threaded connections and reduces potential for cross-threading

**Operating Specifications:**

**Temperature:** 40° - 180°F

**Pressure:** 125 PSI maximum

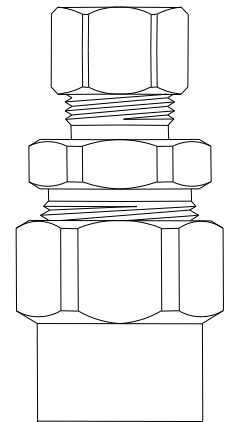

MATERIAL SPECIFICATIONS	
Fitting Body	Brass
CPVC Insert	CPVC
CPVC Washer	Rubber
CPVC Nut	Brass
Compression Sleeve	Brass
Compression Nut	Brass

PART DIMENSIONS (Inches)		
Model	DIM. A	HEX. B
P14C	2.02	15/16

**Part Listing:**

- P14C C 1/2" nominal CPVC x 3/8" OD compression, chrome plated
- P14C CB 1/2" nominal CPVC x 3/8" OD compression, chrome plated, bulk
- P14C R 1/2" nominal CPVC x 3/8" OD compression, rough finish

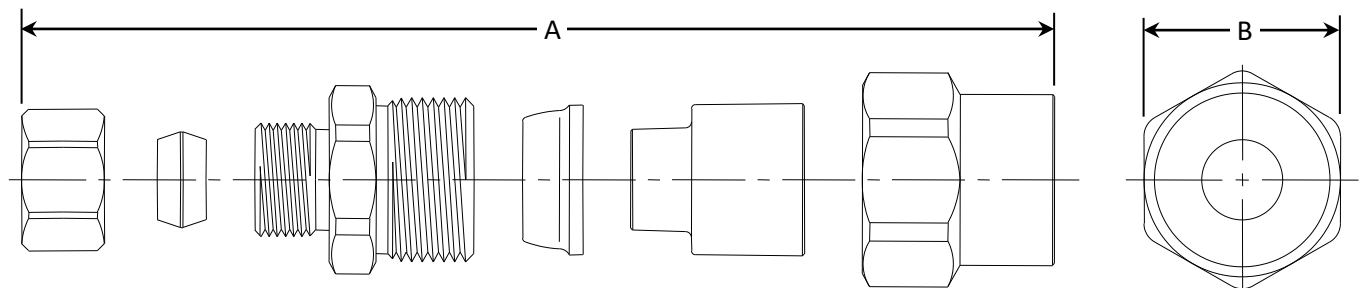

*This specification and all information contained herein is the confidential and exclusive property of Brasscraft Manufacturing Company, and shall not be disclosed to others without the written consent of Brasscraft Mfg. Co. This specification must be returned to Brasscraft Mfg. Co. if requested.*

**BrassCraft®**