

or Residential and Commercial Applications

Job Name		Engineer / Architect	
Job Location		Wholesaler	
Submittal Date		Contractor	

DRS83 Integral Shut-Off Straight Stop w/ Screwdriver Slot – Female Iron Pipe x Male Iron Pipe

Use: For use in potable water distribution systems. Not intended for recirculating water systems that produce continuous use temperatures above 115° F. For those applications, use BrassCraft KT series ball stops

Design Features:

- **Machined one-piece brass body** provides strength, durability and long-lasting performance
- **Screwdriver slot handle** helps protect against accidental stop operation during rough-ins and in general use

Operating Specifications:

Temperature: 40°- 140° F
Pressure: 125 psi maximum

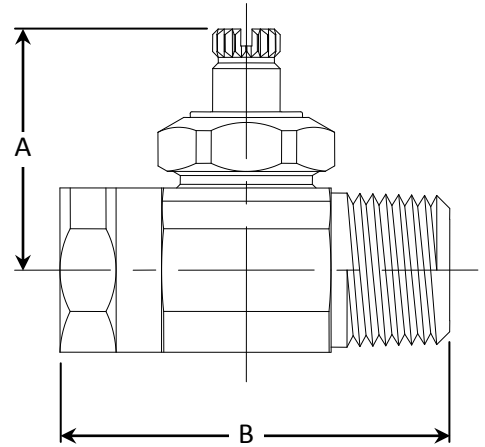

MATERIAL SPECIFICATIONS	
Valve Body	C36000 brass
Screwdriver Slot Stem	C36000 brass
Bib & Packing Washers	Nitrile or EPDM rubber
Packing Nut	C36000 brass

PART DIMENSIONS (Inches)		
Model	DIM. A	DIM. B
DRS83	1.33	2.10

Part Listing:

- DRS83 C 1/2" F.I.P. x 1/2" M.I.P. with screwdriver slot, chrome plated
- DRS83 R 1/2" F.I.P. x 1/2" M.I.P. with screwdriver slot, rough brass
- DRS83 RBT 1/2" F.I.P. x 1/2" M.I.P. with screwdriver slot, rough brass, bulk, plain tray
- DRS83 R1 1/2" F.I.P. x 1/2" M.I.P. with screwdriver slot, rough brass, window tray

Listings & Certifications:

- IAPMO listed to ASME A112.18.1-05 / CSA B125.1-05 (File # 0645)
- CSA listed to ASME A112.18.1-05 / CSA B125.1-05 (File # 204593)



This specification and all information contained herein is the confidential and exclusive property of BrassCraft Manufacturing, and shall not be disclosed to others without the written consent of BrassCraft. This specification must be returned to BrassCraft if requested.

